

Roper Pumps

**2835**

**Series**

When the going gets thick, this pump gets going, count on it every time

# Tough Enough



The leading force behind liquids.

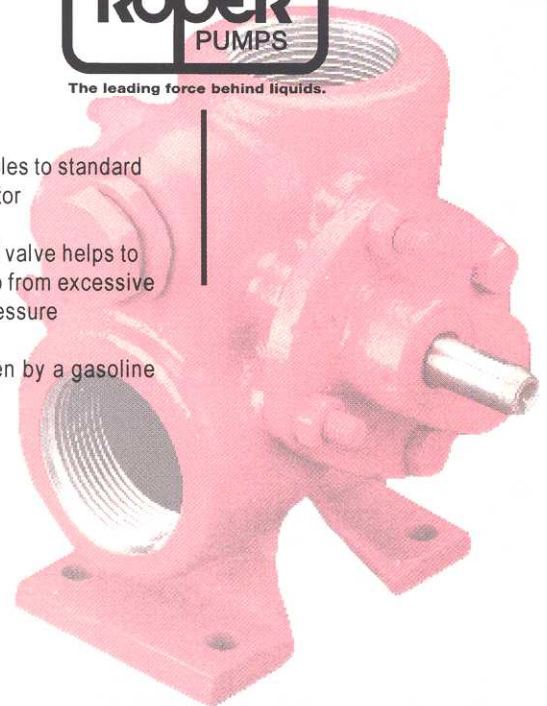

## Applications

- Designed for pumping viscous liquids
- Operates at standard motor speeds for viscosities up to 100,000 SSU
- Materials include: roofing compound, molasses, and feed supplements

## Features

- Angled gear arrangement
- Enlarged ports facilitate pumping
- Low horsepower requirements allow use of low cost drivers
- Pressures up to 75 psi
- Capacities up to 11.3 GPM

## Options

- Directly couples to standard electrical motor
- Built-in relief valve helps to protect pump from excessive discharge pressure
- May be driven by a gasoline engine

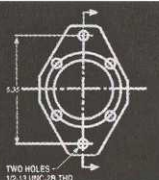
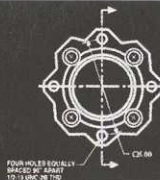
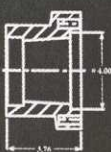

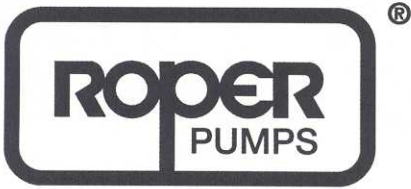

Roper Pump Company  
 P.O. Box 269 • Commerce, GA 30529  
 Toll Free: 1-800-876-9160 • Fax: 706-335-5490  
 sales@roperpumps.com

Visit Us On The WorldWide Web  
[www.roperpumps.com](http://www.roperpumps.com)

## 2835 Series

Pump Model	Theoretical Capacity	Maximum Speed	Maximum Flow at Maximum Speed (0 Discharge Pressure)	Maximum Pressure	Port Connection
2835	0.0063GPR(23.8 CC/REV)	1800RPM	11.3 GPM (2.57 M /HR)	75 PSI (5.2 Bar)	1-1/2" NPT

## Materials of Construction

	Housing	Gears	Bearings	Shaft	Seal
	Cast Iron	Hardened Steel	Iron	Hardened Steel	TFE Packing
Options					Viton® Lip Seal Buna, Type 21 Mech. Seal

## Key Features

Viton® is a registered trademark of the E.I. DuPont Co.

- Bearings are lubricated by the liquid being pumped
- Enlarged ports facilitate pumping
- Low horsepower requirements allow use of low cost drivers
- Installation flexibility by eliminating the need for risers in direct-coupled applications
- Sealing flexibility: mechanical seal lip seal, or packing is available
- Reliable external gear design
- Quiet running helical gears

