

Roper Pumps

SP

Sanitary
Truck Pump

The latest high quality performer that is ready to meet your 3A transfer needs

Sanitary Goes Mobile



The leading force behind liquids.

Applications

- Handles high or low viscosity products
- Tanker loading and unloading
- Up to 100,000 CPS
- Suitable for food, chemical, pharmaceutical grade, and cosmetic products
- Designed for continuous operation

Features

- 3A approved & FDA compliant
- Quick strip and easy clean in place
- Front serviceable seals
- "Lubed for life" gear box
- Bi-Rotational
- Uniform meshing clearance using optimized rotor profile
- Low shearing action

Options

- PTO or close coupled hydraulic drive
- Variety of elastomers
- Variety of front loaded seals

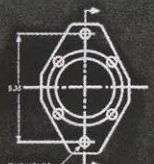
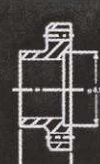
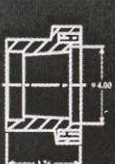

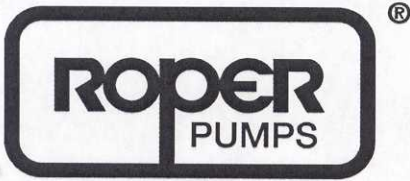

Roper Pump Company
 P.O. Box 269 • Commerce, GA 30529
 Toll Free: 1-800-876-9160
 Tele: 706-335-5551 • Fax: 706-335-5490
 sales@roperpumps.com
 Visit Us On The WorldWide Web
 www.roperpumps.com

SP Series

Pump Model	Theoretical Capacity	Maximum Speed	Maximum Flow at Maximum Speed (0 Discharge Pressure)	Maximum Pressure	Port Connection	Weight
------------	----------------------	---------------	--	------------------	-----------------	--------

SP 43 Gallons/100Rev 700 RPM 255 GPM 120 PSI/8.3 Bar 3" 156 lbs. (approx.)

Sanitary Pump Coding

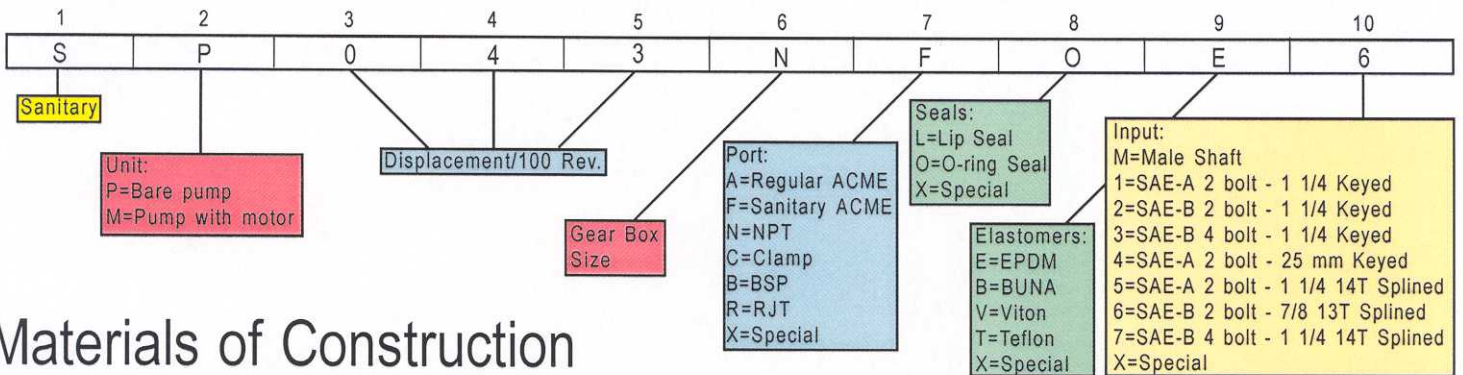

Materials of Construction

Rotors, Faceplate, & Housing	Timing Gear Housing	Shaft Sleeve	Seals	Elastomer
316 Stainless Steel	Cast Aluminum	FDA Compliant Ceramic Coated	FDA Compliant 3A Approved	FDA Buna FDA Viton® FDA EPDM FDA TFE/Viton®

Viton® is a registered trademark of the E.I. DuPont Co.

Key Features

- Pump standard with 3" Sanitary Acme thread
- Product temperatures up to 210°F
- Ceramic coated shaft sleeves
- Light weight

