

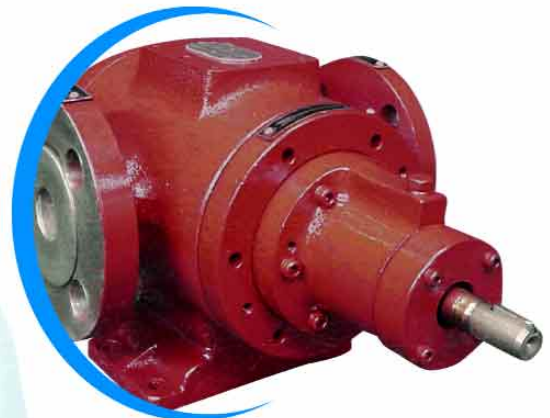

The Total Pumping Solution



EXTERNAL
GEAR



TRIPLE
SCREW



ROTARY
LOBE



PROGRESSING
CAVITY

THE PROVEN LEADER IN POSITIVE DISPLACEMENT PUMPS

EXTERNAL GEAR



"A"

Designed for pumping liquids at standard motor speeds at pressures to 300 PSI

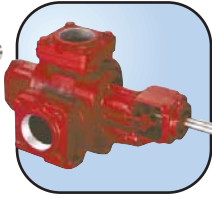

3600

General purpose pumps for a variety of uses



3700 Type Z3

Easy maintenance and seal flexibility with two-piece backplate design, an extension of the 3600 series

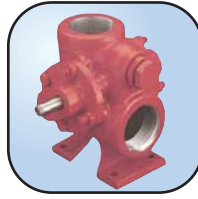

2835

High viscosity pump



ROC®

Stainless steel pump with Mag Drive on small sizes

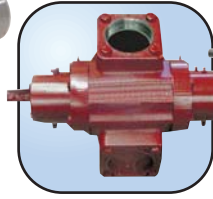

3800

External bearing pump based on 3600 series

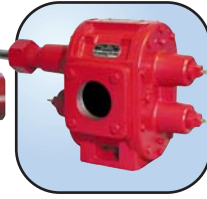

5600

Trash pump

Features

No. of Sizes

Theoretical Max Capacity

Differential Pressure

Viscosity

Max Temperature

Port Sizes

Housing Materials of Construction

Typical Applications

No. of Sizes	12	8	7	1	8	4	1
Theoretical Max Capacity	75.6 GPM 17.2 M3/hr	360 GPM 81.8 M3/hr	360 GPM 81.8 M3/hr	11.3 GPM 2.57 M3/hr	32.4 GPM 7.36 M3/hr	540 GPM 122.6 M3/hr	232 GPM 52.7 M3/hr
Differential Pressure	150/300 PSI* 20/10 Bar*	125 PSI 8.6 Bar	125 PSI 8.6 Bar	75 PSI 5.2 Bar	300 PSI 20 Bar	125 PSI 8.6 Bar	100 PSI 7 Bar
Viscosity	Up to 2,200 cSt Up to 10,000 SSU	Up to 55,000 cSt Up to 250,000 SSU	Up to 55,000 cSt Up to 250,000 SSU	Up to 22,000 cSt Up to 100,000 SSU	Up to 55,000 cSt Up to 250,000 SSU	Up to 55,000 cSt Up to 250,000 SSU	Up to 2,200 cSt Up to 10,000 SSU
Max Temperature	500° F * 260° C *	212°/450° F * 100°/282° C *	212°/450° F * 100°/282° C *	350° F * 176° C *	350° F 176° C	350° F * 176° C *	130° F 72° C
Port Sizes	3/8" - 2" NPT	2" - 3" NPT 2" - 4" Flg	2" - 3" NPT 2" - 4" Flg	1 1/2" NPT	1/2" - 2" NPT	3" & 4" Flg	3" Flg
Housing Materials of Construction	Ductile Iron, Cast Iron	Cast Iron	Cast Iron	Cast Iron	316/17-4 Stainless Steel	Cast Iron with sealed ball bearings	Cast Iron, NITRILE covered rotors
Typical Applications	Lube, Hydraulic	General service	Asphalt, Heat transfer, Ink, Oil refining	Molasses, fish processing	Chemical dosing	Chemical recycling Oil field	Solids and Abrasives

PERFORMANCE PRODUCTS

PROGRESSING CAVITY

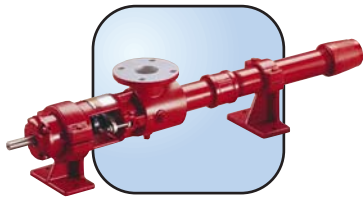

PC

Pulseless, low shear, solids handling

TRIPLE SCREW

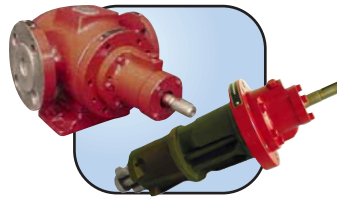

"D"

Cartridge-type pumps for pulseless, low shear and high viscosity applications

ROTARY LOBE

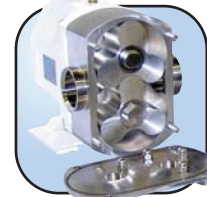

SP

Stainless Steel, Shear Sensitive, High Viscosity

CUSTOM DESIGNS

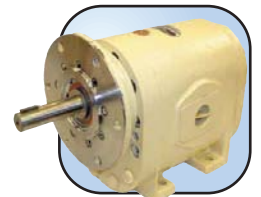

Engineered for unique applications

Features

No. of Sizes

Theoretical Max Capacity

Differential Pressure

Viscosity

Max Temperature

Port Sizes

Housing Materials of Construction

Typical Applications

No. of Sizes	15	34	1	30+
Theoretical Max Capacity	1000 GPM 227 M3/hr	1453 GPM 330 M3/hr	255 GPM 57.9 M3/hr	1200 GPM 272.5 M3/hr
Differential Pressure	750 PSI 51.7 Bar	928 PSI 64 Bar	120 PSI 8.3 Bar	1500 PSI 103 Bar
Viscosity	Up to 10 million CPS Up to 50 million SSU approx.	Up to 100,000 cSt Up to 500,000 SSU	Up to 100,000 cSt Up to 500,000 SSU	Up to 100,000 cSt Up to 455,000 SSU
Max Temperature	350° F 176° C	500° F 260° C	210° F 99° C	500° F 260° C
Port Sizes	1" - 10" Flg plus hopper 3/4" NPT	1" - 10" Flg	3"	Various
Housing Materials of Construction	Stainless Steel, Cast Iron, Stator: Buna, Viton, EPDM, N Rubber	Cast Iron, Steel, Stainless Steel	316 Stainless Steel	Various
Typical Applications	Slurries, metering polymers and other shear sensitive liquids	Fuel oil, lube oil, hydraulics	Liquid food	Various

*with modifications

EXTERNAL GEAR



Special Series

Special bushings, special packing, undersized gears



"F"

High pressure oil pump with 8 optional piping arrangements

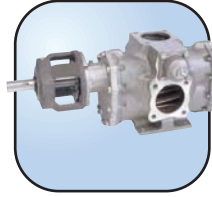

9622

Stainless steel high capacity pump, corrosion resistant



"V"

Mag drive sealless with low flow

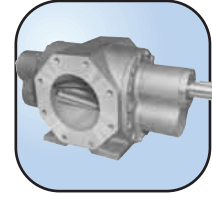

Bulk Handling

High capacity pump

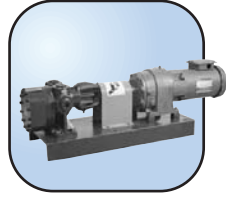

2001 Type 10

High pressure pump

Features

No. of Sizes	8	13	1	4	2	1
Theoretical Max Capacity	360 GPM 81.8 M3/hr	403.2 GPM 91.6 M3/hr	165 GPM 37.5 M3/hr	5.4 GPM 1.2 M3/hr	1045 GPM 237 M3/hr	2 GPM 0.5 M3/hr
Differential Pressure	125 PSI 8.6 Bar	425 PSI * 29 Bar *	100 PSI 7 Bar	150 PSI 10 Bar	125 PSI 8.6 Bar	1200 PSI 82.75 Bar
Viscosity	Up to 55,000 cSt Up to 250,000 SSU	Up to 22,000 cSt Up to 100,000 SSU	Up to 55,000 cSt Up to 250,000 SSU	Up to 2,200 cSt Up to 10,000 SSU	Up to 55,000 cSt Up to 250,000 SSU	Up to 110,000 cSt Up to 500,000 SSU
Max Temperature	450° F * 232° C *	250° F 121° C	350° F 176° C	225° F 107° C	350° F 176° C	350° F 176° C
Port Sizes	2" - 3" NPT 2" - 4" Flg	1/2" - 2 1/2" NPT 3" - 4" Flg	3" Flg	1/2" - 3/4" NPT	8" Flg	3/4" x 3/8" NPT
Housing Materials of Construction	Cast Iron	Cast Iron	316/17-4 PH Stainless Steel	Ductile Iron, Cast Iron	Ductile Iron, Cast Iron	Cast Iron
Typical Applications	Asphalt, Ink, Chocolate, Molasses	Hydraulics, Fuel Burners	Chemical transfer	Fuel additives	Unloading cargo	Can coating

INDUSTRY PUMP SELECTION

This is a general guide and may not be relevant to your specific industry. Review product selections and specific requirements with authorized Roper Pump representatives.

SERIES	AGRICULTURE	ASPHALT	CHEMICAL	FOOD & BEVERAGE	INK & PIGMENTS	MARINE	MINING	OIL & GAS	PERSONAL CARE	PHARMACEUTICALS	POWER GENERATION	PULP & PAPER	TRANSPORTATION	WASTEWATER
A	X			X			X			X				
Bulk Handling							X				X	X		
Custom Designs	X	X	X	X	X	X	X	X	X	X	X	X	X	X
D		X	X	X	X		X	X		X	X			
F							X			X				
PC	X		X	X		X	X	X			X			X
ROC®	X		X	X			X	X	X					
Rotary Lobe			X	X	X			X	X		X	X	X	
V							X							
2001 Type 10			X											
2835	X		X											
3600	X	X	X	X			X			X	X	X		
3700 Type Z3	X	X	X	X			X			X	X	X		
3800	X						X							
5658	X						X						X	X
9622	X		X						X			X		

HOUSING MATERIALS OF CONSTRUCTION

CAST IRON	DUCTILE	STEEL	STAINLESS	SERIES
ASTM A 48	ASTM A 395			A
ASTM A 48	ASTM A 395			Bulk Handling
*	*	*	*	Custom Designs
*		*	*	D
ASTM A 48				F
ASTM A 48			CF-8M	PC
			AISI 316	ROC®
			AISI 316/ASTM CF-8M	Rotary Lobe
ASTM A 48	ASTM A 395			V
ASTM A 48/CAST IRON				2001
ASTM A 48	ASTM A 395			2835
ASTM A 48				3600
ASTM A 48				3700 Type Z3
ASTM A 48				3800
ASTM A 48				5658
			CF-8M	9622

* Contact Factory for specific materials available

PRESSURE AND FLOW PUMP SELECTION

SERIES	MAX PRESSURE (PSI)	MAX FLOW (GPM)
Custom Designs	1500	1200
2001 Type 10	1200	2
D	928	1453
Progressing Cavity	750	1000
F	425	403
ROC®	300	32
A	300	75
V	150	5
Bulk Handling	125	1045
3800	125	540
3600	125	365
Rotary Lobe	120	255
5600	100	232
9622	100	165
2835	75	11

COMPANY PROFILE

Fitting Your Needs

Roper Pump Company is recognized globally for high quality positive displacement pumps designed to handle a broad range of industrial applications for the refining, chemical, petrochemical, pulp and paper, power generation, food processing, and liquid transportation industries. Roper Pump has been providing innovative standard and custom products and services specific to customer needs since 1857. Our large installed base and strong global distribution network has the ability and commitment to help you address the most challenging pumping problems. Our goal is to earn your trust by ensuring your needs are met and your problems solved on time every time.

The Roper Pump team of design, manufacturing, and application engineers work with you to provide the total pumping solution.

At Roper we are constantly evaluating new ideas and products to insure that we continue to solve the most difficult pump applications.



All information and recommendations appearing in this bulletin concerning the use of products described herein are based on tests believed to be reliable. However, it is the user's responsibility to determine the suitability for his own use of such products. Since the actual use by others is beyond our control, no guarantee, expressed or implied, is made by Roper Pump Company as to the effects of such use or results to be obtained. Roper Pump Company assumes no liability arising out of the use by others of such products. Nor is the information herein to be construed as absolutely complete, since additional information may be necessary or desirable when particular or exceptional conditions or circumstances exist or because of applicable laws or government regulations.

Roper Pumps is a registered trademark. ROC is a registered trademark of the Roper Pump Company.

IND05
Issue 02/05
©2005 Roper Pump Company



P. O. Box 269 / Commerce, GA 30529
Phone: 706-335-5551 / FAX: 706-335-5490
Toll Free: 1-800-876-9160
email: sales@roperpumps.com

Visit Us On The WorldWide Web
www.roperpumps.com