



# SERIES 'O' PLASTIC SUMP PUMP

## MODEL OL75V

PARTS LIST  
PP-8975A  
DEC. 1998

Refer to Bulletin PP-310, Operation and Service Guide PO-907  
and Master Price List PF-1075.

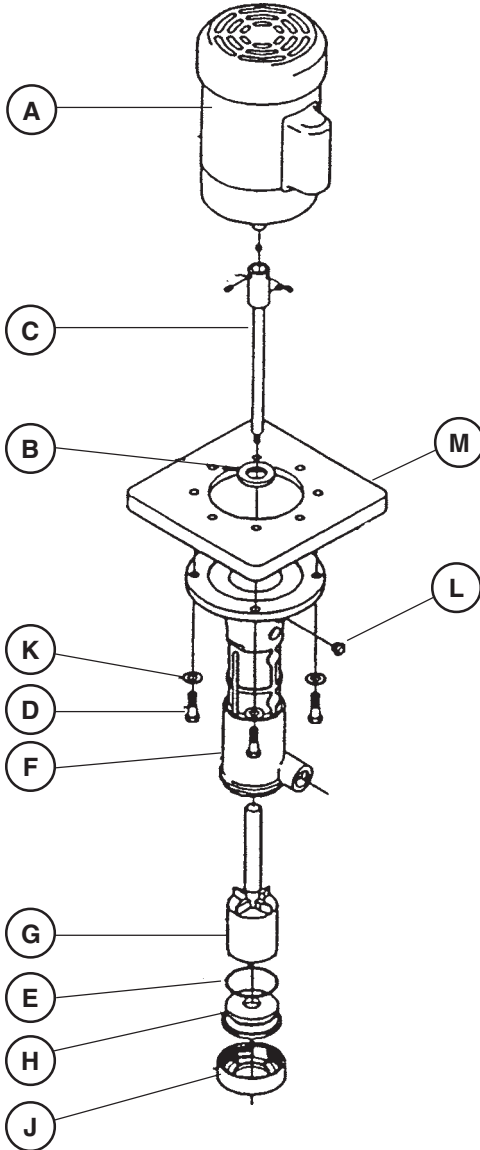

ITEM	DESCRIPTION	PART NUMBER	
		115-230V/1/60	230-460V/3/60
A	Motor-TEFC, 56C 1/3 HP 1/2 HP  For 110-220V/1/50 or 220-380-440V/3/50 motor, add -5 to Part Number	62-1219 62-1226	62-1689 62-1230
B	Fume barrier - Teflon	62-8121 TF	
C	Shaft w/ setscrews - stn. steel Includes: Setscrew HD (1 req'd) Setscrew cup (3 req'd)	62-8101 1 62-0566 62-0567	
D	Bolt 3/8"-16 x 1 1/2"-SS (4 req'd)	62-3148	
E	Suction "O"-ring - Viton (std.) - EPDM (opt)	62-8122 VN 62-8122 EP	
F <sup>1</sup>	Body, round flange	62-8282	
G <sup>1</sup>	Impeller (2.25" dia.)	62-8115	
H <sup>1</sup>	Suction cover	62-8100	
J <sup>1</sup>	Suction retainer	62-8102	
K	Washer, 3/8"- stn. steel (4 req'd)	62-3081	
L	Plug, weep hole (2 req'd)	62-8124	
M <sup>2</sup>	Mounting plate	62-8129	

<sup>1</sup> Add 'CP', 'PP', or 'PF' to part number to specify material.

<sup>2</sup> Add 'CP' or 'PP' to part number to specify material.

See Flow Chart on back page.

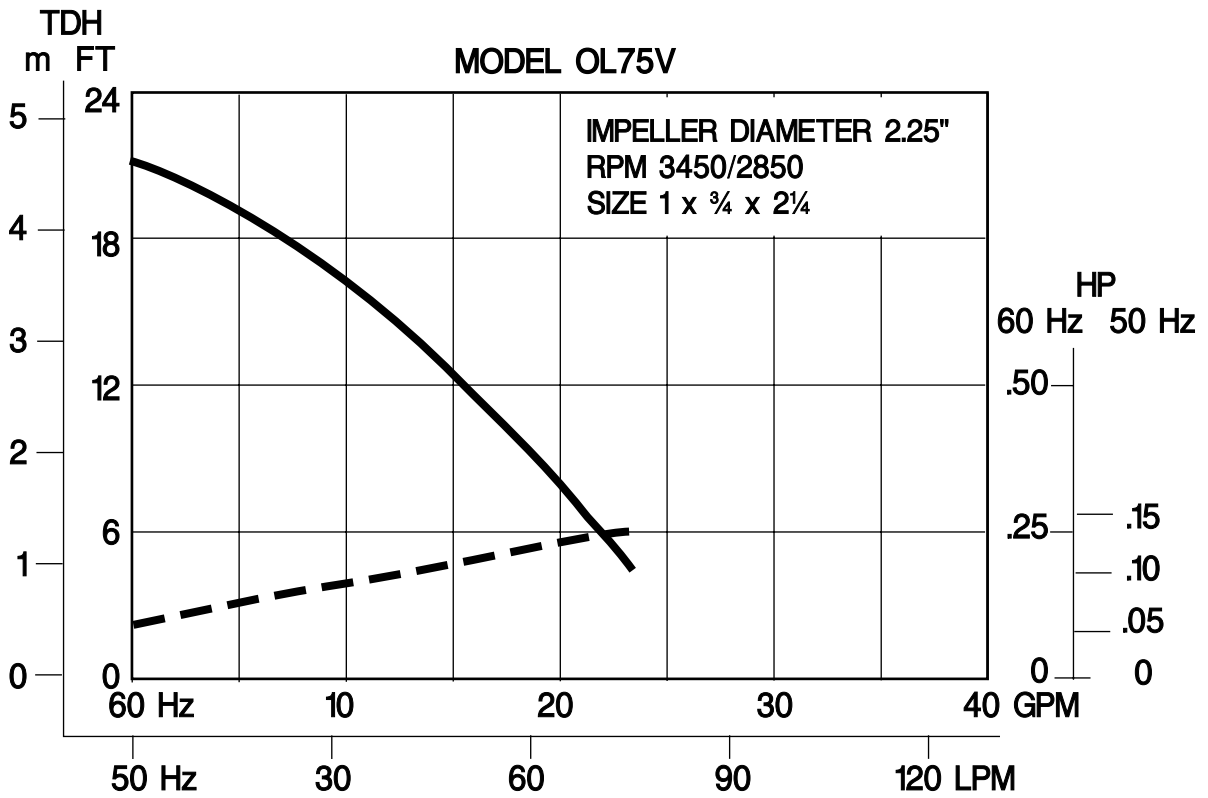

Terms: Net 30 days

Minimum order: \$25.00

# PACER® PUMPS

Division of ASM Industries, Inc.

41 Industrial Circle 717-656-2161  
Lancaster, PA 17601-5927 U.S.A. 800-233-3861  
Email: [pacer@success.net](mailto:pacer@success.net) FAX: 717-656-0477  
<http://www.industry.net/pacer.pumps>