

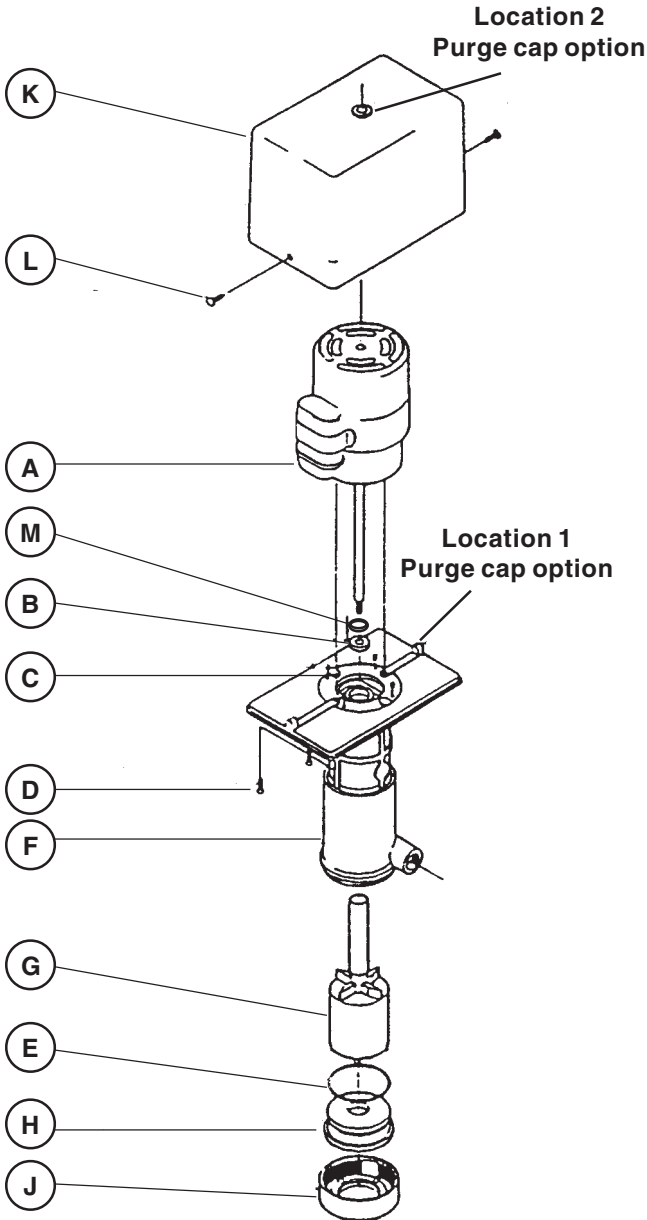

SERIES 'O' PLASTIC SUMP PUMP

MODEL OL50V

PARTS LIST
PP-8955
MAY 1997



Refer to Bulletin PP-310, Operation and Service Guide PO-904 and Master Price List PF-1075.

| ITEM | DESCRIPTION | PART NO. |
|------|---|--------------------------|
| A | Motor 0.2 HP 115-230V/1/50-60 | 62-1554 |
| B | Fume Barrier | 62-8120 TF |
| C | Leveling Screws (4 req'd) | 62-0577 |
| D | Mounting Screws (2 req'd) | 62-0578 |
| E | Suction "O"-ring - Viton (std.) - EPR (opt) | 62-8122 VN 62-8122 EP |
| F¹ | Body | 62-8110 |
| G¹ | Impeller (2.25" dia.) | 62-8106 |
| H¹ | Suction cover | 62-8100 |
| J¹ | Suction Retainer | 62-8102 |
| K² | Purge cap (square) (opt.) | 62-8112 PP |
| L | Purge cap fasteners (opt.) | 62-0565 NY |
| M³ | Shaft spacer | 62-8140 SS |

¹ Add 'PP', 'PF' or 'CP' to part number to specify material.

² Only available on polypropylene & PVDF.

³ Used only on CP Models.

See Flow Chart on back page.

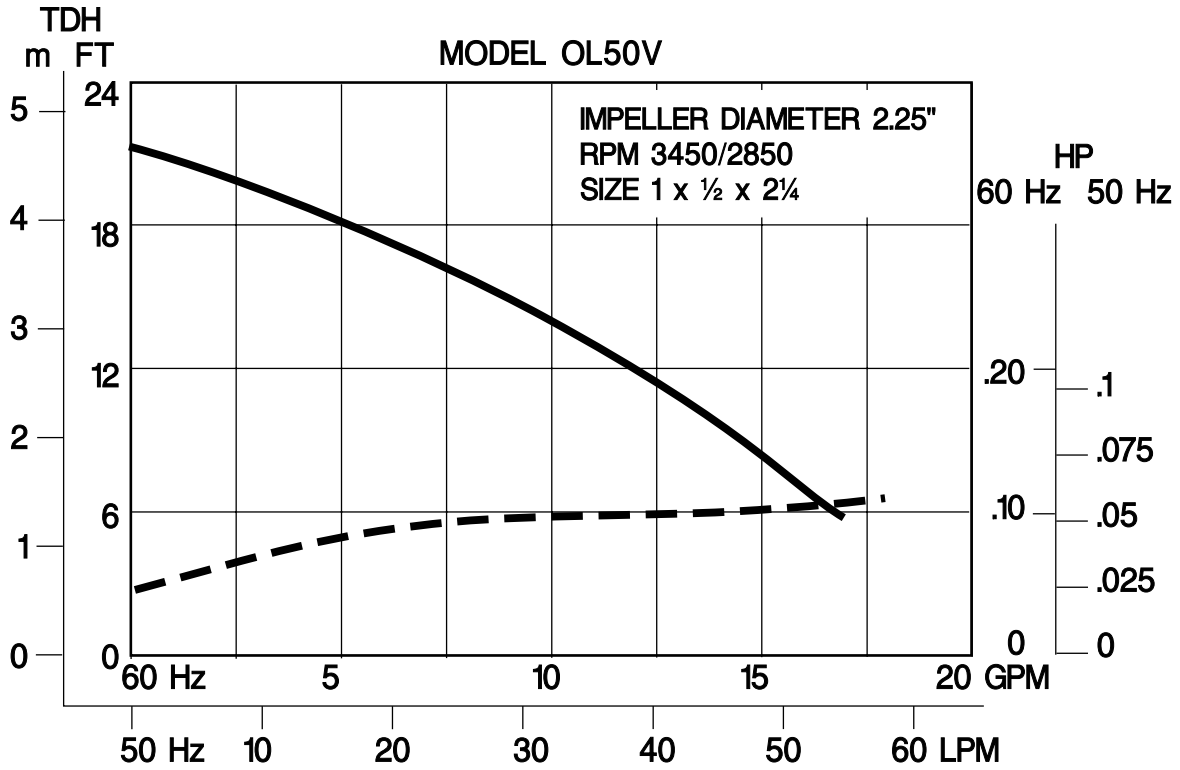

Terms: Net 30 days

Minimum order: \$25.00

PACER® PUMPS

Division of ASM Industries, Inc.

41 Industrial Circle 717-656-2161
Lancaster, PA 17601-5927 U.S.A. 800-233-3861
Email: pacer@success.net FAX: 717-656-0477

GENTRAL

1777 Shermer Road 847-559-1777
Northbrook, IL 60062 FAX: 847-559-1995