



LIQUID FERTILIZER PUMP

2" X 2" SELF-PRIMING CENTRIFUGAL PUMP

Fertilizer Ready!

Designed to handle the corrosive chemicals. Industrial duty Viton seal is compatible with most major herbicides and fertilizers.

EMAX self-priming centrifugal pumps are capable of creating vacuum sufficient to lift liquids from heights up to 25' above the source.

Standard features include SS drive sleeve, SS fasteners, renewable wearplate, and semi-open, dynamically balanced impeller. Options include double grease-lubricated seals, SS impeller and seals for all type of abrasive and/or corrosive services.

**FOR TRANSFER
and
SPRAYING of
PESTICIDES,
HERBICIDES,
FERTILIZERS,
and other
LIQUID CHEMICALS**

PUMP SPECIFICATIONS

Suction and Discharge . .	2" x 2"
Housing	Cast Iron
Impeller	Cast Iron
	stainless steel available
Shaft Sleeve	Stainless Steel
Fasteners	Stainless Steel
Seals	Standard Viton. Special seal material combinations available (consult factory).

AVAILABLE:

**5HP Gas Engine
Electric Motor
Bearing Pedestal
Hydraulic Motor
Drive**

MP PUMPS, INC.
TECUMSEH PRODUCTS COMPANY
34800 BENNETT DRIVE • FRASER, MI 48026-1686
(586) 293-8240 • FAX (586) 293-8469
(800 563-8006)
www.mppumps.com

LIQUID FERTILIZER PUMP 2" X 2"

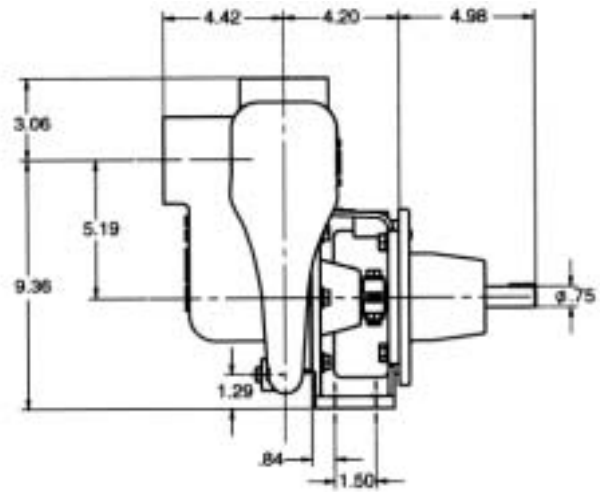

PUMPAK FOR ENGINE

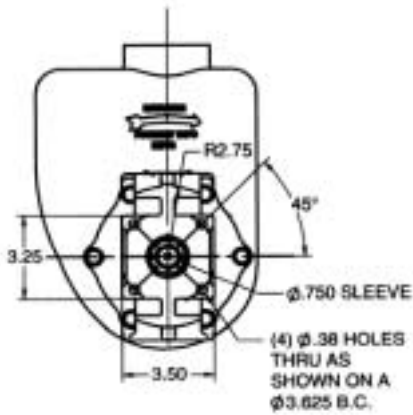

PUMPAK FOR ELECTRIC MOTOR

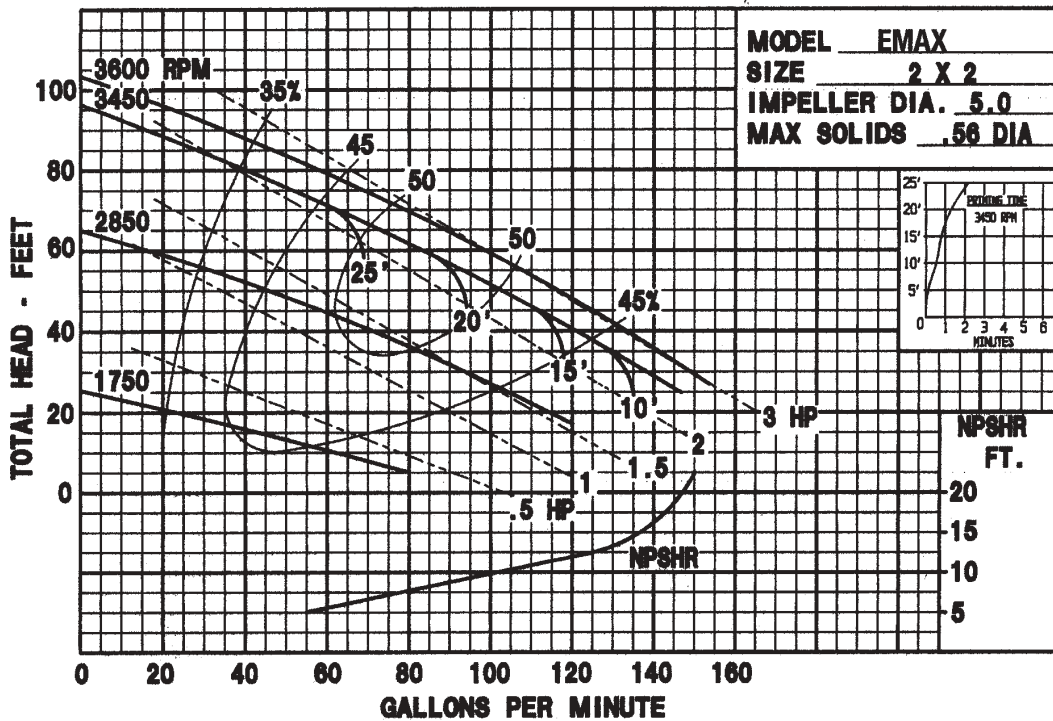
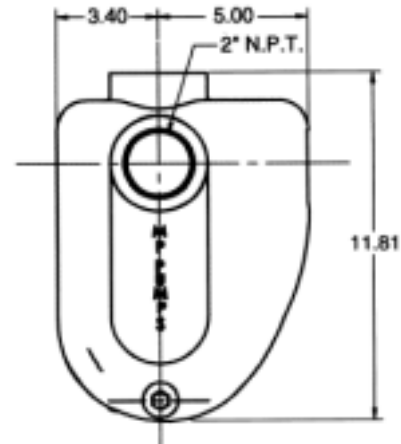
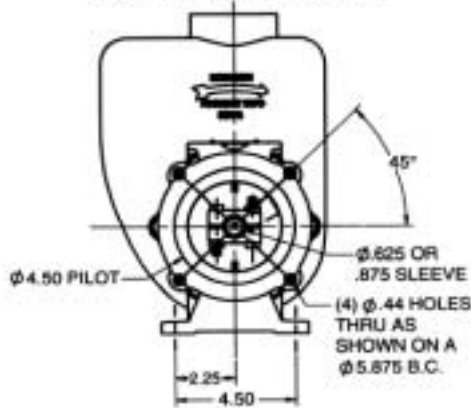

MP PUMPS, INC.
TECUMSEH PRODUCTS COMPANY
 34800 BENNETT DRIVE • FRASER, MI 48026-1686
 (586) 293-8240 • FAX (586) 293-8469
 (800) 563-8006
www.mppumps.com