

# ELECTRIC MOTOR DRIVEN SELF PRIMING

BSEF - TE

Water Systems

Sump and Sewage

Lawn and Sprinkler

Electric Motor Driven

Engine Driven

Frame Mount

Hand Pumps

Irrigation and Industrial



BSEF-500

## BSEF-TE ELECTRIC MOTOR DRIVEN

TOTALLY ENCLOSED FAN COOLED

These self priming cast iron pumps are designed to handle liquid fertilizer, such as concentrated

nitrogen phosphorous solutions. The viton and stainless steel seal will handle most agriculture and weed control chemicals. The BSEF pumps are also excellent for general dewatering purposes.

**CASING** - Made of rugged cast iron with a large chamber for rapid self priming.

**PRIMING PLUG** - Fits the standard garden hose for easy priming.

**MOTOR** - The BSEF pump comes with a reliable industry standard Totally Enclosed Fan Cooled (TEFC) motor.

**IMPELLER** - Semi-open, cast iron impeller, ideal for handling fertilizer, dirty water or other liquids. The impeller is blind hole tapped so liquid will not corrode the motor shaft.

**MECHANICAL SEAL** - Made of stainless steel with viton bellows. The BSEF-500 and BSEF-750 have a replaceable stainless steel sleeve for easy seal maintenance and protection of motor shaft.

### Dimensions

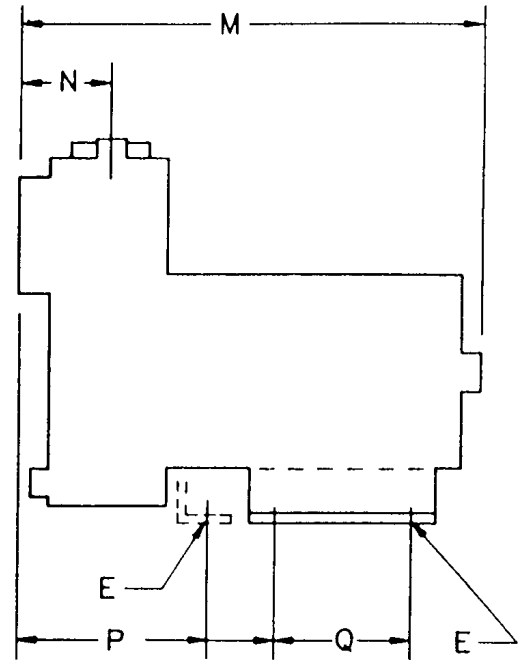
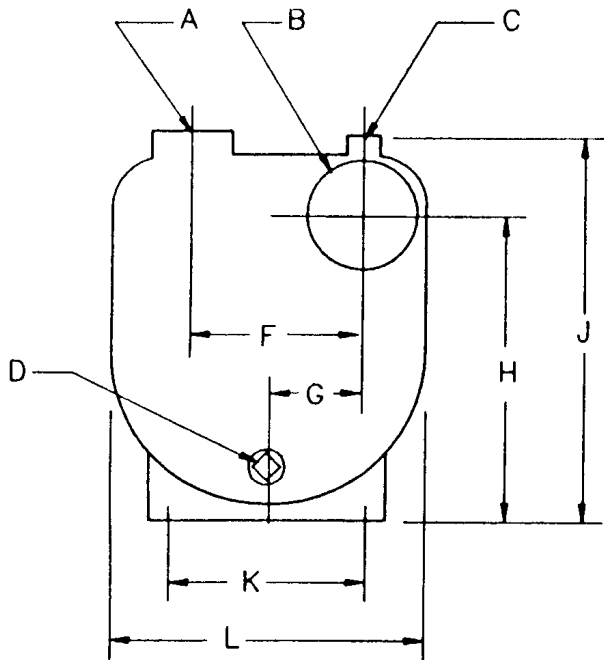

Model	Discharge A (NPT)	Suction B (NPT)	Priming Plug C (NPT)	Drain Holes D (NPT)	Mounting E	F	G	H	J	K	L	M	N	P	Q
BSEF-150TE	1/4	1/4	3/4	3/4	.44x.94	4.00	2.00	8.50	10.70	4.90	7.50	17.20	4.75	6.70	3.00
BSEF-200TE	2	2	3/4	3/4	.44x.94	4.25	2.13	9.50	11.00	4.90	8.50	17.60	5.13	7.00	3.00
BSEF-300TE	2	2	3/4	3/4	.35x1.22	4.25	2.13	8.60	11.10	4.25	8.50	15.90	3.20	5.93	-
BSEF-500TE	3	3	3/4	3/4	.40 DIA	3.62	2.00	10.30	14.00	7.50	9.30	24.10	4.60	14.00	5.50
BSEF-750TE	3	3	3/4	3/4	.40 DIA	3.62	2.00	10.30	14.00	7.50	9.30	24.10	4.60	14.00	5.50

\*Dimensions measured in inches

# ELECTRIC MOTOR DRIVEN SELF PRIMING

## Performance

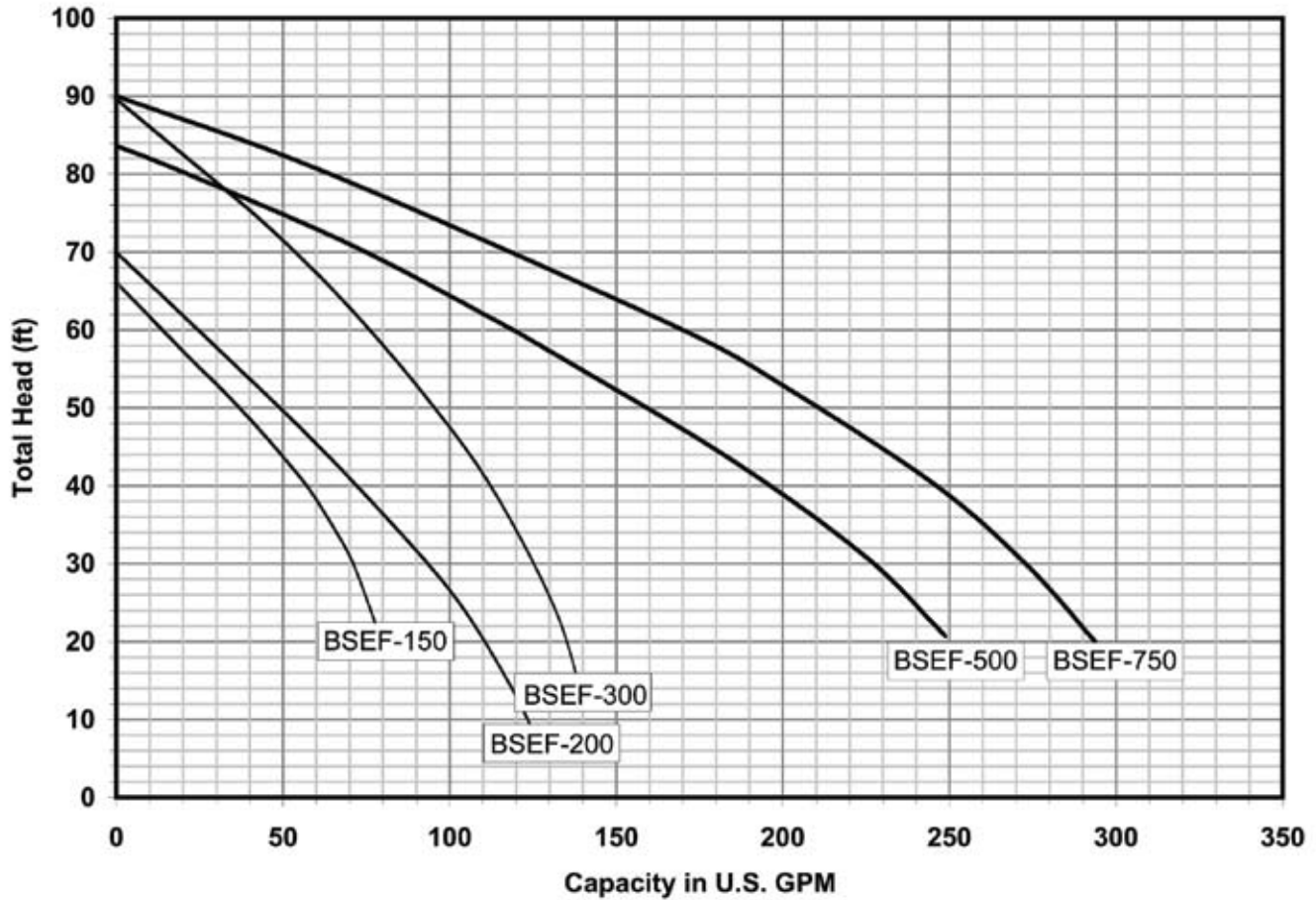

PERFORMANCE CHART										
Model No.	RPM	HP	Total Head in Feet							
			20	30	40	50	60	70	80	90
Capacities in U.S. GPM										
BSEF-150TE	3450	1½	74	70	62	35	10	-	-	-
BSEF-200TE		2	97	86	66	44	21	-	-	-
BSEF-300TE		3	138	130	120	100	79	55	25	-
BSEF-500TE		5	265	235	205	165	120	75	20	-
BSEF-750TE		7½	290	270	245	215	170	120	70	-

BSEF SERIES - LESS POWER KITS					
Model No.	Order No.	HP	Suct. NPT	Disch. NPT	Ship Wt. (lbs.)
BSEF-500LP	616888	5	3"	3"	50
BSEF-750LP	616868	7½	3"	3"	60

\*BSEF Pump end kits (Less Power) use 182/184JM motors.

BSEF SERIES - ELECTRIC MOTOR DRIVEN - LIQUID AG-CHEMICAL TRANSFER						
Model No.	Order No.	HP	Suct. NPT	Disch. NPT	Electrical Characteristics	Ship Wt. (lbs.)
BSEF-150TE	616894	1½	1¼"	1¼"	1/60/230V, TEFC motor	52
BSEF-200TE	616895	2	2"	2"	1/60/230V, TEFC motor	60
BSEF-300TE	616896	3	2"	2"	1/60/230V, TEFC motor	77
BSEF-300TE-3	616897	3	2"	2"	3/60/230/460V, TEFC motor	77
BSEF-500TE	616889	5	3"	3"	1/60/230, TEFC motor	148
BSEF-500TE-3	616899	5	3"	3"	3/60/230/460V, TEFC motor	148
BSEF-750TE-3	616898	7½	3"	3"	3/60/230/460V, TEFC motor	165

BSEF - TE

Water Systems

Sump and Sewage

Lawn and Sprinkler

Electric Motor Driven

Engine Driven

Frame Mount

Hand Pumps

Irrigation and Industrial