

Magnetic Drive Gear Pump

SERIES 220

Series 220 For a pump that delivers high

precision performance every time, trust the proven reliability of Micropump's Series 220 suction shoe style magnetic drive gear pump. These high performance pumps provide smooth, pulseless delivery and leak-free operation in a convenient, compact unit. The Series 220 pumps are a perfect fit for demanding applications with a wide range of available options, materials, and configurations. With its precision performance and maximum versatility, Series 220 keeps your process flowing smoothly.

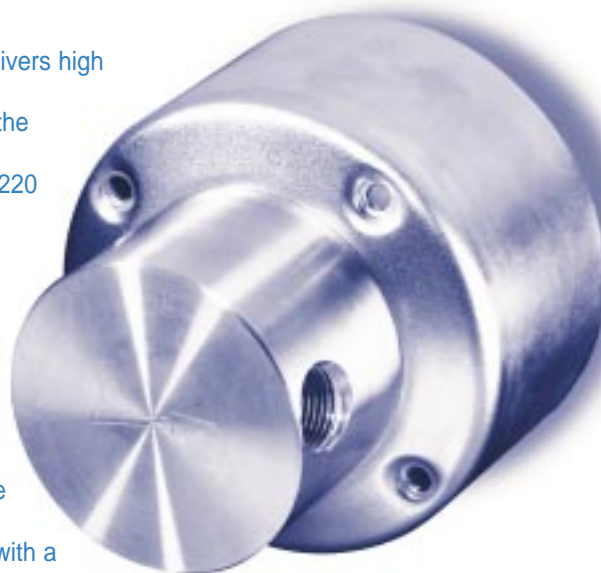

Small Size

The smaller package size of the Series 220 delivers performance that is usually found only in much larger pumps.

Leak-Free

The magnetic drive and a single O-ring seal keep the fluid securely inside the pump and potential contaminants out.

Smooth Pulseless Delivery

Positive displacement, helical gears provide smooth, accurate fluid delivery that is proportional to motor speed.

Chemically Resistant

An extensive range of wetted material options ensure compatibility with a wide range of chemicals.

Easy to Service

Series 220 pumps are easy to service using a Micropump service kit and simple hand tools.

Wide Range of Options

Product design offers the flexibility to configure the product to your specific needs. Some options include:

- Two standard gear sizes
- Two and three gear versions
- Multiple gear, body, and O-ring materials
- Optional high torque magnets
- NEMA, IEC, and Micropump drive mounts

Advanced Pump Technology

Micropump uses the latest engineering tools and manufacturing equipment to produce the most advanced pumping solutions available. Products are developed using state-of-the-art CAD, Finite Element Analysis (FEA), and rapid prototyping tools. Precision CMM and CNC manufacturing equipment ensure the highest level of product quality.

Proven Reliability

Over 40 years of experience solving the most difficult pumping problems go into the design and manufacture of every Micropump pump, ensuring the most reliable pumping solution available.

OEM Configurations

Series 220 pumps can be customized to meet your individual requirements.

High System Pressure Capability

Optional versions of the Series 220 are designed to withstand system pressures up to 103 Bar (1500 psi).

SERIES 220

Magnetic Drive Gear Pump

Performance Summary

Flow Rate			
at 3450 rpm			
12.0 L/min		3.2 gpm	
Displacement (ml/rev)			
Gear Set	M23	M25	M35
ml/rev	0.81	1.82	3.48
Maximum Differential Pressure			
8.7 Bar		125 psi	
Maximum System Pressure			
103 Bar		1500 psi	
Temperature Range			
-46 to 177° C		-50 to 350° F	
Viscosity Range		Maximum Speed	
0.2 to 1500 cps		6000 rpm	

Pump Construction

- Magnetic drive gear pump
- Suction shoe style
- Two or three helical gears
- Stationary shafts
- O-ring seal

Wetted Materials

- Base material
 - 316 stainless steel
 - Alloy 20
 - Titanium
 - Hastelloy C-276®
 - Hastelloy B-2®
- Gears
 - PEEK
 - Ryton® (PPS)
- Static seals
 - Viton®
 - Ethylene propylene
 - Buna N
 - TEV (Teflon® encapsulated Viton)
 - Kalrez®

Magnets

- Driven and driving
 - Ferrite
 - Rare earth

Product Enhancements

- Tri-clamp fittings
- ANSI flanges

Dimensions

NEMA 56C Mount

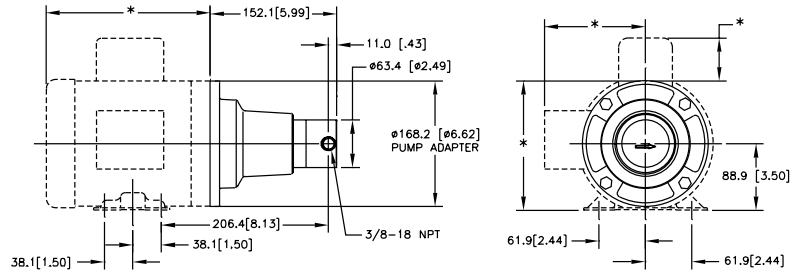

IEC 71-B14 Mount

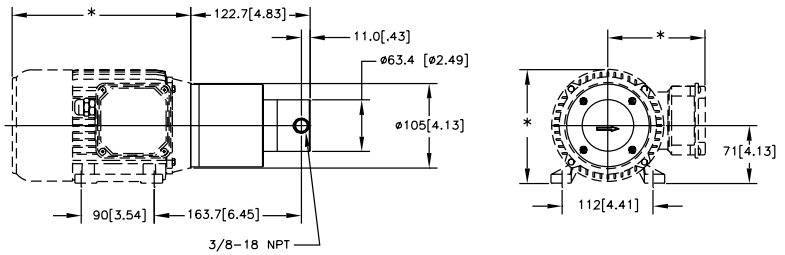

Units: mm[in]. Nominal dimensions shown.

Pump Performance

Water @ 1 CP

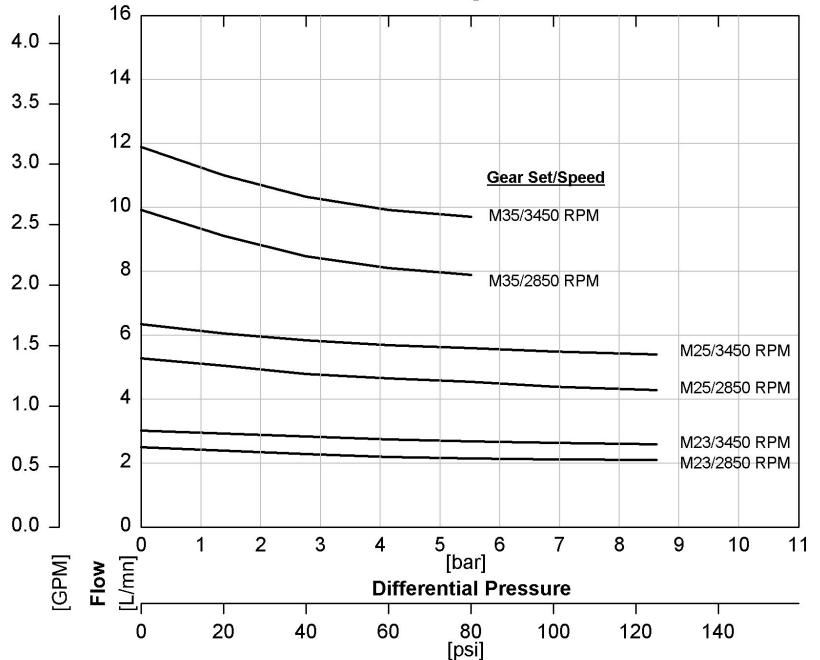

Order Code

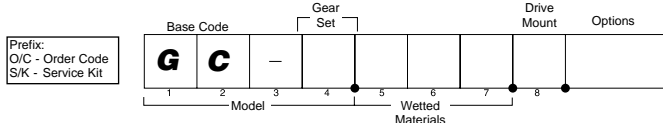

ACTUAL PERFORMANCE MAY VARY

Specifications are subject to change without notice.

©2001 Micropump, Inc., A Unit of IDEX Corporation. Micropump and the Micropump logo are registered trademarks of Micropump, Inc. All other trademarks belong to their respective owners.

TT2750MPV-05/2001

MICROPUMP, INC.

A Unit of IDEX Corporation

Phone: (360) 253-2008 • (800) 671-6269
Fax: (360) 253-2401 • (800) 222-9565

MICROPUMP LIMITED

A Subsidiary of Micropump, Inc.

Phone: + 44 (0) 1480 356900
Fax: + 44 (0) 1480 356920

info@micropump.com
www.micropump.com

