

CUSTOMER DETAILS	
OEM PUMP PART NO	Miscellaneous
MANUFACTURER	Miscellaneous
ENGINE	Miscellaneous
PUMP DESCRIPTION	F35B-9 IMPELLER PUMP OEM

DRAWING POSITION	COMPONENTS	COMPONENT DESCRIPTION	QTY	PARTS LIST			
				IMPELLER KIT	WEAR KIT	SHAFT KIT	SCREW KIT
1	01-35096-4	PUMP BODY F35B-9	1				
2	01-45669	SHAFT F35B-9	1				
3	08-808B-1	IMPELLER F35 MC 97	1	09-808B-1			
4	01-42910	CAM 1/1 F35B-	1		X		
5	01-47761-1	END COVER F35B	1		X		
6	01-43240	GASKET F35B-	1	09-808B-1	X		
7	01-46676	WEAR PLATE F35B-	1		X		
8	01-42400	PIN F35B-/F7B/F70B	1		X		
10	0.0141.700	SCREW M4X8 ISO4017 A2-70 SLOTTED	4		X		
11	01-46794-03	SCREW 8-32UNCX8	1		X		
12	01-46790-01	WASHER D7.5XD4X1 CU	1		X		
13	0.2233.010	LIP SEAL 12X24X7 DPSM	2		X	X	
14	0.3431.748	BALL BEARING 6001 2RS1 ST	2			X	
15	0.0371.028	RETAIN. RING BORE D28 DIN472 SPRST	1			X	
16	0.0370.012	EXT. CIRCLIP D12 DIN471 ST	1			X	
17	0.0502.003	KEY A 3X3X12 DIN6885A ST	1			X	
18	0.2173.468	O-RING 32.1X1.6 SS1586 NBR70	1			X	
19	01-43238	CLAMP F35/F4B-9	1			X	
20	01-45955	WASHER F35/F4B-9	1			X	
21	01-47826-2	MARKING TAG	1				

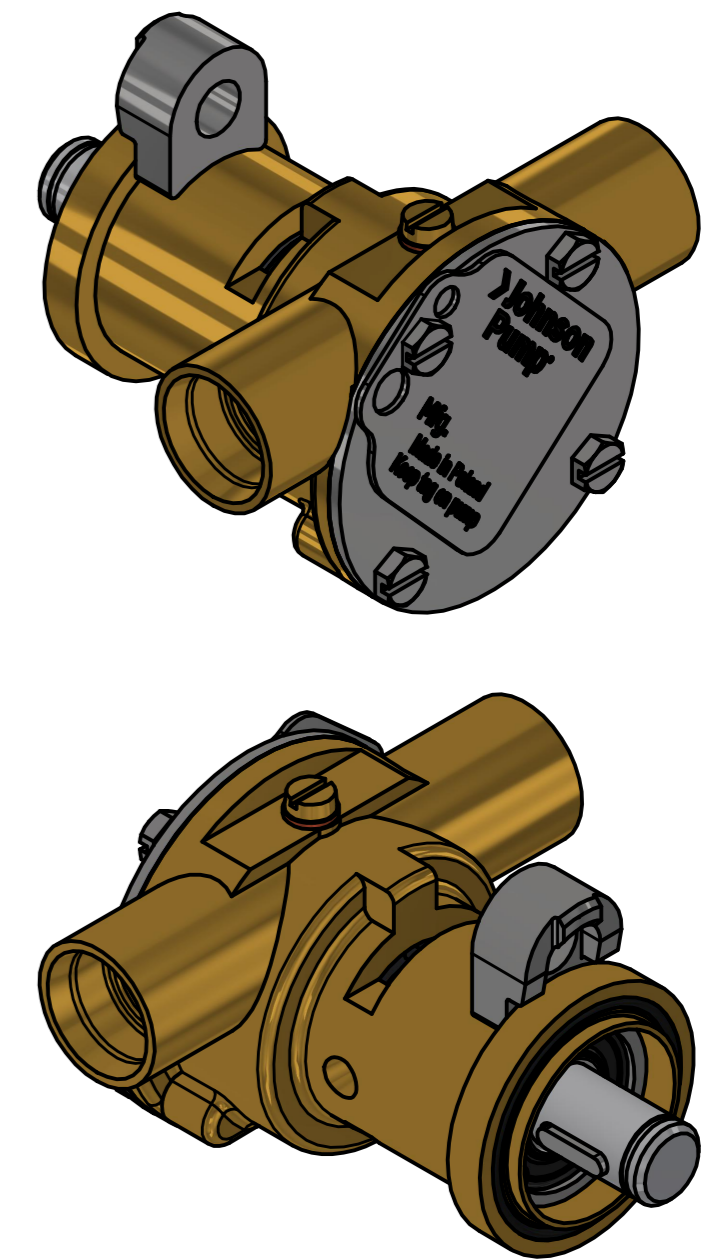
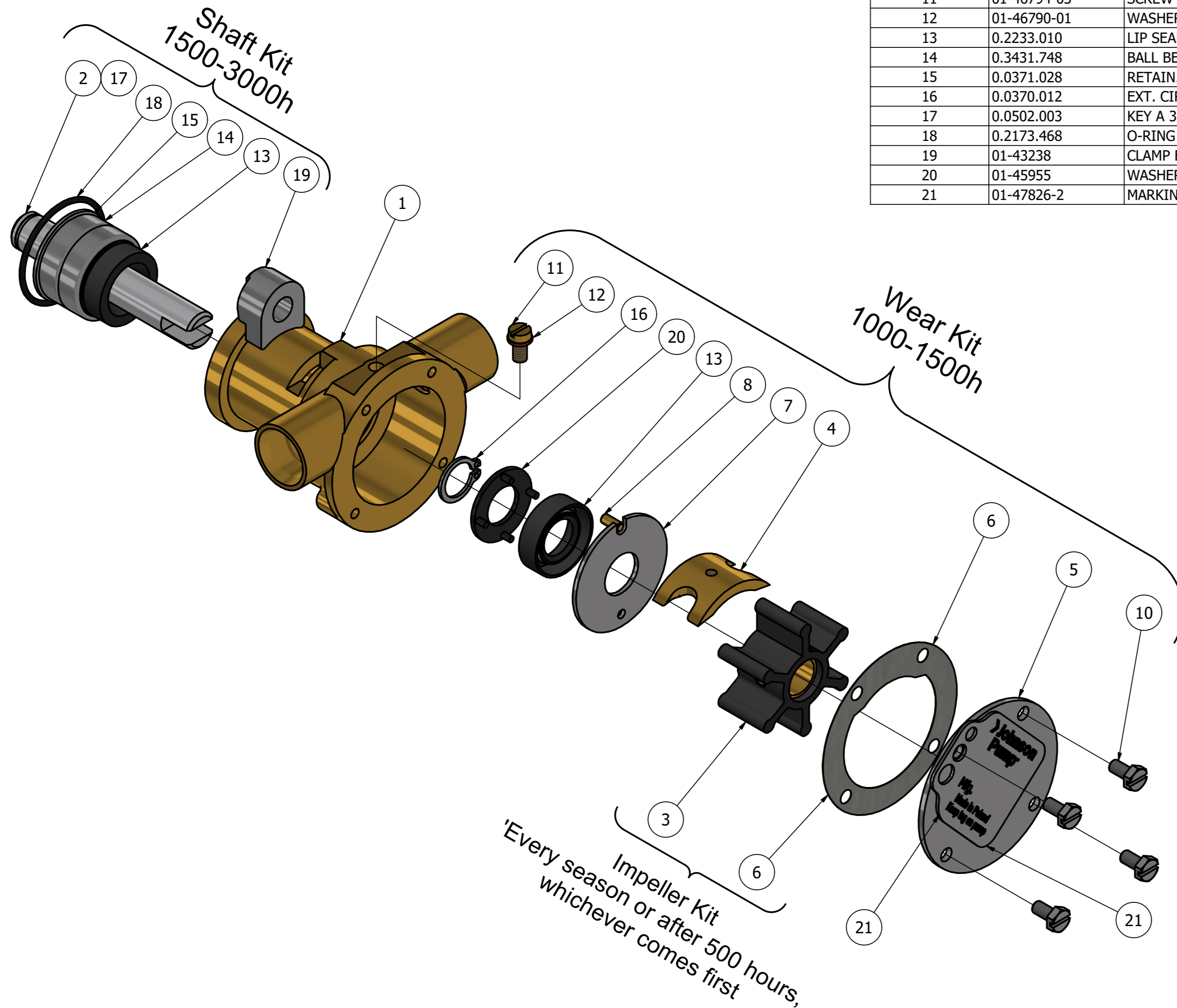

ISO VIEW

REVISION HISTORY				
ECN	REV	ECN DESCRIPTION	DATE	SIGN
	P01			M.G

UNLESS OTHERWISE STATED THE FOLLOWING APPLIES:		NAME	DATE	The component or product design and specified according to this drawing must comply with applicable EHS laws and EU-directives	
Ra in µm	FACES WITHOUT TOLERANCES ACC. TO ISO 2768 - mK	M.G	07-Nov-2024	MASTER	STATUS WorkInProgress
APPROVED	M.G				PROJECTION METHOD ISO 128
MATERIAL		WEIGHT	0.5 kg	TYPE	F35B-9
DIN ISO 13715		PROJECT NUMBER	2652	SCALE	1:1
Outside edge	±0.25	DESCRIPTION		EXPLODED VIEW OF F35B-9 IMPELLER PUMP	
Inside edge	±0.5	PROJECT NUMBER		10-35187-3	
SPXFLOW Johnson Pump		DRAWING NUMBER		REVISION P01	