

CUSTOMER DETAILS	
OEM PUMP PART NO	3583115
MANUFACTURER	VOLVO PENTA
ENGINE	KAD42P-A, KAMD42P-A, HS1A, KAD32P, TAMD42WJ-A, KAD43P-A, KAMD43P, KAMD43P-A, KAMD43P-B, KAD44P, KAD44P-B, KAD44P-C, KAMD44P-A, KAMD44P-C, KAD300-A, KAMD300-A, HS1A, HS1E-A, KAMD44P-BAD31L-A, AD31P-A, AD41L-A, AD41P-A, D41L-A, TAMD31L-A, TAMD31M-A, TAMD31P-A, TAMD31S-A, TAMD41H-A, TAMD41H-B, TAMD41P-A, TAMD41L-A, TAMD41M-A, TMD31L-A, TMD41L-A, TAMD31S, HS1A, TAMD31L, TAMD31P, TAMD41PMD31A, TMD31B, TAMD31B, AD31BTMD41B, D41B, TAMD41B, AD41B, AD41BJKAD42A, KAMD42A, HS1A, MS5BAD31D, AD31D-A, AD31XD, TAMD31D, TMD31DAD41D, D41D, TAMD41D, TMD41D, HS1AKAD42B, KAMD42B, TAMD42B
PUMP DESCRIPTION	F7B-9 IMPELLER PUMP

		PART LIST						
DRAWING POSITION	COMPONENTS	COMPONENT DESCRIPTION	QTY	IMPELLER KIT	WEAR KIT	SHAFT KIT	SCREW KIT	
1	01-24521-11	PUMP BODY F7B	1					
2	01-47769-2	END COVER F7B	1		09-47551-115			
3	08-1028BT-1	IMPELLER F7 MC 97 THREAD	1	09-1028BT-1				
4	01-45844	SHAFT F7B-9	1			09-47552-122		
5	0.2172.012	O-RING 63.22X1.78 NBR70	1	09-1028BT-1	09-47551-115			
6	0.0141.505	SCREW M5X8 ISO4017 (A2) SLOTTED	6		09-47551-115		09-47553-105	
7	01-45181	WASHER F5/F7B-9	1		09-47551-115			
8	0.2233.001	LIP SEAL 16X28X7 DPSM	2		09-47551-115	09-47552-122		
9	0.2173.402	O-RING 15.3X2.4 SS1586 NBR70	1		09-47551-115			
10	0.3431.483	BALL BEARING 6203	2			09-47552-122		
11	0.0371.040	RETAIN. RING BORE D40 DIN472 SPRST	1			09-47552-122		
12	01-46816-3	WEAR PLATE F7B-9	1		09-47551-115			
13	01-47826-2	MARKING TAG	1					

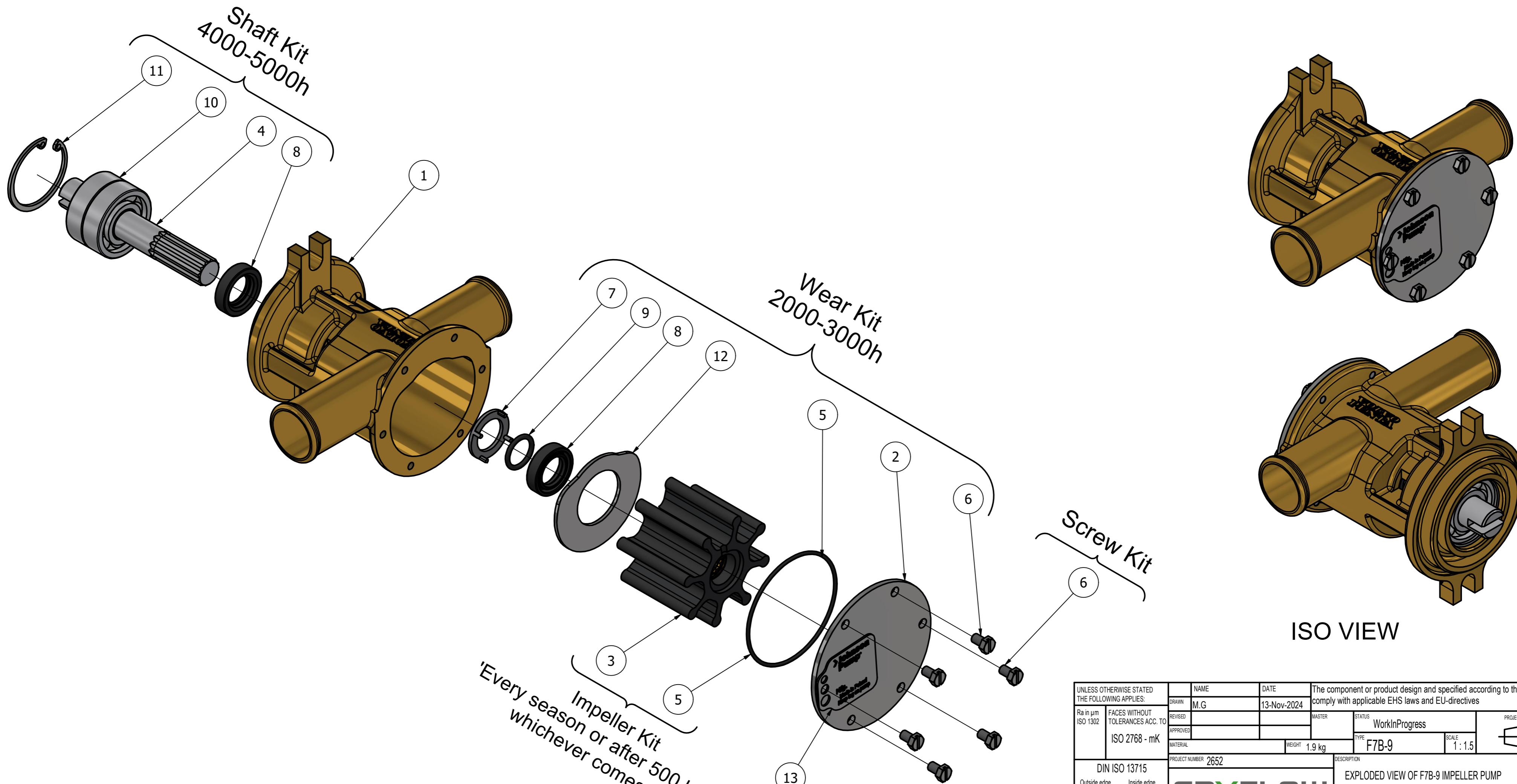

Every season or after 500 hours, whichever comes first

REVISION HISTORY				
ECN	REV	ECN DESCRIPTION	DATE	SIGN
	P01			

UNLESS OTHERWISE STATED THE FOLLOWING APPLIES:		NAME	DATE	The component or product design and specified according to this drawing must comply with applicable EHS laws and EU-directives	
Ra in µm	FACES WITHOUT TOLERANCES ACC. TO	M.G	13-Nov-2024	MASTER	STATUS WorkInProgress
ISO 1302	ISO 2768 - mK	APPROVED			PROJECTION METHOD ISO 128
		MATERIAL	WEIGHT 1.9 kg	TYPE F7B-9	SCALE 1:1.5
DIN ISO 13715		PROJECT NUMBER 2652	DESCRIPTION EXPLODED VIEW OF F7B-9 IMPELLER PUMP		
Outside edge	Inside edge	SPXFLOW		DRAWING NUMBER 10-24524-12	
0.25	0.5	Johnson Pump		REVISION P01	

This Drawing/Document and information shown contains proprietary information of SPX FLOW and must not without permission and written consent be reproduced, copied, transmitted, transferred, disclosed, undue use, shown or handed out to any unauthorized person and is to be maintained in confidence.