

CUSTOMER DETAILS

OEM PUMP PART NO	970311169B & 16860-67010
MANUFACTURER	NANNI DIESEL & TOYOTA
ENGINE	T4 & 120Z
PUMP DESCRIPTION	F6B-9 IMPELLER PUMP

PART LIST

DRAWING POSITION	COMPONENTS	COMPONENT DESCRIPTION	QTY	IMPELLER KIT	WEAR KIT	SHAFT KIT	SCREW KIT
1	01-13194-2	PUMP BODY F6B-9	1				
2	01-46596	SHAFT F6B-9	1			09-47805	
3	01-47768-1	END COVER F6B-9	1		09-47804		
4	08-812BT-1	IMPELLER F6 MC 97	1	09-812BT-1			
5	0.2173.475	O-RING 57.6X2.4 SS1586 NBR70	1	09-812BT-1	09-47804		
6	0.2233.408	LIP SEAL 16X28X7 DPSM (SS + SS)	1		09-47804		
7	0.3431.742	BALL BEARING 6203-2RSH	2			09-47805	
8	0.2173.402	O-RING 15.3X2.4 SS1586 NBR70	1		09-47804		
9	0.0370.017	RETAIN. RING SHAFT D17 DIN471 SPRST	1			09-47805	
10	0.0141.503	SCREW M5X12 ISO4017 (A4) SLOTTED	4		09-47804		09-47553-109
11	0.0371.040	RETAIN. RING BORE D40 DIN472 SPRST	1			09-47805	
12	0.2234.014	LIP SEAL 24X40X7 BAUMSLX7 FPM	1			09-47805	
13	01-42862	SPACER S200/500 HD	1			09-47805	
14	01-47826-2	MARKING TAG	1				

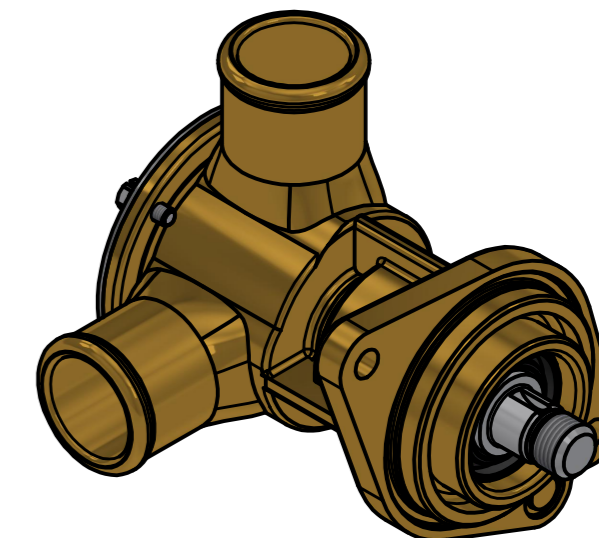
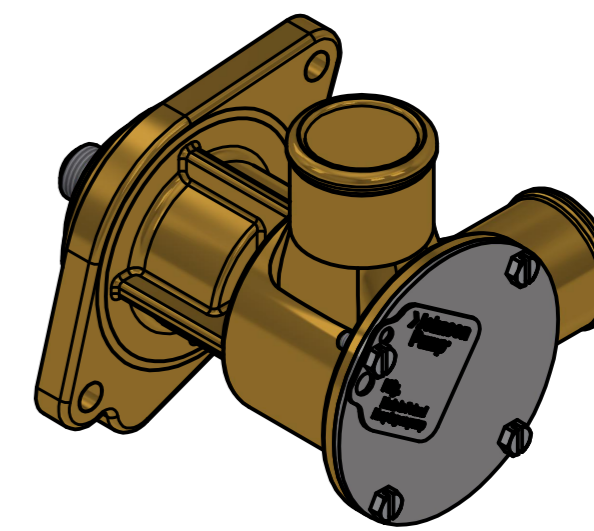
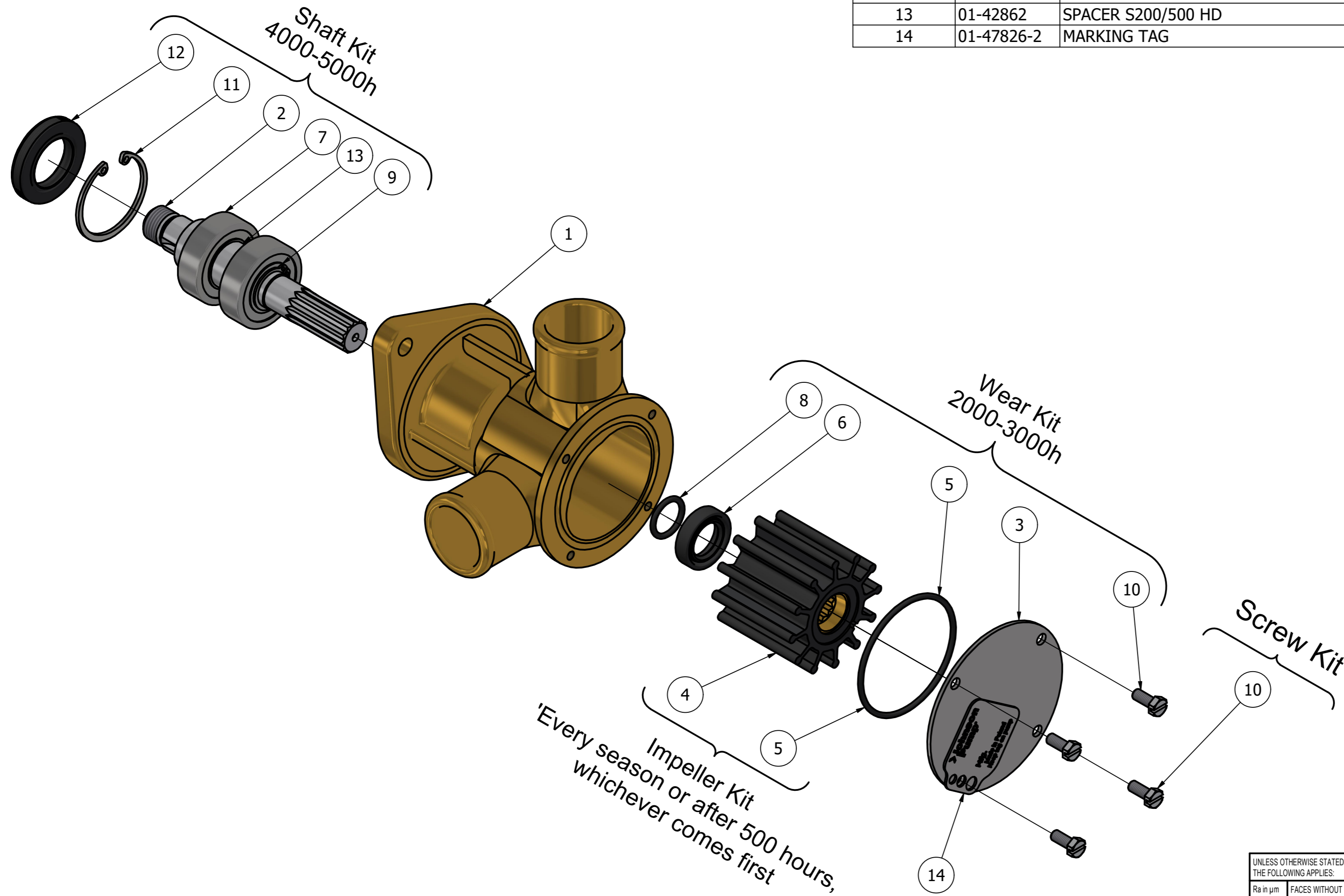

ISO VIEW

This Drawing/Document and information shown contains proprietary information of SPX FLOW and must not be reproduced, copied, transmitted, transferred, disclosed, undue use, shown or handed out to any unauthorized person and is to be maintained in confidence.

REVISION HISTORY

ECN	REV	ECN DESCRIPTION	DATE	SIGN
	P01			

UNLESS OTHERWISE STATED THE FOLLOWING APPLIES:		NAME	DATE	The component or product design and specified according to this drawing must comply with applicable EHS laws and EU-directives	
Ra in µm	FACES WITHOUT TOLERANCES ACC. TO ISO 2768 - mK	M.G.	12-Nov-2024	MASTER	STATUS WorkInProgress
ISO 1302					PROJECTION METHOD ISO 128
				WEIGHT 2.2 kg	TYPE F6B-9
					SCALE 1:2
DIN ISO 13715		PROJECT NUMBER 2652		DESCRIPTION EXPLODED VIEW OF F6B-9 IMPELLER PUMP	
Outside edge	Inside edge	SPXFLOW		DRAWING NUMBER 10-24515-11	
±0.25	±0.5	Johnson Pump		REVISION P01	