

CUSTOMER DETAILS

OEM PUMP PART NO	RE49556
MANUFACTURER	JOHN DEERE
ENGINE	4039D and 4045T (RE49556), RE49556
PUMP DESCRIPTION	F7B-9 IMPELLER PUMP OEM

PART LIST

DRAWING POSITION	COMPONENTS	COMPONENT DESCRIPTION	QTY	IMPELLER KIT	WEAR KIT	SHAFT KIT	SCREW KIT
1	01-24125-4	PUMP BODY CPL F7B-9	1				
2	01-47769-1	END COVER F7B-	1		X		
3	08-1028BT-1	IMPELLER F7 MC 97 THREAD	1	09-1028BT-1			
4	01-42679	CAM 1/1 F7B/F70B	1		X		
6	01-42445	GASKET F4B/F7B-	1	09-1028BT-1	X		
7	01-46469	SHAFT F7B-9	1			X	
8	0.0141.505	SCREW M5X8 ISO4017 (A2) SLOTTED	6		X		09-47553-105
9	0.2233.416	LIP SEAL NT 4502 ADP (16X28X7)	2		X	X	
10	0.2173.402	O-RING 15.3X2.4 SS1586 NBR70	1			X	
11	0.3431.742	BALL BEARING 6203-2RSH	2			X	
12	0.0371.040	RETAIN. RING BORE D40 DIN472 SPRST	1			X	
13	01-46794-01	SCREW 12-24 UNC X 9.5 BRASS	1		X		
14	01-45181	WASHER F5/F7B-9	1		X		
15	01-46321	GUIDE RING F7B-9	1			X	
16	01-35693	CARRIER F7B-9	1				
17	01-46396	BUSHING F7B-9	2				
18	01-47826-2	MARKING TAG	1				

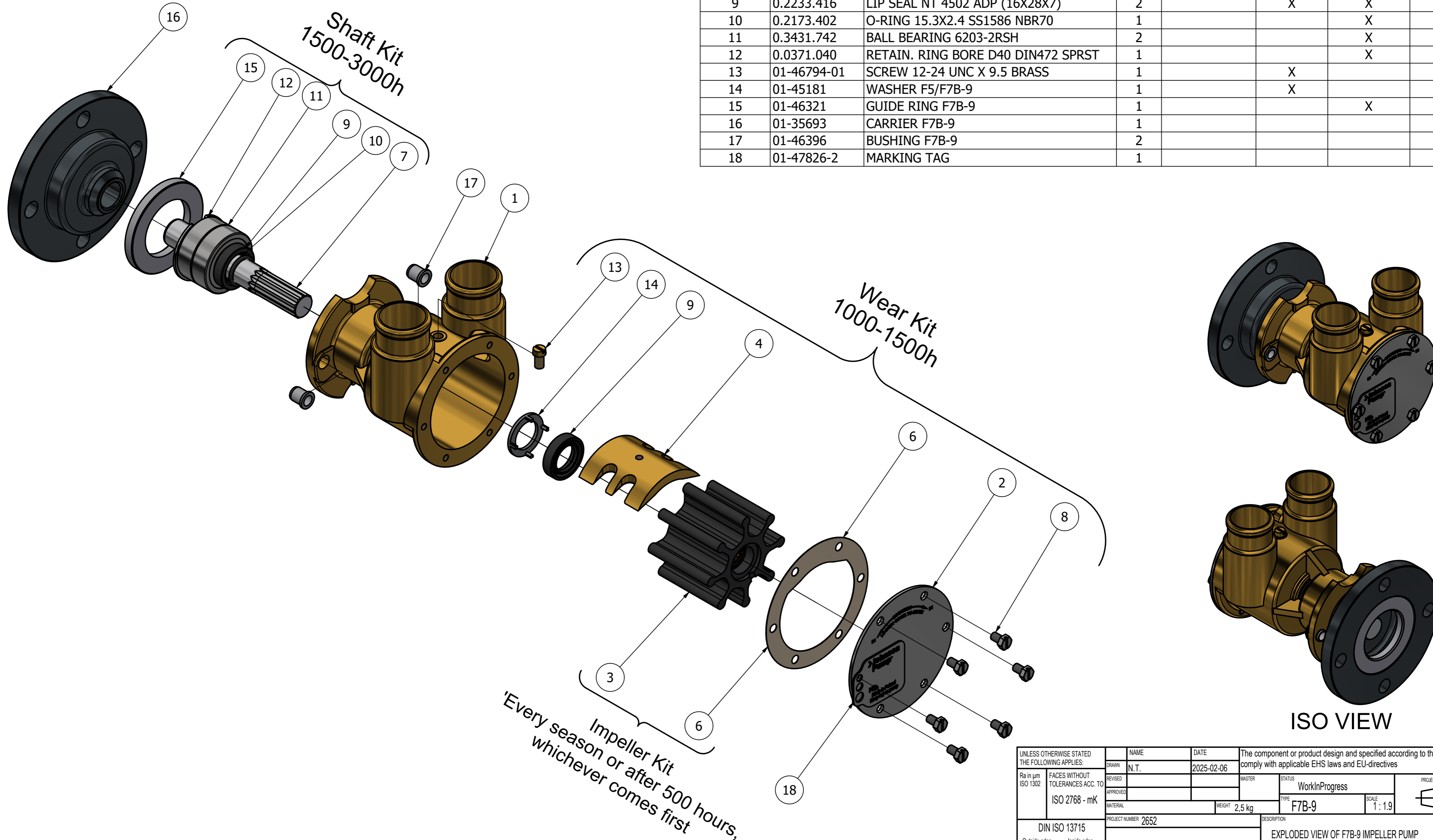

REVISION HISTORY				
ECN	REV	ECN DESCRIPTION	DATE	SIGN
	P01		06-Feb-2025	

UNLESS OTHERWISE STATED THE FOLLOWING APPLIES:		NAME	DATE	The component or product design and specified according to this drawing must comply with applicable EHS laws and EU-directives	
Ra in µm	FACES WITHOUT TOLERANCES ACC. TO ISO 2768 - mK	REVISION	2025-02-06	MASTER	STATUS WorkInProgress
ISO 1302		APPROVED			PROJECTION METHOD ISO 128
		MATERIAL	WEIGHT 2,5 kg	TYPE F7B-9	SCALE 1:1.9
DIN ISO 13715		PROJECT NUMBER 2652	DESCRIPTION EXPLODED VIEW OF F7B-9 IMPELLER PUMP		
Outside edge	Inside edge			DRAWING NUMBER 10-24428-01	
0.25	+0.5				REVISION P01

This Drawing/Document and information shown contains proprietary information of SPX FLOW and must not without permission and written consent be reproduced, copied, transmitted, transferred, disclosed, undue use, shown or handed out to any unauthorized person and is to be maintained in confidence.