

CUSTOMER DETAILS

OEM PUMP PART NO	RE503068
MANUFACTURER	JOHN DEERE
ENGINE	PowerTech 4.5L, 4045DFM70/TFM75, Powertech 6.8L
PUMP DESCRIPTION	F7B-9 IMPELLER PUMP - FLANGE MOUNT OEM

PART LIST

DRAWING POSITION	COMPONENTS	COMPONENT DESCRIPTION	QTY	IMPELLER KIT	WEAR KIT	SHAFT KIT	SCREW KIT
1	01-24125-2	PUMP BODY CPL F7B-9	1				
2	01-35670	SHAFT F7B-9	1			09-47859	
3	01-42679	CAM 1/1 F7B/F70B	1		09-47858		
4	08-1028BT-1	IMPELLER F7 MC 97 THREAD	1	09-1028BT-1			
5	01-47769-1	END COVER F7B-	1		09-47858		
6	01-42445	GASKET F4B/F7B-	1	09-1028BT-1	09-47858		
7	01-45181	WASHER F5/F7B-9	1		09-47858		
8	01-35213-2	FLANGE F7B-9	1				
9	01-45754	GASKET F7B-9	1		09-47858		
10	0.0141.505	SCREW M5X8 ISO1207 BRASS	6		09-47858		0-47553-105
11	01-46794-01	SCREW 12-24UNCX9.5 BRASS	1		09-47858		
12	0.0141.911	TAP BOLT M6X20 DIN933 8.8ZP	4			09-47859	
13	0.0353.402	SPRING WASHER D6.1 X D11.8 X1.6	4			09-47859	
14	0.2233.416	LIP SEAL NT 4502 ADP (16X28X7)	2		09-47858	09-47859	
15	0.2173.402	O-RING 15.3X2.4 SS1586 NBR70	1			09-47859	
16	0.0370.516	EXT. CIRCLIP D16 DIN471 PHB	1		09-47858		
17	0.0371.040	RETAIN. RING BORE D40 DIN472 SPRST	1			09-47859	
18	0.0370.017	RETAIN. RING SHAFT D17 DIN471 SPRST	1			09-47859	
19	0.3431.483	BALL BEARING 6203	2			09-47859	
20	01-47826-2	MARKING TAG	1				

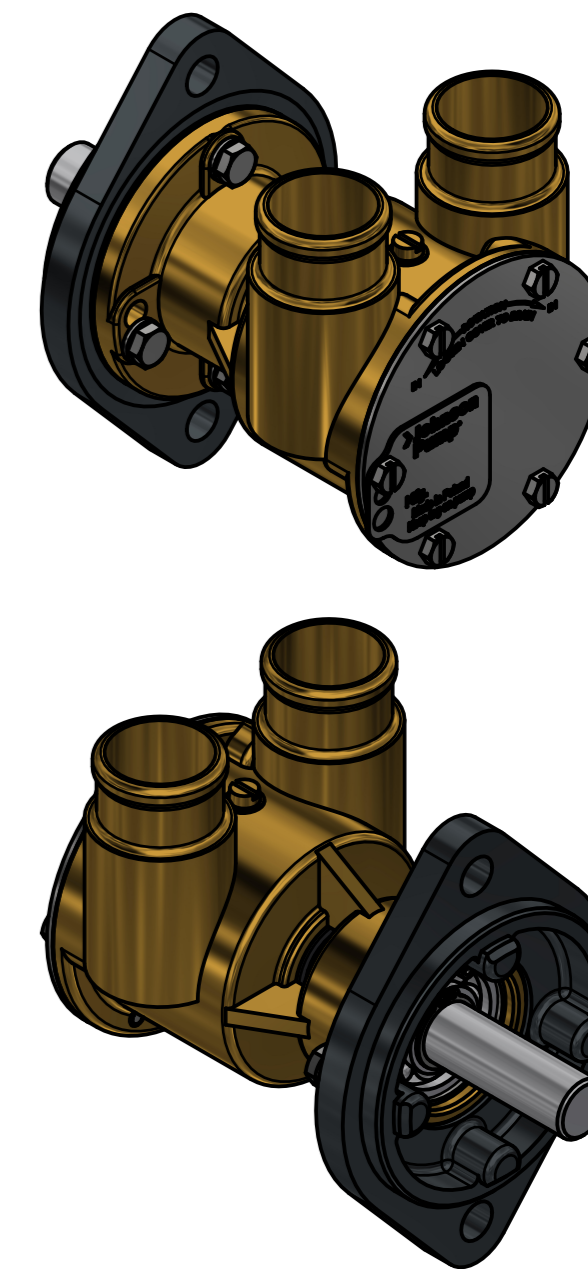
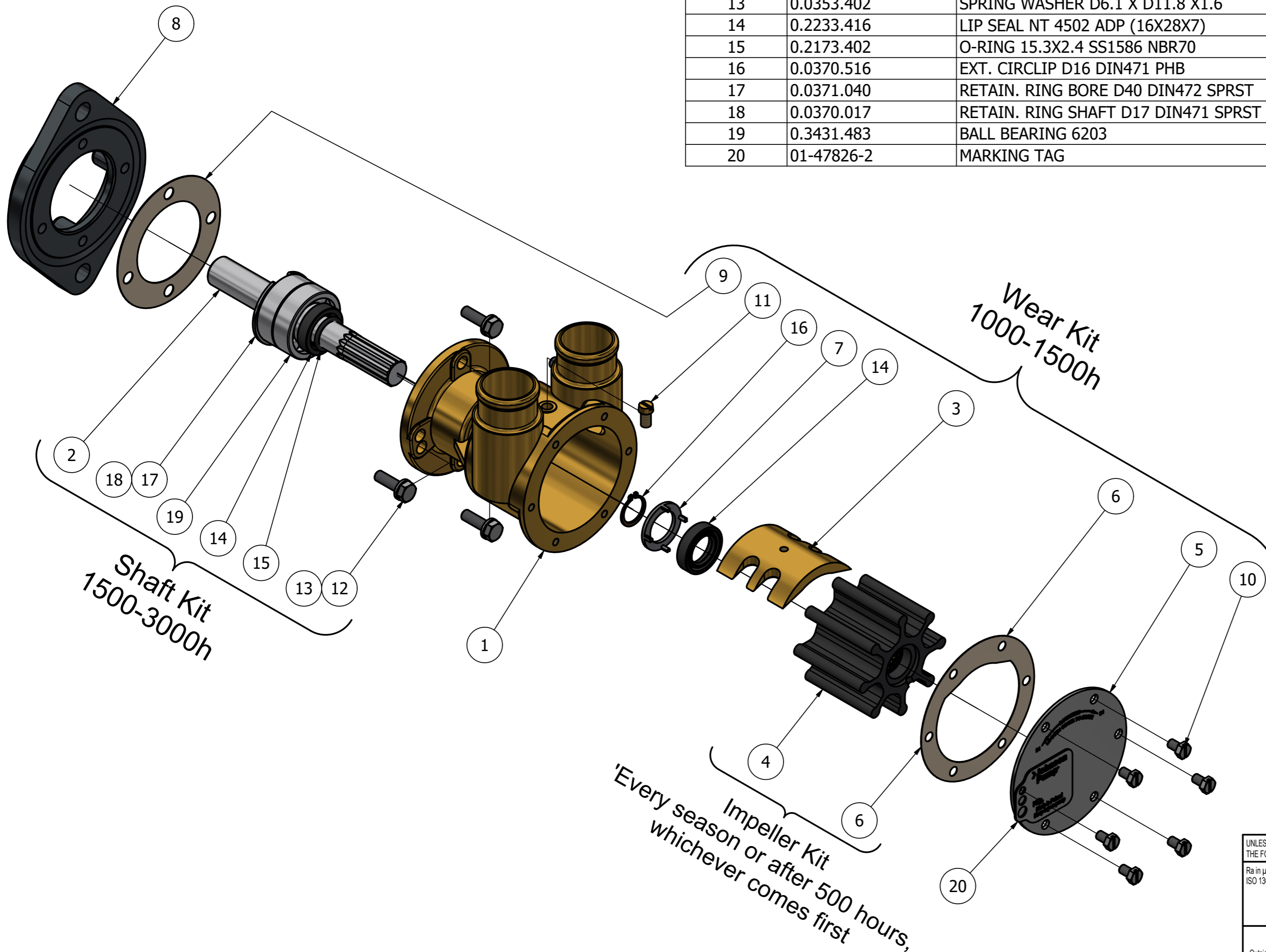

ISO VIEW

REVISION HISTORY				
ECN	REV	ECN DESCRIPTION	DATE	SIGN
	P01		06-Feb-2025	

UNLESS OTHERWISE STATED THE FOLLOWING APPLIES:		NAME	DATE	The component or product design and specified according to this drawing must comply with applicable EHS laws and EU-directives	
Ra in µm	FACES WITHOUT TOLERANCES ACC. TO	REVISION	2025-02-06	MASTER	STATUS WorkInProgress
ISO 1302	ISO 2768 - mK	APPROVED			PROJECTION METHOD ISO 128
		MATERIAL	WEIGHT 2,4 kg	TYPE F7B-9	SCALE 1:1.9
DIN ISO 13715		PROJECT NUMBER 2652	DESCRIPTION		
Outside edge	Inside edge	EXPLODED VIEW OF F7B-9 IMPELLER PUMP - FLANGE MOUNT			
±0.25	±0.5			DRAWING NUMBER	REVISION
				10-24398-02	P01

This Drawing/Document and information shown contains proprietary information of SPX FLOW and must not without permission and written consent be reproduced, copied, transmitted, transferred, disclosed, undue use, shown or handed out to any unauthorized person and is to be maintained in confidence.