

CUSTOMER DETAILS

OEM PUMP PART NO	DZ116559
MANUFACTURER	JOHN DEERE
ENGINE	Deere S350, 4039DFM01, 4045TFM01, 6068DFM01, 6068TFM01, 4045TFM75, 4045DFM70, 6068TFM75/TFM76, 6068SFM50, 6068TFM50, 4045DFM50, 4045TFM50
PUMP DESCRIPTION	F7B-9 IMPELLER PUMP OEM

PART LIST

DRAWING POSITION	COMPONENTS	COMPONENT DESCRIPTION	QTY	IMPELLER KIT	WEAR KIT	SHAFT KIT	SCREW KIT
1	01-13581-1	PUMP BODY F7B-9	1				
2	01-36317	SHAFT F7B-9	1			09-47671-01	
3	01-47769-2	END COVER F7B	1		09-47121		
4	08-1028BT-01	IMPELLER F7 MC 97 THREAD	1	09-1028BT-1			
5	01-46899	CAM 1/1 F7B	1		09-47121		
6	01-42400	PIN F35B-/F7B/F70B	1		09-47121		
7	01-46798-2	WEAR PLATE F7B	1		09-47121		
8	01-45680	WASHER F5B/F6B/F7B	1		09-47121		
9	0.2233.410	LIP SEAL 20X40X7 HMS5V VITON	1			09-47671-01	
10	0.0141.505	SCREW M5X8 ISO4017 (A2) SLOTTED	7		09-47121		09-47553-105
11	0.2172.012	O-RING 63.22X1.78 NBR70	1	09-1028BT-1	09-47121		
12	0.2230.015	V-RING 15.5-17.5 NBR 65SH	1		09-47121	09-47671-01	
13	0.3431.742	BALL BEARING 6203-2RSH	1			09-47671-01	
14	0.3431.483	BALL BEARING 6203	1			09-47671-01	
15	0.2247.022	MECH. SEAL COMPL D16	1		09-47121		
16	0.0371.040	RETAIN. RING BORE D40 DIN472 SPRST	1			09-47671-01	
17	0.0370.516	EXT. CIRCLIP D16 DIN471 PHB	1		09-47121		
18	01-42427-15	SLINGER F8/F9B-	1		09-47121	09-47671-01	
19	01-47826-2	MARKING TAG	1				

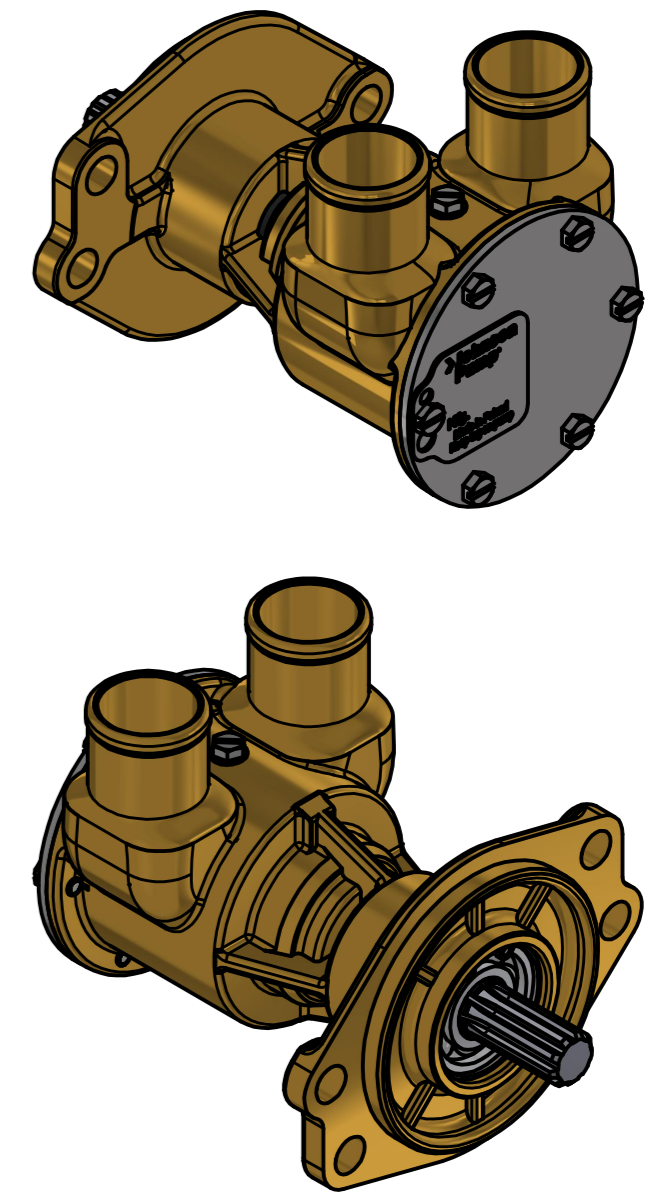
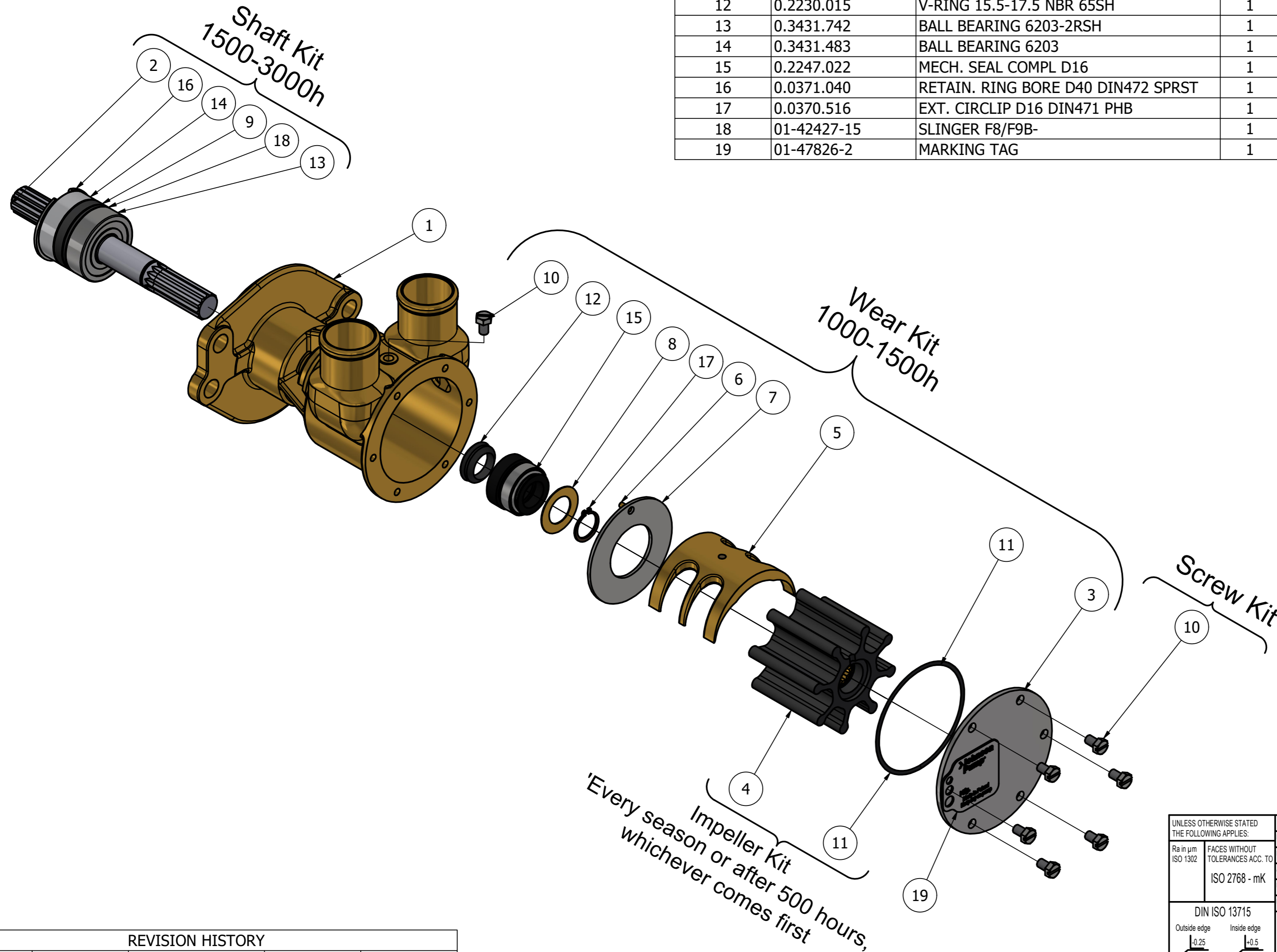

ISO VIEW

REVISION HISTORY				
ECN	REV	ECN DESCRIPTION	DATE	SIGN
	P01		04-Nov-2024	M.G

UNLESS OTHERWISE STATED THE FOLLOWING APPLIES:		NAME	DATE	The component or product design and specified according to this drawing must comply with applicable EHS laws and EU-directives	
Ra in µm ISO 1302	FACES WITHOUT TOLERANCES ACC. TO ISO 2768 - mK	M.G	04-Nov-2024	MASTER	STATUS WorkInProgress
		M.G			PROJECTION METHOD ISO 128
				WEIGHT 2.3 kg	TYPE F7B-9
					SCALE 1:1.75
DIN ISO 13715		PROJECT NUMBER 2652		DESCRIPTION	
Outside edge	Inside edge	SPXFLOW		EXPLODED VIEW OF F7B-9 IMPELLER PUMP	
↙ ±0.25	↘ ±0.5	Johnson Pump		DRAWING NUMBER 10-13599-02	
					REVISION P01