

CUSTOMER DETAILS

OEM PUMP PART NO	1923450
MANUFACTURER	SCANIA
ENGINE	D13
PUMP DESCRIPTION	F9B-9 IMPELLER PUMP

PART LIST

DRAWING POSITION	COMPONENTS	COMPONENT DESCRIPTION	QTY	IMPELLER KIT	WEAR KIT	SHAFT KIT	SCREW KIT
1	01-13079-11	PUMP BODY F9B-9	1				
2	01-36215	SHAFT F9B-9	1			09-47789	
3	01-45173	CAM 1/1 F9B-9	1		09-47555-106		
4	08-814B	IMPELLER F9 NEOPRENE	1	09-814B			
5	01-47771-2	END COVER F8/F9/F95 SS	1		09-47555-106		
6	0.2172.142	O-RING 90.00X2.5 NBR70	1	09-814B	09-47555-106		
7	01-46538	WEAR PLATE F8/F9/F95 SS	1		09-47555-106		
8	01-42426-2	PIN	1		09-47555-106		
9	01-42427-15	SLINGER F8/F9B-	1		09-47555-106	09-47789	
10	0.0138.134	TAP BOLT M6X12 DIN933 A2	5				09-47553-107
11	0.0252.189	ALLEN SCREW M8X25 DIN912 A4	1		09-47555-106		
12	01-46790-02	WASHER D8.2XD14X1 CU	1		09-47555-106		
13	0.0370.525	EXT. CIRCLIP D25 DIN471 BRONZE	1		09-47555-106		
14	0.0371.072	RETAIN. RING BORE D72 DIN472 SPRST	1			09-47789	
15	0.0370.030	RETAIN. RING SHAFT D30 DIN471 SPRST	2			09-47789	
16	0.2247.008	MECH. SEAL COMPL FA25.47.14	1		09-47555-106		
17	0.2234.006	LIP SEAL 30X62X7 DIN3760	1			09-47789	
18	0.3431.684	ANGULAR CONTACT BEARING 3306ATN9	1			09-47789	
19	0.0257.050	ALLEN SCREW M10X30	2			09-47789	
20	0.0350.004	WASHER D10.5 DIN125B ST	2				
21	0.2173.891	O-RING 110,72X3,53 (VITON)	1			09-47789	
23	01-24824	BEARING HOUSING F9B-9	1				
24	0.0502.412	KEY 8X7-18 DIN6885A 316TI	1			09-47789	
25	01-47431	WASHER	1			09-47789	
26	0.0141.166	TAP BOLT M12X25 DIN933 8.8	1			09-47789	
27	01-24825	GEAR WHEEL	1			09-47789	
28	01-47826-2	MARKING TAG	1				

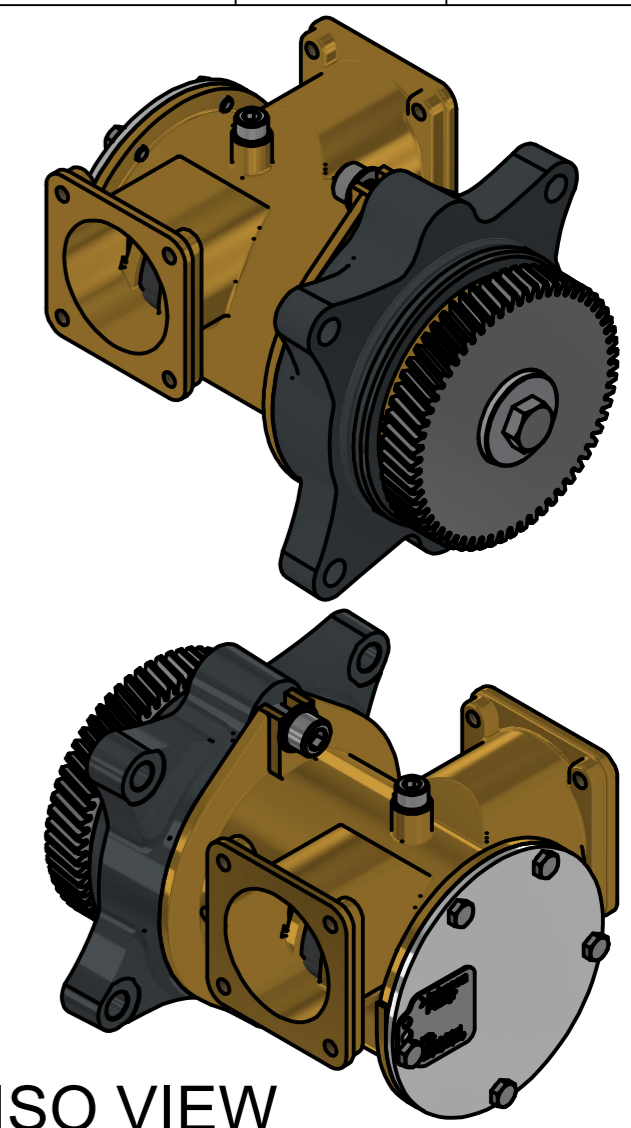
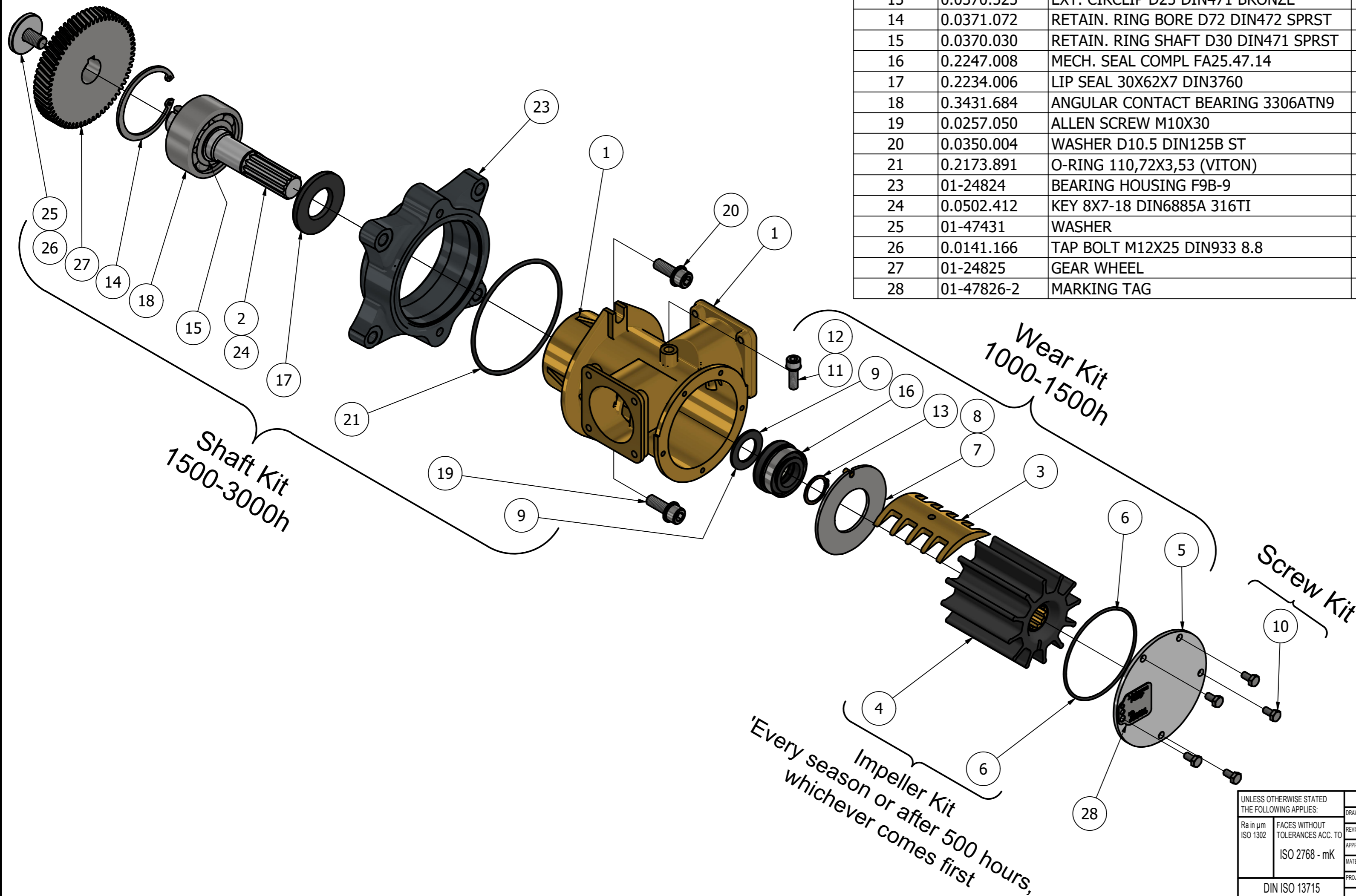

ISO VIEW

REVISION HISTORY

ECN	REV	ECN DESCRIPTION	DATE	SIGN
	P01			SHETTY N.

UNLESS OTHERWISE STATED THE FOLLOWING APPLIES:		NAME	DATE	The component or product design and specified according to this drawing must comply with applicable EHS laws and EU-directives	
Ra in µm	FACES WITHOUT TOLERANCES ACC. TO ISO 2768 - mK	SHETTY N.	15-Nov-2024	MASTER	STATUS WorkInProgress
APPROVED	ISO 2768 - mK	SHETTY N.		PROJECT NUMBER 2652	DESCRIPTION EXPLODED VIEW OF F9B-9 IMPELLER PUMP
MATERIAL			WEIGHT 9.6 kg	TYPE F9B-9	SCALE 1:3
DIN ISO 13715		PROJECTION METHOD ISO 128		DRAWING NUMBER 10-13517-11	
Outside edge	Inside edge	SPXFLOW		REVISION P01	
0.25	0.5	Johnson Pump			

This Drawing/Document and information shown contains proprietary information of SPX FLOW and must not without permission and written consent be reproduced, copied, transmitted, transferred, disclosed, undue use, shown or handed out to any unauthorized person and is to be maintained in confidence.