

CUSTOMER DETAILS

OEM PUMP PART NO	
MANUFACTURER	
ENGINE	
PUMP DESCRIPTION	F6B-9 IMPELLER PUMP

PART LIST

DRAWING POSITION	COMPONENTS	COMPONENT DESCRIPTION	QTY	IMPELLER KIT	WEAR KIT	SHAFT KIT	SCREW KIT
1	01-13332-1	PUMP BODY F6B-9	1				
2	01-36010	SHAFT F6B-9	1			X	
3	01-46502	CAM 1/1 F6B-9	1		X		
4	01-47768-1	END COVER F6B-9	1		X		
5	08-812B	IMPELLER F6 NEOPRENE	1	09-812BT-1			
6	0.3431.778	BALL BEARING 6303-2RSH	2			X	
7	0.2247.022	MECH. SEAL COMPL D16	1		X		
8	01-45680	WASHER F5B/F6B/F7B	1		X		
9	0.0370.516	EXT. CIRCLIP D16 DIN471 PHB	1		X		
10	01-42399-2	WEAR PLATE SS F5B	1		X		
11	0.0279.033	SCREW M5X8 ISO1207 BRASS	1		X		
12	0.0370.017	RETAIN. RING SHAFT D17 DIN471 SPRST	2			X	
13	0.0371.047	RETAIN. RING BORE D47 DIN472 SPRST	1			X	
14	0.2233.405	LIP SEAL 17X47X7 NITRILE	1			X	
15	0.2173.475	O-RING 57.6X2.4 SS1586 NBR70	1	09-812BT-1	X		
16	0.0141.502	SCREW M5X8 DIN933SLOTTED BRASS	4		X		
17	0.2230.015	V-RING 15.5-17.5 NBR/65SH	1			X	
18	01-42400	PIN F35B-/F7B/F70B	1		X		
19	01-47826-2	MARKING TAG	1				

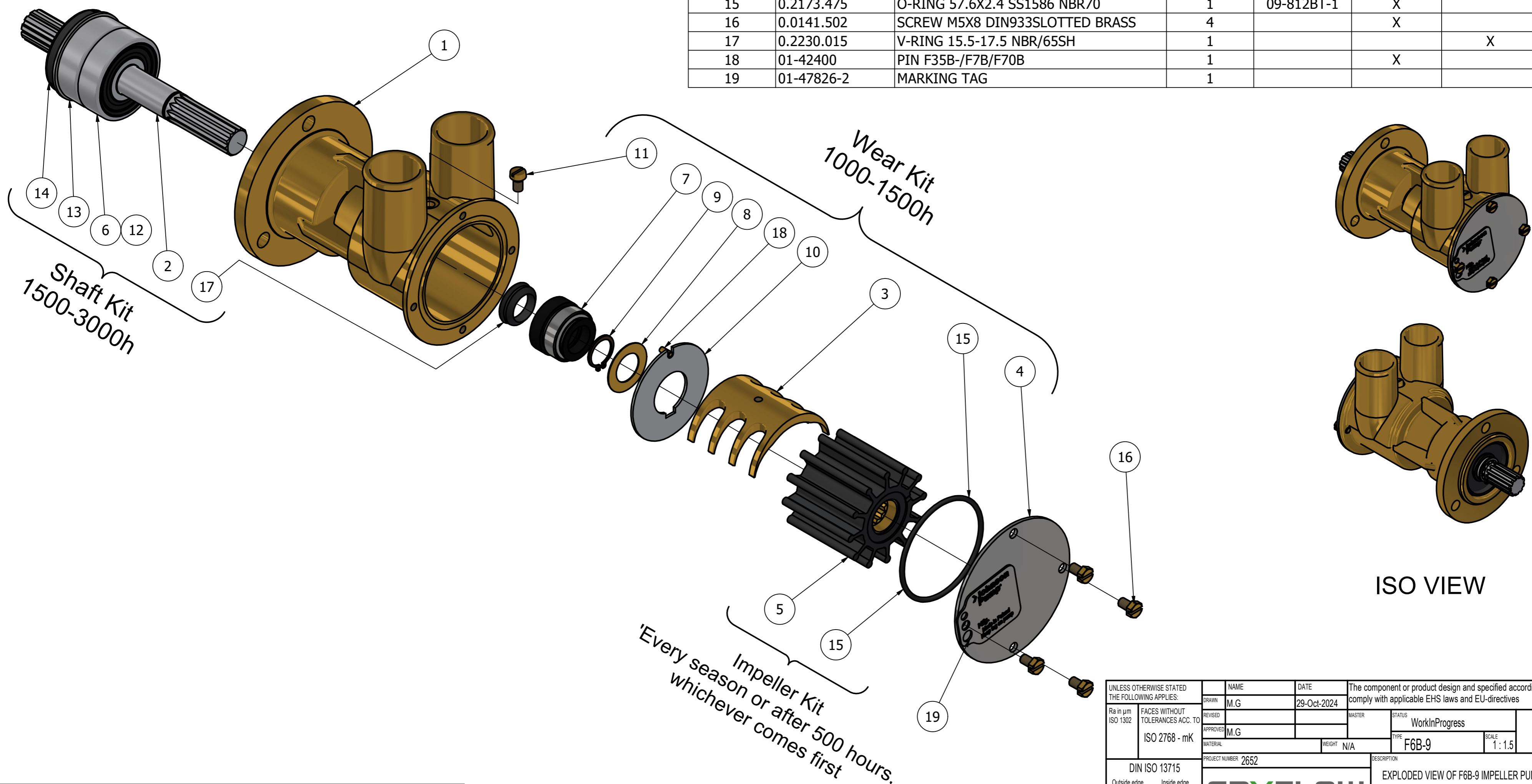

ISO VIEW

This Drawing/Document and information shown contains proprietary information of SPX FLOW and must not without permission and written consent be reproduced, copied, transmitted, transferred, disclosed, undue use, shown or handed out to any unauthorized person and is to be maintained in confidence.

REVISION HISTORY

ECN	REV	ECN DESCRIPTION	DATE	SIGN
	P01			

UNLESS OTHERWISE STATED THE FOLLOWING APPLIES:		NAME	DATE	The component or product design and specified according to this drawing must comply with applicable EHS laws and EU-directives	
Ra in µm	FACES WITHOUT TOLERANCES ACC. TO	REVISION	29-Oct-2024	MASTER	STATUS WorkInProgress
ISO 1302	ISO 2768 - mK	APPROVED			PROJECTION METHOD ISO 128
		MATERIAL		WEIGHT N/A	TYPE F6B-9
					SCALE 1:1.5
DIN ISO 13715		PROJECT NUMBER 2652	DESCRIPTION		
Outside edge	Inside edge	EXPLODED VIEW OF F6B-9 IMPELLER PUMP			
±0.25	±0.5			DRAWING NUMBER 10-13333-01	
					REVISION P01