

CUSTOMER DETAILS

|                  |  |
|------------------|--|
| OEM PUMP PART NO | 3830699  |
| MANUFACTURER     | VOLVO PENTA  |
| ENGINE           | TAMD74A, TAMD74A-A, TAMD74A-B, TAMD74C-A, TAMD74C-B, TAMD74L-A, TAMD74L-B, TAMD74P-A, TAMD74P-B, TAMD75P-A; TAMD71B, TAMD73P-A, TAMD73WJ-A |
| PUMP DESCRIPTION | F8B-9 IMPELLER PUMP  |

PART LIST

| DRAWING POSITION | COMPONENTS  | COMPONENT DESCRIPTION               | QTY | IMPELLER KIT | WEAR KIT     | SHAFT KIT    | SCREW KIT    |
|------------------|-------------|-------------------------------------|-----|--------------|--------------|--------------|--------------|
| 1                | 01-13262-11 | PUMP HOUSING F8B                    | 1   |              |              |              |              |
| 2                | 01-35910    | SHAFT F8-9                          | 1   |              |              | 09-47552-129 |              |
| 3                | 01-42680    | CAM 1/1 F8B                         | 1   |              | 09-47551-121 |              |              |
| 4                | 01-46538    | WEAR PLATE F8/F9/F95 SS             | 1   |              | 09-47551-121 |              |              |
| 5                | 01-42426    | PIN                                 | 1   |              | 09-47551-121 |              |              |
| 6                | 01-47771-1  | END COVER F8B/F9B-                  | 1   |              | 09-47551-121 |              |              |
| 7                | 0.2172.142  | O-RING 90.00X2.5 NBR70              | 1   | 09-819B      | 09-47551-121 |              |              |
| 8                | 0.0503.027  | WOODRUFF KEY 3X5X13 ST DIN 6888     | 1   |              |              | 09-47552-129 |              |
| 9                | 0.2172.573  | O-RING 23.4X3.53 BS1806 NBR70       | 1   |              | 09-47551-121 |              |              |
| 10               | 01-46284-4  | SPACER F8B-9                        | 1   |              |              | 09-47552-129 |              |
| 11               | 0.0138.134  | TAP BOLT M6X12 DIN933 A2            | 5   |              |              |              | 09-47553-107 |
| 12               | 01-46794-02 | SCREW 1/4"-20UNCX10 AL.BRONZE       | 1   |              | 09-47551-121 |              |              |
| 13               | 0.3431.525  | BALL BEARING 6305                   | 2   |              |              | 09-47552-129 |              |
| 14               | 0.2247.008  | MECH. SEAL COMPL FA25.47.14         | 1   |              | 09-47551-121 |              |              |
| 15               | 0.2234.010  | LIP SEAL 25X40X7 DIN3760            | 1   |              |              | 09-47552-129 |              |
| 16               | 0.0370.525  | EXT. CIRCLIP D25 DIN471 BRONZE      | 1   |              | 09-47551-121 |              |              |
| 17               | 0.0371.062  | RETAIN. RING BORE D62 DIN472 SPRST  | 1   |              |              | 09-47552-129 |              |
| 18               | 08-819B     | IMPELLER F8 NEOPRENE                | 1   | 09-819B      |              |              |              |
| 19               | 0.0370.025  | RETAIN. RING SHAFT D25 DIN471 SPRST | 2   |              |              | 09-47552-129 |              |

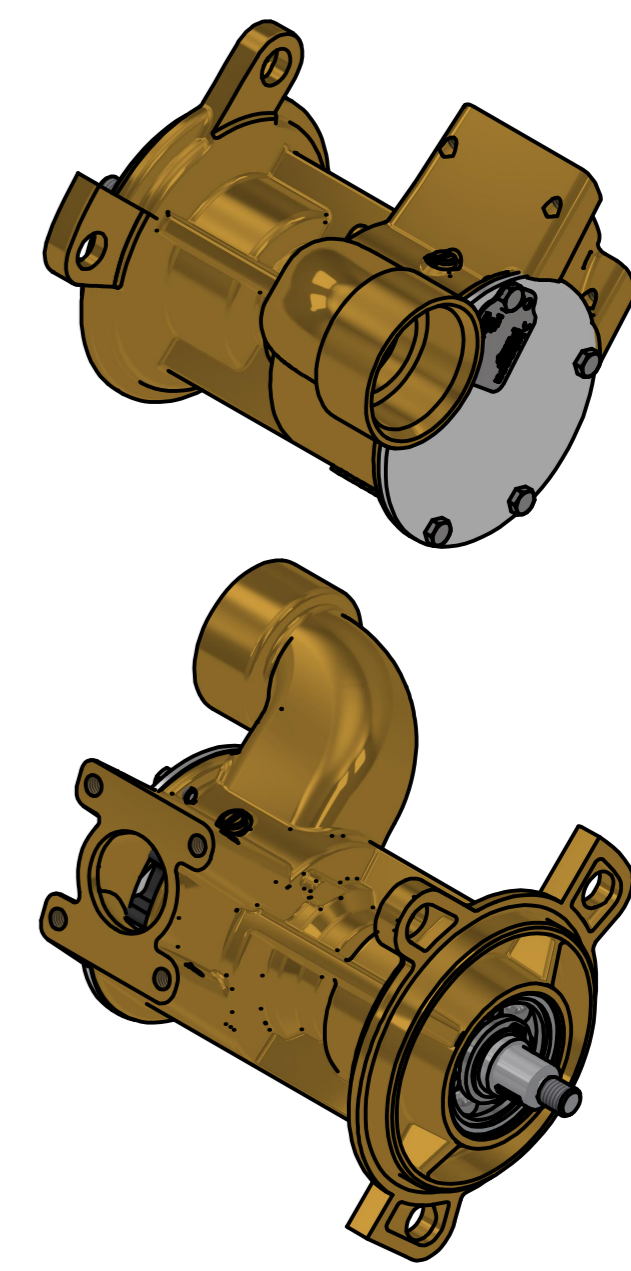
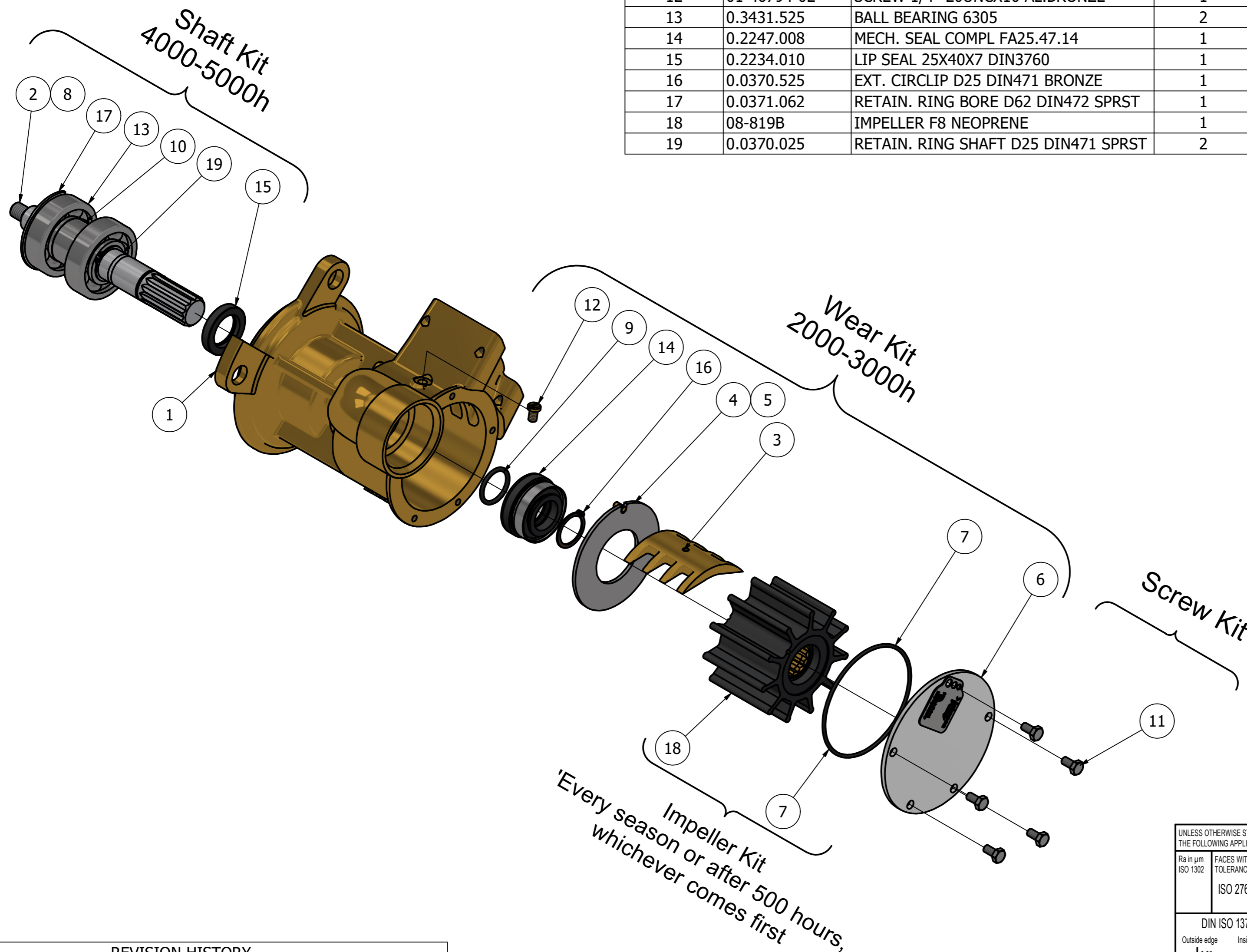

ISO VIEW

| REVISION HISTORY |     |                 |      |      |
|------------------|-----|-----------------|------|------|
| ECN              | REV | ECN DESCRIPTION | DATE | SIGN |
|                  | P01 |                 |      |      |

|  |  |                     |             |  |                           |
|--|--|---------------------|-------------|--|---------------------------|
| UNLESS OTHERWISE STATED THE FOLLOWING APPLIES: |  | NAME                | DATE        | The component or product design and specified according to this drawing must comply with applicable EHS laws and EU-directives |                           |
| Ra in µm                                       | FACES WITHOUT TOLERANCES ACC. TO ISO 2768 - mK | M.G.                | 24-Oct-2024 | MASTER   | STATUS WorkInProgress     |
| ISO 1302                                       |  | M.G.                |             |  | PROJECTION METHOD ISO 128 |
|  |  |                     |             | WEIGHT 7.7 kg  | TYPE F8B-9                |
|  |  |                     |             |  | SCALE 1:2.5               |
| DIN ISO 13715                                  |  | PROJECT NUMBER 2652 |             | DESCRIPTION EXPLODED VIEW OF F8B-9 IMPELLER PUMP   |                           |
| Outside edge                                   | Inside edge                                    | SPXFLOW             |             | DRAWING NUMBER 10-13263-11   |                           |
| ±0.25  | ±0.5   | Johnson Pump        |             | REVISION P01   |                           |

This Drawing/Document and information shown contains proprietary information of SPX FLOW and must not without permission and written consent be reproduced, copied, transmitted, transferred, disclosed, undue use, shown or handed out to any unauthorized person and is to be maintained in confidence.