

CUSTOMER DETAILS	
OEM PUMP PART NO	51.06500-7034
MANUFACTURER	MAN TRUCK & BUS
ENGINE	D2866LE401, 402, 403, 405
PUMP DESCRIPTION	F75B/F7B-9 IMPELLER PUMP OEM (MAN)

DRAWING POSITION	COMPONENTS	COMPONENT DESCRIPTION	PART LIST				
			QTY	IMPELLER KIT	WEAR KIT	SHAFT KIT	SCREW KIT
1	01-13123-1	PUMP BODY F75B-9	1				
2	01-46146	CAM 1/1 F75B	1		X		
3	08-821BT-1	IMPELLER F75 MC 97 THREAD	1	09-821BT-1			
4	01-35702	SHAFT F75B/F7B-	1			X	
5	01-46361	WASHER F75B/F7B-9	1		X		
6	01-46286-3	GASKET F75B	1	09-821BT-1	X		
7	01-47725	WEAR PLATE F7B/F70B	2		X		
8	01-42400	PIN F35B-/F7B/F70B	1		X		
9	01-24439-1	BEARING HOUSING F75B/F7B-9	1				
10	01-46284-2	SPACER F75B-9	1			X	
11	01-42427-15	SLINGER F8/F9B-	1			X	
12	0.0370.525	EXT. CIRCLIP D25 DIN471 BRONZE	2		X	X	
13	0.0371.062	RETAIN. RING BORE D62 DIN472 SPRST	1			X	
14	01-46790-02	WASHER D8.2XD14X1 CU	1		X		
15	0.2247.008	MECH. SEAL COMPL FA25.47.14	1		X		
16	0.2233.352	LIP SEAL 25X47X7 BAUM3X7 VITON	1			X	
17	0.3431.001	BALL BEARING 6205 2 RS C3 ST	1			X	
18	0.3431.044	BALL BEARING 6305-2RS1 C3 ST	1			X	
19	0.0138.921	TAP BOLT M5X16 M DIN933 A4	4		X		
20	01-46794-12	SCREW M8X12 AL.BRONZE	1		X		
21	0.0141.918	TAP BOLT M8X25 DIN933 8.8ZP	4			X	
22	0.0353.309	SPRING WASHER D8.1 DIN127B STZN	4			X	
23	01-24437-1	PUMP BODY F75B/F7B-9	1				
24	01-42679	CAM 1/1 F7B/F70B	1		X		
25	08-1028BT-01	IMPELLER F7 MC 97 THREAD	1	09-1028BT-1			
26	01-46794-01	SCREW 12-24UNCX9.5 BRASS	1		X		
27	01-46362	GASKET F75B/F7B-9	1	09-1028BT-1	X		
28	01-46291	GASKET F75B-9	1		X	X	

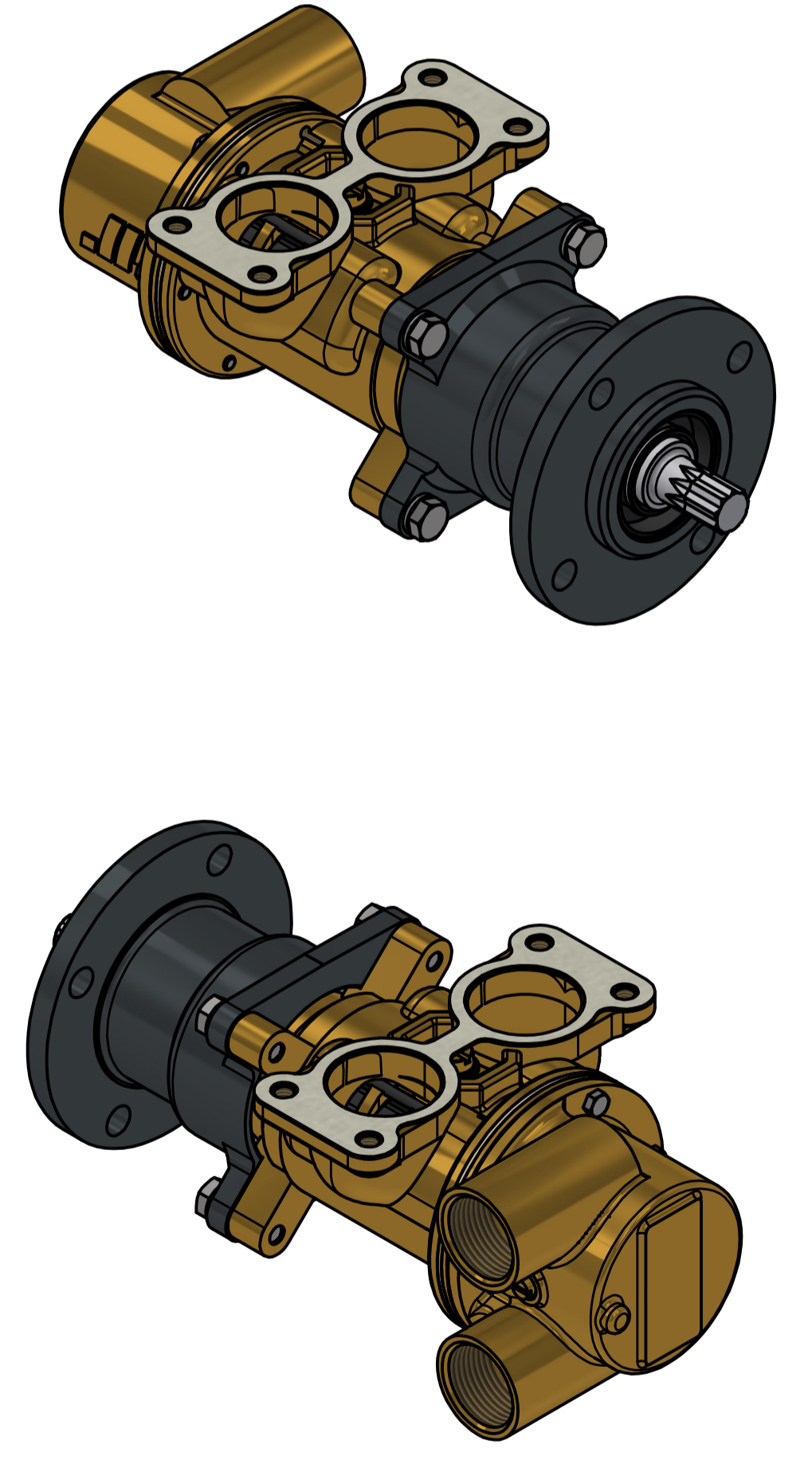
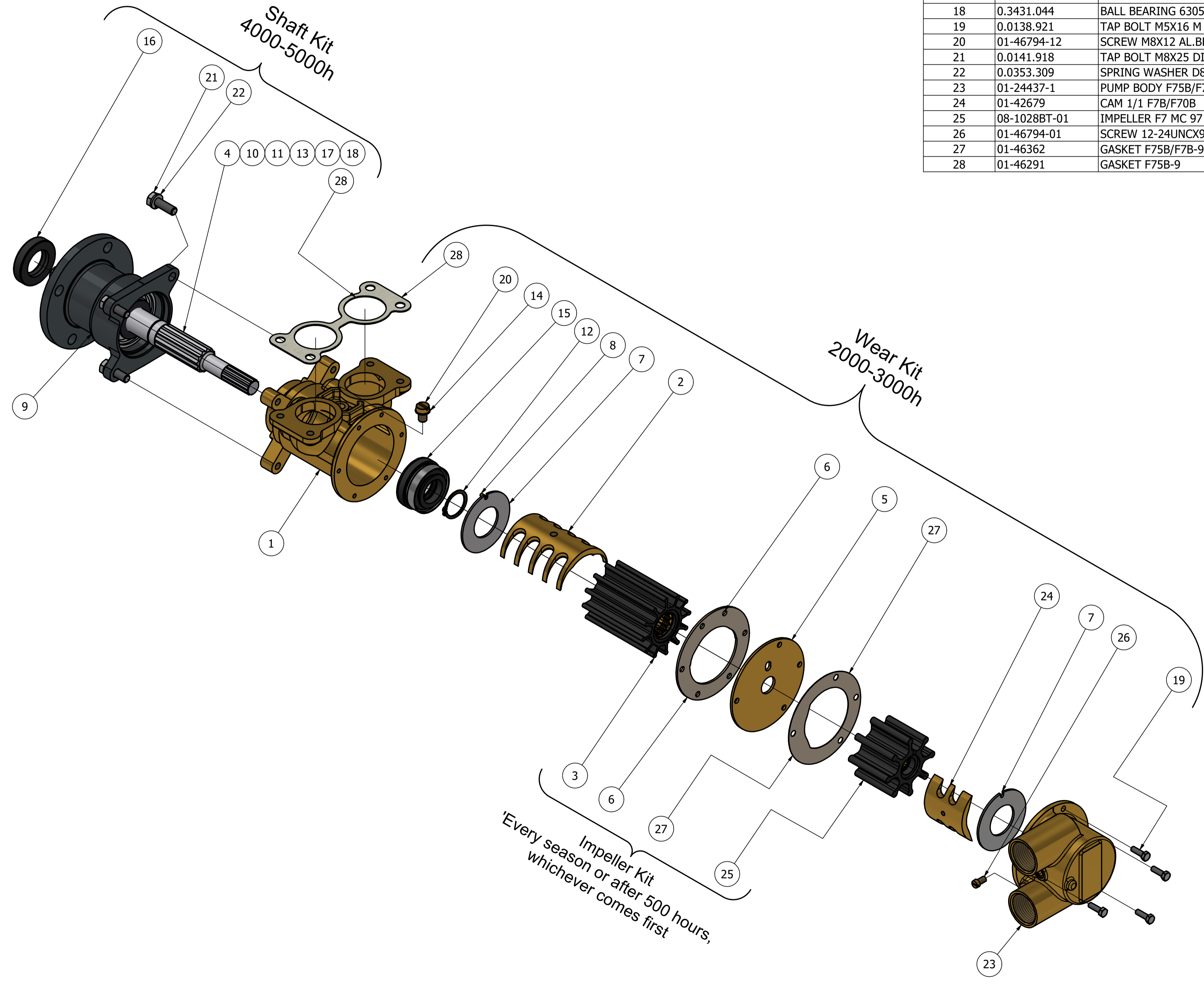

ISO VIEW

This Drawing/Document and information shown contains proprietary information of SPX FLOW and must not without permission and written consent be reproduced, copied, transmitted, transferred, disclosed, used, shown or handed out to any unauthorized person and is to be maintained in confidence.

REVISION HISTORY				
ECN	REV	ECN DESCRIPTION	DATE	SIGN
	P01			M.G

UNLESS OTHERWISE STATED THE FOLLOWING APPLIES:		NAME	DATE	The component or product design and specified according to this drawing must comply with applicable EHS laws and EU-directives	
PROJ. NO.	ISO 1312	DESIGN	M.G	12-Mar-2025	
		REVIEWED			
		APPROVED	M.G		
ISO 2768 - mK		MATERIAL	REPORT	N/A	
DIN ISO 13715		PROJECT NUMBER	2652	DESCRIPTION	
Outside edge	Inside edge	SPXFLOW Johnson Pump		EXPLODED VIEW OF F75B/F7B-9 IMPELLER PUMP	
0.25	0.5	DRAWING NUMBER		10-13142-01	
					REVISION P01