

CUSTOMER DETAILS

OEM PUMP PART NO	2047400
MANUFACTURER	MTU
ENGINE	6R 099 TE61, 91, 51
PUMP DESCRIPTION	F8B-9 IMPELLER PUMP OEM

PART LIST

DRAWING POSITION	COMPONENTS	COMPONENT DESCRIPTION	QTY	IMPELLER KIT	WEAR KIT	SHAFT KIT	SCREW KIT
1	01-13002-1	PUMP BODY F8B-	1				
2	01-47771-1	END COVER F8B/F9B-	1		X		
3	01-42680	CAM 1/1 F8B	1		X		
4	01-35294	SHAFT F8B-9	1			X	
5	08-819B	IMPELLER F8 NEOPRENE	1	09-819B			
6	01-46538	WEAR PLATE F8/F9/F95 SS	1		X		
7	01-42426	PIN	1		X		
8	01-42424-3	GASKET F8B/F9B-	1	09-819B	X		
9	01-46794-02	SCREW 1/4"-20UNCX10 AL.BRONZE	1		X		
10	0.0144.003	BOLT 1/4"-20UNCX1/2" SS1943	5				09-47553-108
11	01-42427-15	SLINGER F8/F9B-	1			X	
12	0.3431.746	BALL BEARING 6206 2RS1 ST	1			X	
13	0.3431.001	BALL BEARING 6205-2RS C3 ST	1			X	
14	01-24324	BEARING HOUSING F8B-9	1			X	
15	0.0144.002	BOLT 5/16"-18UNCX20 SS1943	4			X	
16	0.0352.609	ELASTIC WASHER D8.4XD15X0.8	4			X	
17	0.0371.062	RETAIN. RING BORE D62 DIN472 SPRST	1			X	
18	0.0371.052	RETAIN. RING BORE D52 DIN472 SPRST	1			X	
19	0.0370.525	EXT. CIRCLIP D25 DIN471 BRONZE	2		X		
20	0.2247.051	MECH. SEAL COMPL 1" 106BT2C1	1		X		
21	01-47826-2	MARKING TAG	1				

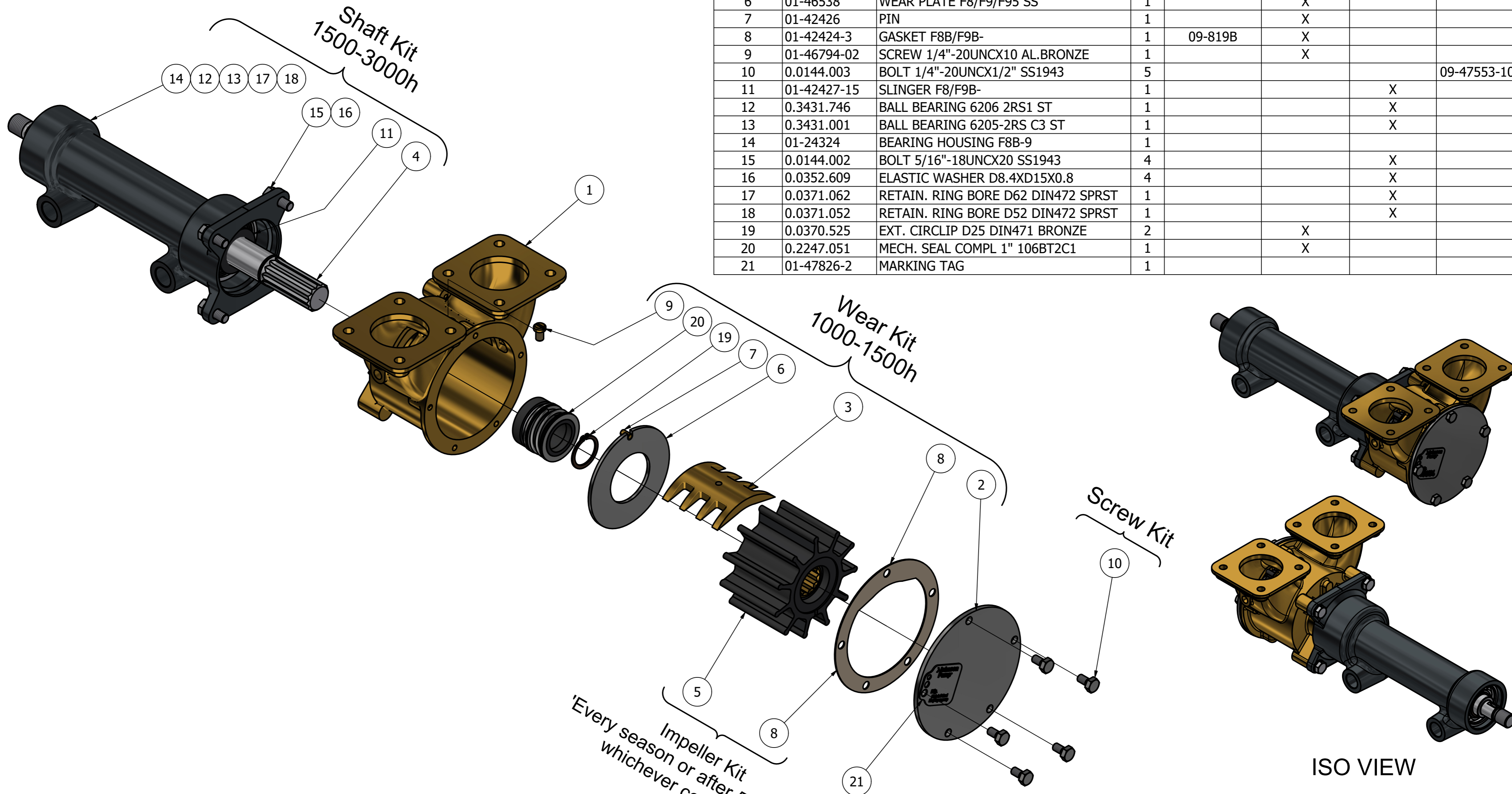

ISO VIEW

Every season or after 500 hours, whichever comes first

This Drawing/Document and information shown contains proprietary information of SPX FLOW and must not without permission and written consent be reproduced, copied, transmitted, transferred, disclosed, undue use, shown or handed out to any unauthorized person and is to be maintained in confidence.

REVISION HISTORY

ECN	REV	ECN DESCRIPTION	DATE	SIGN
	P01		04-Feb-2025	N.T.

UNLESS OTHERWISE STATED THE FOLLOWING APPLIES:		NAME	DATE	The component or product design and specified according to this drawing must comply with applicable EHS laws and EU-directives	
Ra in µm ISO 1302	FACES WITHOUT TOLERANCES ACC. TO ISO 2768 - mK	DRAWN	N.T.	2025-02-01	
		REVISOR		MASTER	STATUS WorkInProgress
		APPROVED	N.T.		PROJECTION METHOD ISO 128
		MATERIAL		WEIGHT 8,2 kg	TYPE F8B-9
					SCALE 1:3
DIN ISO 13715 Outside edge ± 0.25 Inside edge ± 0.5		PROJECT NUMBER 2652	DESCRIPTION EXPLODED VIEW OF F8B-9 IMPELLER PUMP OEM		
SPXFLOW Johnson Pump		DRAWING NUMBER 10-13088-01		REVISION P01	