

Jabscopumps

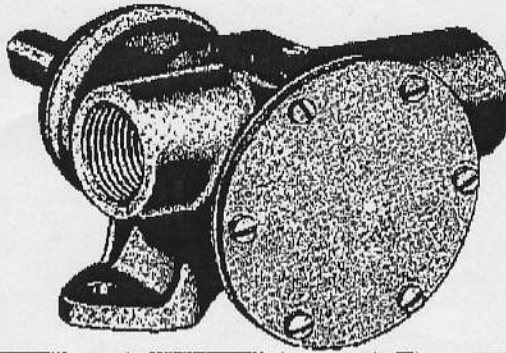

Model 6420-200



"OBSOLETE"

DESIGN FEATURES

- Body: Bronze construction
- Impeller: Jabscop neoprene composite
- Shaft: Stainless steel
- Shaft Seal: Lip type
- Wearplate: Replaceable
- Bearings: Sealed ball bearings
- Ports: 1 BSP
- Weight: Approximately 3kg

Variations incorporated from unit described above

- Model 6420-204: Fitted 2/3rds cam, reduced flow
- 6420-205: Fitted 1/2 cam reduced flow
- 6420-237: As standard pump but fitted with Nitrite impeller. For use with a wide range of oils including soluble, lubricating, and machine cutting. Not recommended for Toluene, Petrol, Benzene or other high fraction petroleum products.

Note: capacitor type motor recommended

Typical Applications

- Industrial**
circulating and transferring liquids
velocity-mixing
transferring soap, liquors, pastes, glues, glycerine, lotions and brine
- Marine**
engine cooling
washing down decks and docks
- Farm**
pumping water for stock and poultry houses and booster pumping
- Plumbing and home emergency use**
pumping out flooded basements, pumps and many other uses

NOTE: THIS IS THE ONLY 6420-SERIES PUMP I HAVE DOUBLE CHECK YOUR PARTS LIST FOR THE CURRENT PART #'S.

50 75

PERFORMANCE CHART

	TOTAL HEAD m H ₂ O	500 RPM		1000 RPM		1500 RPM		2000 RPM		2500 RPM		3000 RPM	
		l/min	kW	l/min	kW	l/min	kW	l/min	kW	l/min	kW	l/min	kW
Model 6420-200	2.5	27	0.18	58	0.25	83	0.37	109	0.55	137	0.75	-	-
-207	5	26	0.18	53	0.25	80	0.37	106	0.55	130	0.75	-	-
-237	10	20	0.18	47	0.37	73	0.55	95	0.75	120	0.75	-	-
Full Cam	15	12	0.18	38	0.37	63	0.55	84	0.75	108	1.1	-	-
	20	-	-	25	0.55	49	0.55	70	1.1	92	1.1	-	-
	25	-	-	-	-	-	-	55	1.1	76	1.1	-	-
Model 6420-206	2.5	14	0.18	28	0.18	43	0.25	67	0.37	71	0.37	86	0.55
Half Cam	5	12	0.18	25	0.18	40	0.25	54	0.37	67	0.55	83	0.55
	10	-	-	18	0.18	33	0.37	47	0.37	60	0.55	75	0.75
	15	-	-	-	-	24	0.37	38	0.55	52	0.55	66	0.75
	20	-	-	-	-	-	-	-	-	41	0.75	54	1.1
Model 6420-204	2.5	19	0.18	40	0.25	61	0.37	82	0.55	102	0.75	118	0.75
Two Thirds Cam	5	17	0.18	36	0.25	58	0.37	79	0.55	99	0.75	114	0.75
	10	10	0.18	32	0.25	52	0.37	73	0.55	92	0.75	107	1.1
	15	-	-	29	0.37	44	0.55	64	0.75	83	1.1	97	1.1
	20	-	-	-	-	32	0.55	52	0.75	70	1.1	84	1.5
	25	-	-	-	-	-	-	-	-	53	1.1	63	1.5

Performance stated on above tables is typical for a new pump fitted with a standard Jabscop neoprene impeller pumping water at ambient temperature. It should be noted that pump performance and head can vary ± 15%.

Exploded View and Parts List

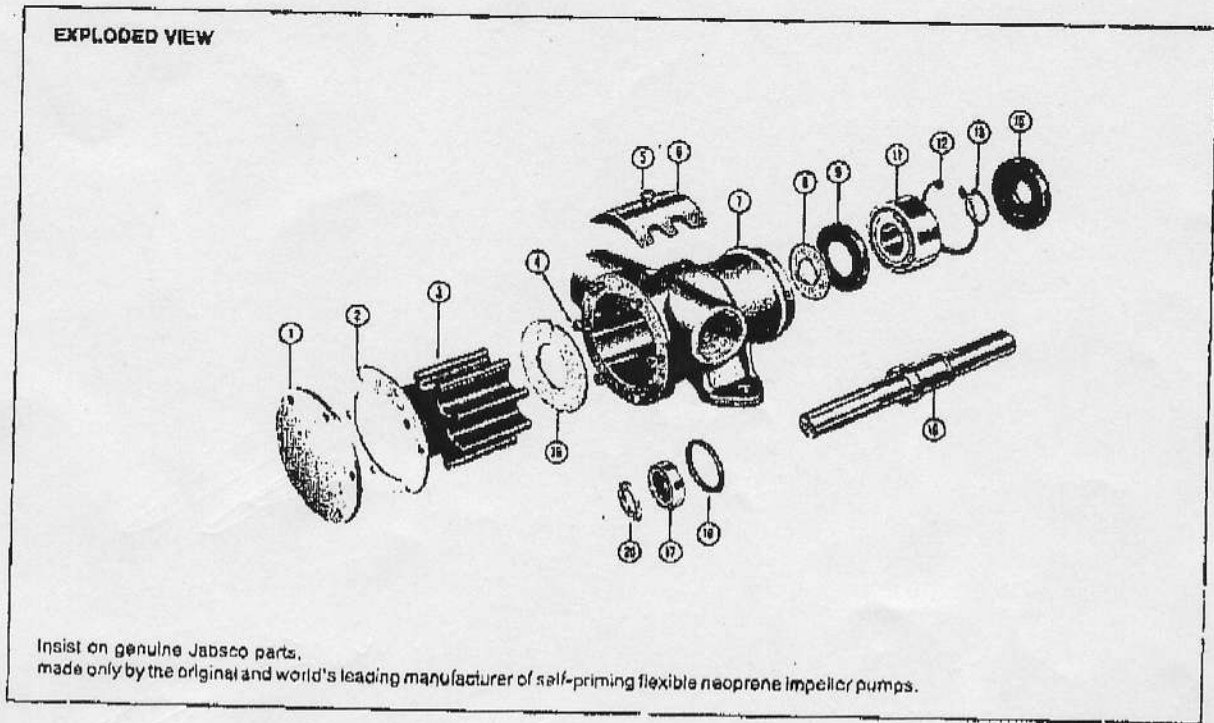

PARTS LIST			
Key	Description	Qty	Part No.
1	End Cover Models 6420-200, -204, 205-237	1	6425-200, -204, -205, -237
2	Gasket Models 6420-200, -237	1	880
	Models 6420-204	1	3101
	Model 6420-205	1	2432
3	Impeller Models 6420-200, -204, -205	1	17937-0001 5915-0001
	Model 6420-237	1	17937-0002 5915-0003
4	End Cover Screws Models 6420-200, -204, -205, -237	6	SP1003-09
5	Cam Screw Models 6420-200, -237	1	SP1004-08
	Models 6420-204, -205	1	SP1004-10
6	Cam Models 6420-200, -237	1	934
	Model 6420-205	1	2431
	Model 6420-204	1	3255
7	Body	1	6424-200
8	Slinger	1	3160
9	Inner Bearing Seal	1	SP2700-48
11	Ball Bearing	1	SP2800-08
12	Retaining Ring	1	SP1701-185
13	Retaining Ring	1	SP1700-247
15	Outer Bearing Seal	1	SP2700-47
16	Shaft	1	8718-21
17	Seal	1	SP2701-21
18	'O' Ring	1	SP2000-21
19	Wearplate	1	4158
20	Seal Spacer	1	3168

SERVICE KITS	
Pump model number	Service kit number
6420-200	SK236
6420-204	SK236-21
6420-205	SK236-01
6420-237	SK236-37

Service kit includes:
Impeller
Seal
'O' Ring
End Cover Screws
Gasket

*6420-212 USES HI-PRESSURE
IMPELLER #5915-0001*

Technical Data

