

## PAR® GALLEY PUMP, SWING SPOUT STYLE

34265-0020 Straight Intake, 10½" Length Below Counter

34265-0030 Straight Intake, 8" Length Below Counter

34270-0020 Angled Intake, 9¾" Length Below Counter

34270-0030 Angled Intake, 7¼" Length Below Counter

### INSTALLATION INSTRUCTIONS

1. Drill a 7/8" hole in desired location on counter.
2. Insert threaded section of BODY through drilled hole and fasten with WASHER and LOCKNUT.
3. On pump assembly, place TAILNUT (tapped end facing away from cylinder), then TAILNUT GASKET over PISTON SHAFT and onto end of CYLINDER. Push Gasket inside TAILNUT, using finger.
4. From underneath counter, insert PISTON SHAFT, and top end of CYLINDER inside BODY. Finger tighten tailnut onto body.
5. Push cylinder up and hold firmly against tailnut while tightening of tailnut is completed.
6. At top of faucet, slide GASKET, then PACKING ASSEMBLY over piston shaft. Be careful not to damage O-RING (inside packing assembly). Tighten into place using SPANNER WRENCH provided.
7. Screw knob HANDLE onto piston shaft.
8. Connect INTAKE SPOUT to water supply with flexible tubing. Be careful that pump is not pushed out of line or binding of the PISTON SHAFT may occur.

### SERVICE INSTRUCTIONS

1. Remove knob handle.
2. Loosen tailnut and slide pump free from faucet.
3. Remove bottom cap assembly by sliding brass ring on cylinder and forcing cap from cylinder.
4. Remove check valve and clean all foreign matter from between valve and valve cage.
5. Remove piston assembly from cylinder and clean piston cup and seat. Wipe inside of cylinder.
6. Reassemble pump making certain all parts are resealed correctly.

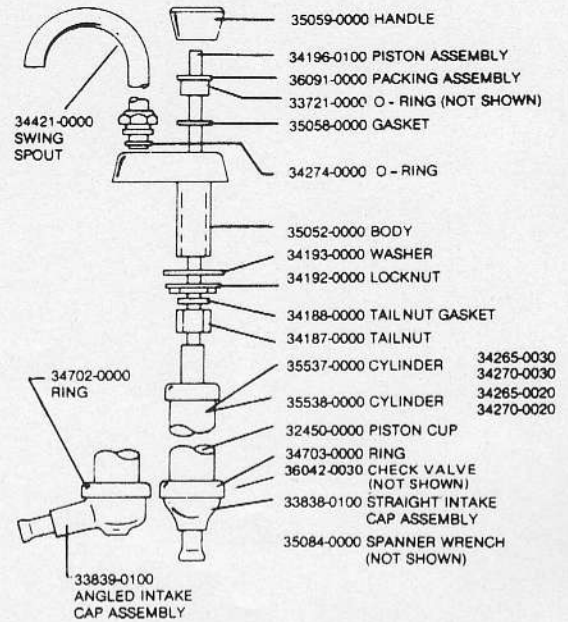

THE PRODUCTS DESCRIBED HEREIN ARE SUBJECT TO THE JABSCO® ONE YEAR LIMITED WARRANTY, WHICH IS AVAILABLE FOR YOUR INSPECTION UPON REQUEST.

**ITT JABSCO**

A Unit of ITT Corporation  
1485 Dale Way, P.O. Box 2158  
Costa Mesa, CA 92628-2158  
Telephone: (714) 545-8251