

PARTS LIST

KEY	DESCRIPTION	1673 9001 Fastener PART NUMBER	1673 9001 Lip Seal PART NUMBER	QTY.
1	Fast Cover	11835 0000	11835 0000	1
2	Gasket	1835 0000	1835 0000	1
3	Impeller Neoprene Nitrile	1210 0001 1210 0003 1210 0003	1210 0001 1210 0003 1210 0003	1
4	Screw (Cam)	9094 0000	9094 0000	1
5	Seal (Cam)	91003 0010	91003 0010	1
6	O-Ring	488 0002 488 0002 488 0002	488 0002 488 0002 488 0002	1
7	Screw (End Cover)	92000 0430 92000 0430 92000 0430	92000 0430 92000 0430 92000 0430	6
8	Cam	2907 0000	2907 0000	1
9	Screw (Cam)	91002 0090	91002 0090	1
10	Body	2438 0000	2438 0000	1
11	Bearing Shield	3078 0000	3078 0000	1
12	Ball Bearing	92680 0330	92680 0330	1
13	Rotating Shield	1161 0000	1161 0000	1
14	Stationary Slinger	1554 0000	1554 0000	1
15	Bearing Housing	345 0000	345 0000	1
16	Shaft	11847 0000	11847 0000	1
17	Service Kit, Neoprene	688 0240	688 0240	1
18	Service Kit, Nitrile	90020 0001 90020 0001 90020 0001	90015 0001 90015 0001 90015 0001	1

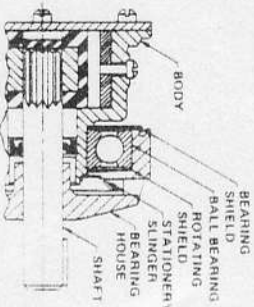

Cross Section
to show relative
position of bearing
and slinger parts

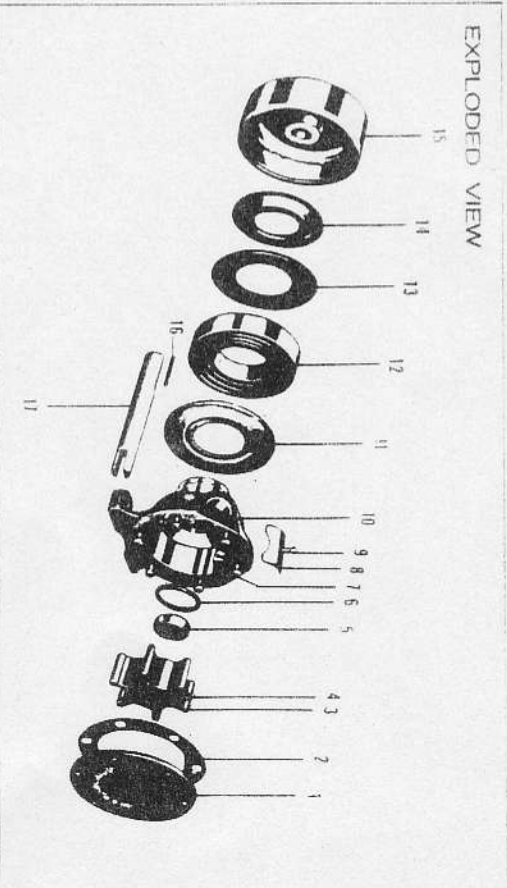

Model 2620-0003 & Variations

KEY	DESCRIPTION	PART NUMBER	QTY. REQ.
1	End Cover	11830 0000	1
2	Gasket	2995 0000	1
3	Impeller Neoprene Nitrile	673 0001 673 0003	1
4	Screw (Impeller)	91010 0060	1
5	Seal (Shaft)	92700 0050	1
6	O-Ring	92000 0430	1
7	Screw (End Cover)	91002 0070	6
8	Cam	2907 0000	1
9	Screw (Cam)	91002 0090	1
10	Body	2438 0000	1
11	Bearing Shield	3078 0000	1
12	Ball Bearing	92680 0330	1
13	Rotating Shield	1161 0000	1
14	Stationary Slinger	1554 0000	1
15	Bearing Housing	345 0000	1
16	Key (Shaft Drive)	11847 0000	1
17	Shaft	688 0240	1
Not Shown	Service Kit, Neoprene	90020 0001	1
	Service Kit, Nitrile	90020 0001	1

*Parts supplied in Service Kit