

EZ SERIES ELECTRONIC METERING PUMPS

**Sophisticated
Yet
Simple**

The EZ Series electronic metering pump offers precise chemical injection at a low cost. Manual or on/off control for simple addition applications. Sophisticated engineering to provide effective, reliable performance.

Superior Priming

The EZ metering pump easily self primes 100 cps viscosity solutions with a 5 ft suction lift.

Compact Size

Ideal for OEM specifications, EZ pumps are small, quiet, and lightweight.

Optional Automatic Air Vent Valve (pat. pend.)

Maximizes safety in working with liquids that gas easily.

Long Lasting Diaphragm

PTFE laminate over EPDM is molded onto a solid core. A retainer plate is provided to minimize flow rate changes as pressure varies.

High Speed Operation

Up to 360 strokes per minute results in high resolution chemical feed, elimination of slug-feed effects.

Double Ball Check Valves

The ball, seat and guide assembly ensures a tight seal to prevent loss of prime.

Wide Selection of Materials

EZ pumps fit all typical applications for metering pumps. (See liquid end chart, reverse side.)

Modular Components

The liquid end, drive and electronics are modular, enabling economical repair or replacement of parts. Remote mounting cable is available separately. Consult factory.

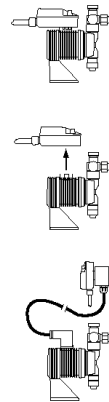

IWAKI WALCHEM CORPORATION
A Walchem Company

2 year warranty
includes welded parts



1
2
3
4
5
6

EZ
B15
N
1
-
VE
A

1 Pump Series
EZ Electronic metering pump with manual speed control
 (adjustable to 360 strokes per minute)

2 Capacity/Pressure Rating

Size	Maximum Output Capacity		Maximum Output per stroke (mL)	Maximum Pressure		Connection Size (in) Tubing O.D.
	(GPH)	(mL/min)		PSI	MPa	
B10*	0.6	38	0.11	150	1.0	3/8
B15*	1.0	65	0.18	105	0.7	3/8
B20*	1.5	95	0.26	60	0.4	3/8
B30	3.2	200	0.56	30	0.2	1/2

* PVC and GFRPP heads come standard with manual air vent valve

3 Control Module
N None - fixed stroke length only

4 Voltage
1 115 VAC, 50/60 Hz
2 230 VAC, 50/60 Hz

5 Liquid End

Liquid End Code	Pump Head & Fittings	Diaphragm	Valve Balls	Valve Seat	Valve Seals	Gasket	Tubing
FC	PVDF	PTFE (Bonded to EPDM)	CE	PCTFE	PTFE	PTFE	PE
PC	GFRPP			FKM	FKM		
PE	GFRPP			EPDM	EPDM		
VC	PVC			FKM	FKM		
VE	PVC			EPDM	EPDM		

(See materials code, right)

Standard Materials of Construction

CE	Alumina ceramic
EPDM	Ethylene propylene diene monomer
FKM	Fluoroelastomer
GFRPP	Glass fiber reinforced polypropylene
PCTFE	Polychlorotrifluoroethylene
PE	Polyethylene
PTFE	Polytetrafluoroethylene
PVC	Polyvinylchloride (translucent)
PVDF	Polyvinylidene fluoride

6 Feature
Blank No feature supplied
A Automatic air vent valve installed, available on PVC material, B10, B15* models only
 * limited to 60 psi

Other Specifications

Electrical 50/60 Hz, single phase
 115 VAC ± 10% 0.9 Amp max. 16 watt avg.
 230 VAC ± 10% 0.3 Amp max. 16 watt avg.

Operating Conditions
 Ambient temperature 32°F to 122°F (0°C to 50°C)

Shipping Weight (approx.) 6 lbs

Dimensions H 7.24" L 6.81" W 3.94"
 All pumps come with one foot valve, one injection valve and 20 ft of polyethylene tubing.

2 Year Limited Warranty

Our warranty covers the metering pump electronics (control unit and drive unit) and the entire liquid end, including diaphragm. Up to 2 years after delivery, we will repair or replace any properly applied pump if it fails.



IWAKI WALCHEM CORPORATION

A Walchem Company

FIVE BOYNTON ROAD • HOPPING BROOK PARK • HOLLISTON, MA 01746 USA • TEL 508-429-1110 • FAX 508-429-7433 • e-mail walchem@walchem.com

B229.B 12/98