

# MDM-1518 7.5/10 HP

- ❑ Non-contact Bearing System allows dry run operation (CF models only)
- ❑ Simple, rugged design
- ❑ Corrosion resistant ETFE & PFA internals
- ❑ Spline/pinned impeller design (pat. pending) provides positive locking of impeller/inner magnet while still allowing for individual replacement of each part
- ❑ PFA version temperatures to 302°F

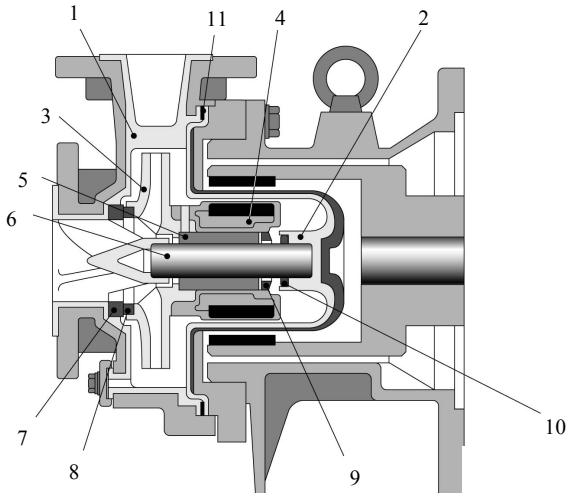

| Part                           | Material                                     |      |     |
|--------------------------------|--|------|-----|
|                                | ECF  | EKK  | PKK |
| 1 Front casing                 | CFRETFE<br>(carbon fiber reinforced<br>ETFE) |      | PFA |
| 2 Containment shell            |  |      |     |
| 3 Impeller                     |  |      |     |
| 4 Inner magnet assy            |  |      |     |
| 5 Bearing                      | High density carbon                          | SiC  |     |
| 6 Shaft                        | High purity alumina ceramic                  |      |     |
| 7 Front outboard thrust collar | PTFE   |      |     |
| 8 Front inboard thrust collar  |  |      |     |
| 9 Rear inboard thrust collar   | High purity alumina ceramic                  |      |     |
| 10 Rear outboard thrust collar | PTFE (filler charged)                        | PTFE |     |
| 11 Gasket                      | PTFE   |      |     |

**Dimensions (inches) and Specifications**  
**Note: Will vary by motor manufacturer**

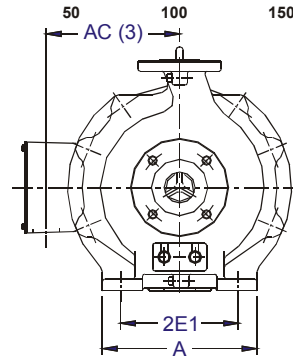
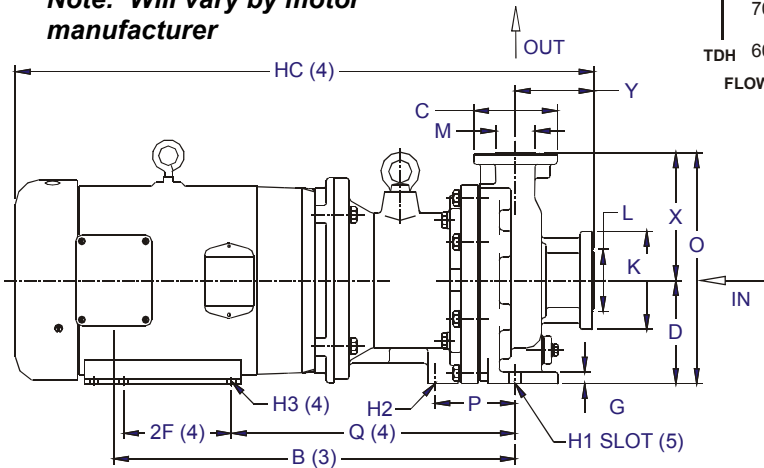
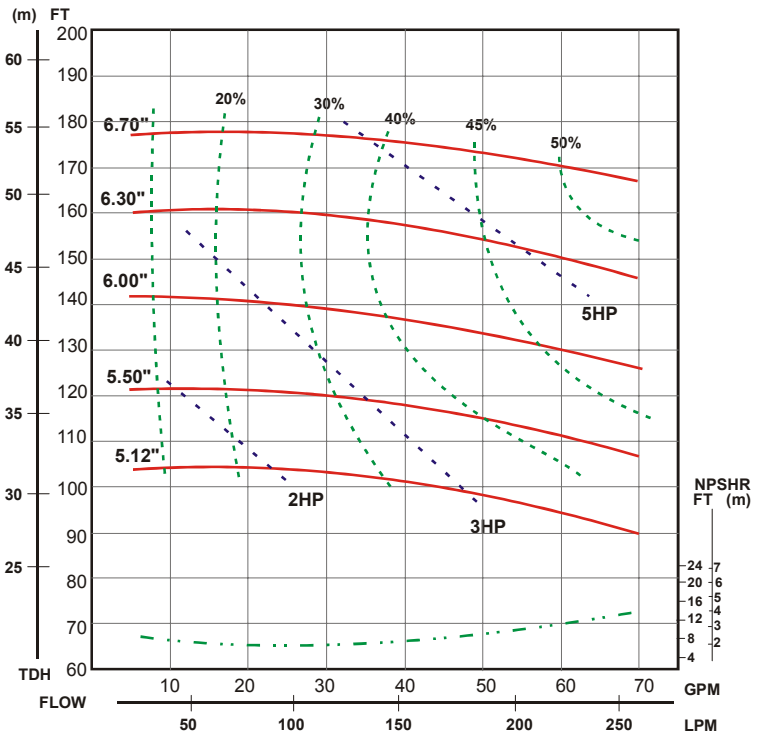

| A                    | AC(3) | B(3)             | D    | 2E1               | 2E2  | F1                | F2    | G1           | G2   | H1 (6)       | H2 (5) | H3   | HC (3) | O     | X    | Y    |
|----------------------|-------|------------------|------|-------------------|------|-------------------|-------|--------------|------|--------------|--------|------|--------|-------|------|------|
| 11.42                | 5.76  | 17.01            | 5.26 | 5.98              | 9.45 | 7.24              | 14.09 | 0.39         | 0.59 | 0.63         | 0.63   | 0.63 | 25.29  | 11.76 | 6.50 | 4.00 |
| HP/Frame             |       | Connection Sizes |      | Min Flow/Max Head |      | Standard Capacity |       | Max Capacity |      | Pump Weight* |        | K    | L      | C     | M    |      |
| 7.5/213TC & 10/215TC |       | 1.5 x 1          |      | 5/120             |      | 20                |       | 60           |      | 110          |        | 5.00 | 2.87   | 4.25  | 2.00 |      |

\* Pump end only. Does not include motor.