

# SSH REPAIR PARTS

Effective January, 2008

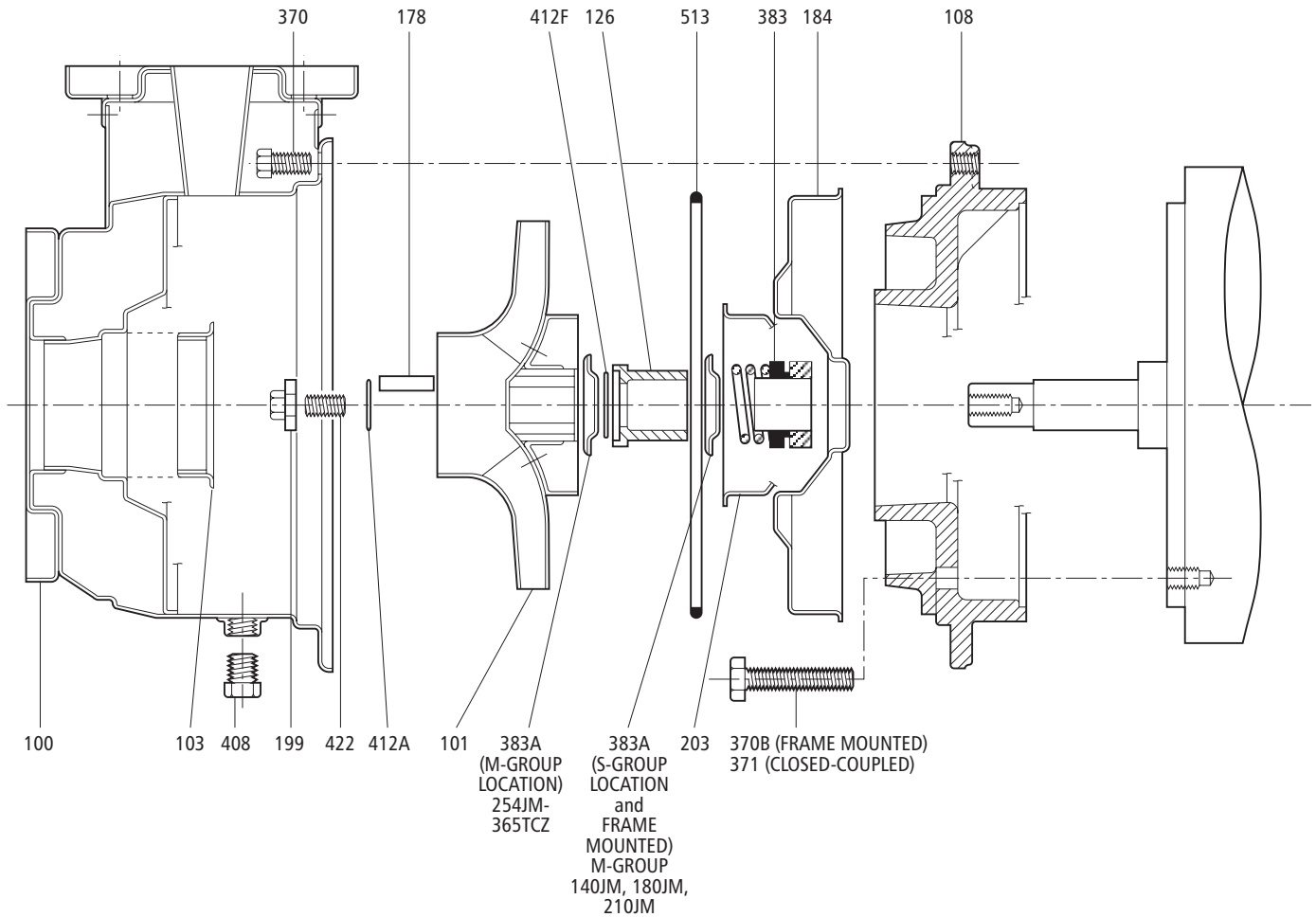

### SSH S-GROUP

Item No.	Part Description	Material	1 x 2-6		1½ x 2½-6		2 x 2½-6		2½ x 3-6		1 x 2-8		1½ x 2½-8		2 x 2½-8		1 x 2-10		Max. Wt. (lbs.)		
			①		②		4SH	5SH	6SH	①		7SH	8SH	①							
			9SH 9A-SH	9SH Before Jan. 2003	10SH 10A-SH	10SH Before Jan. 2003				11SH 11-SH	11SH Before Jan. 2003										
100	Casing with wear ring		1L450		1L453		1L456		1L459		1L451		1L454		1L457		1L452		17		
101	Impeller	AISI Type 316SS	6⅝	2L889	2L856	6¾	2L876	6⅞	2L766	7⅞	2L771	8 <sup>27</sup> / <sub>64</sub>	2L898		8¼	2L879	8¼	2L770	10 <sup>3</sup> / <sub>32</sub>	2L897	2L865
			6⅞	2L888	2L733	6⅞	2L874	6⅞	2L765	7⅞	2L772	8⅞	2L893	2L861	7 <sup>13</sup> / <sub>16</sub>	2L756	7¾	2L769	9 <sup>17</sup> / <sub>32</sub>	2L896	2L742
			5 <sup>11</sup> / <sub>16</sub>	2L887	2L853	6⅞	2L872	5 <sup>13</sup> / <sub>16</sub>	2L763	6 <sup>15</sup> / <sub>16</sub>	2L773	7 <sup>11</sup> / <sub>16</sub>	2L892	2L859	7	2L877	7½	2L768	9⅞	2L895	2L863
			5¾	2L886	2L730	5¾	2L871	5½	2L882	6 <sup>11</sup> / <sub>16</sub>	2L774	7¾	2L891	2L858	6¾	2L876	7⅞	2L767	8¾	2L894	2L862
						5⅞	2L870	5¾	2L881	6¾	2L775	7⅞	2L890	2L735	6⅞	2L875	6⅞	2L766			
						4 <sup>11</sup> / <sub>16</sub>	2L869	4 <sup>13</sup> / <sub>16</sub>	2L880	6⅞	2L776				6⅞	2L751	6⅞	2L764			
						4¾	2L868	4⅞	2L759	5¾	2L777										
			4 <sup>3</sup> / <sub>16</sub>	2L867																	
103	Wear ring, casing		4L465		4L466		4L467		4L468		4L465		4L466		4L467		4L465		1		
184	Seal housing with ring		1L465				1L469		1L472		1L466				1L470		1L467		3		
203	Wear ring, seal housing		4L201				4L464		4L201												
126	Shaft sleeve	316SS	4L473		4L456				4L473		4L456				4L473		4L456		1		
178	Key, impeller	Steel					4K11		4K555		4K11				4K555		4K11				
422	Stud, impeller		13K217																		
199	Washer, impeller	316SS	4L458																		
108	Motor adapter, 143-184JM and S-group brg. frame	Cast iron ASTM A48	1L554		1L50				1L99		1L560		1L52		1L99		1L562		1L97		25
	Motor adapter, 213-256JM	cl. 20	1L555		1L51				1L98		1L561		1L53		1L98		1L563		1L96		29
370	Bolt, casing	300SS	13L38 (8 req.)				13L89		13L38 (8 req.)				13L89 (8 req.)				-				
371 or 370B	Bolt, adapter, 143-184JM and S-Group brg. frame	Steel SAE 1200	13K360		13L43				13L43		13K360		13L43		13L43		13K360		13L43		25
	Bolt, adapter, 213-256JM		13K379		13L41				13K245		13K361		13L40		13K245		13K361		13L40		29
383	Mech. seal - standard	Type 21	10K27 - carbon/silicon-carbide/viton																		
	Mech. seal - high temp.		10K19 - Carbon/silicon-carbide/EPR																		
	Mech. seal - severe duty		10K64 - Silicon-carbide/silicon-carbide/viton																		
383A	Retainer, seal spring	316SS	4K517																		
408	Plug, vent and drain	316SS	6L60																		
412A	O-ring, impeller washer	Viton	5K320 standard (5K195 EPR option)																		
412F	O-ring, shaft sleeve	Viton	5K307 standard (5K306 EPR option)																		
513	O-ring, casing - standard	Viton	5K407				5L70		5K408				5L70		5L71		1				
	O-ring, casing - optional	EPR	5K393				5K317		5K394				5K317		5L110						

① 9SH, 10SH and the 11SH units were obsoleted in January 2003 and replaced by the 9ASH, 10ASH and 11ASH units.

② New numbering system on September of 2006 dropped the "A". There was no mechanical change.

### SSH M-GROUP (254JM-365TCZ)

Item No.	Part Description	Material	1½ x 2½-10 24SH	2 x 2½-10 25SH	2½ x 3-8 22SH	2½ x 3-10 27SH	3 x 4-8 23SH	3 x 4-10 28SH	Max. Wt. (lbs.)						
100	Casing, with wear ring	AISI Type 316L SS	1L455		1L458		1L460		1L461		1L463		1L464		17
101	Impeller		9⅞	2L778	9⅞	2L790	9⅞	2L808	10⅜	2L804	9⅞	2L825	10⅞	2L836	8
			9½	2L779	9½	2L791	8¾	2L809	9¹⁵⁄₁₆	2L805	8¹¹⁄₁₆	2L826	10¼	2L837	
			9⅞	2L780	9⅞	2L792	8½	2L810	9⅞	2L806	8⅞	2L827	9¹³⁄₁₆	2L838	
			8⅞	2L781	8¹³⁄₁₆	2L793	8¼	2L811	9¼	2L807	8⅞	2L828	9⅞	2L839	
			8⅞	2L782	8³⁄₁₆	2L794	7⅞	2L812	8¾	2L809	7¹¹⁄₁₆	2L829	9⅞	2L825	
			8¼	2L783	7¹⁵⁄₁₆	2L795	7½	2L813			7½	2L830	8¹¹⁄₁₆	2L826	
					7¹¹⁄₁₆	2L796	7⅞	2L814			7⅞	2L831			
							6¹¹⁄₁₆	2L815			6⅞	2L832			
							6½	2L816			6½	2L833			
											6	2L834			
									5½	2L835					
103	Wear ring, casing			4L467			4L468			4L469			1		
184	Seal housing, with ring		1L468			1L473	1L475	1L477	1L478	3					
203	Wear ring, seal housing		4L201			4L464						1			
126	Shaft sleeve	316 SS	4L457												
178	Key, impeller	Steel	4K261												
422	Stud, impeller		13K301												
199	Washer, impeller	316 SS	4L463												
108	Motor adapter, 254-256JM and M-Group bearing frame	Cast iron ASTM A48 cl. 20	1L91		1L89		1L93		1L94		31				
	Motor adapter, 280JM-365TCZ		1L90		1L88		1L92		1L95		44				
370	Bolt, casing	300 SS	13L86 (6 req'd)		13L89 (8 req'd)		13L86 (8 req'd)		13K45 (8 req'd)		-				
371 or 370B	Bolt, adapter, 254-256JM and S-Group bearing frame	Steel SAE 1200	13L88			13L116			-						
	Bolt, adapter, 280JM-365TCZ		13L87			13L115			-						
383	Mech. seal - standard	Type 21	10K45 - carbon/silicon-carbide/ viton						1						
	Mech. seal - high temp.		10K20 - Carbon/silicon-carbide/EPR												
	Mech. seal - severe duty		10K65 - Silicon-carbide/silicon-carbide/viton												
383A	Retainer, seal spring	316SS	4K500												
408	Plug, vent and drain	316SS	6L60						2						
412A	O-ring, impeller washer	Viton	5K309 standard (5K308 EPR option)						1						
412F	O-ring, shaft sleeve	Viton	5K309 standard (5K308 EPR option)												
513	O-ring, casing - standard	Viton	5L71		5L70		5L71			5L72					
	O-ring, casing - optional	EPR	5L110		5K317		5L110		5L116						

## SSH M-GROUP (140JM, 180JM & 210JM)

Item No.	Part Description	Material	1½ x 2½-10 24SH	2 x 2½-10 25SH	2½ x 3-8 22SH	2½ x 3-10 27SH	3 x 4-8 23SH	Max. Wt. (lbs.)					
100	Casing, with wear ring	AISI Type 316L SS	1L455		1L458		1L460		1L461		1L463		17
101	Impeller		9 <sup>7</sup> / <sub>8</sub>	2L784	9 <sup>7</sup> / <sub>8</sub>	2L797	9 <sup>7</sup> / <sub>8</sub>	2L820	9 <sup>5</sup> / <sub>16</sub>	2L817	9 <sup>7</sup> / <sub>8</sub>	2L840	8
			9 <sup>1</sup> / <sub>2</sub>	2L785	9 <sup>1</sup> / <sub>2</sub>	2L798	8 <sup>1</sup> / <sub>2</sub>	2L822	9 <sup>9</sup> / <sub>16</sub>	2L818	8 <sup>7</sup> / <sub>16</sub>	2L841	
			9 <sup>9</sup> / <sub>16</sub>	2L786	9 <sup>9</sup> / <sub>16</sub>	2L799	8 <sup>3</sup> / <sub>4</sub>	2L823	9 <sup>1</sup> / <sub>4</sub>	2L819	8 <sup>7</sup> / <sub>16</sub>	2L842	
			8 <sup>7</sup> / <sub>8</sub>	2L787	8 <sup>3</sup> / <sub>16</sub>	2L800	7 <sup>7</sup> / <sub>8</sub>	2L824	8 <sup>3</sup> / <sub>4</sub>	2L821	7 <sup>1</sup> / <sub>2</sub>	2L843	
			8 <sup>5</sup> / <sub>16</sub>	2L788	8 <sup>3</sup> / <sub>16</sub>	2L801	7 <sup>7</sup> / <sub>8</sub>	2L772			7 <sup>7</sup> / <sub>8</sub>	2L844	
			8 <sup>1</sup> / <sub>4</sub>	2L789	7 <sup>15</sup> / <sub>16</sub>	2L802	6 <sup>1</sup> / <sub>16</sub>	2L774			6 <sup>1</sup> / <sub>2</sub>	2L845	
					7 <sup>1</sup> / <sub>16</sub>	2L803					6	2L846	
103	Wear ring, casing			4L467			4L468			4L469			1
184	Seal housing, with ring			1L467			1L472		1L474		1L476		3
203	Wear ring, seal housing			4L201			4L464						1
126	Shaft sleeve		316SS	4K501			4L456						
178	Key, impeller	Steel	4K11										
422	Stud, impeller		13K217										
199	Washer, impeller	316 SS	4L458										
108	Motor adapter, 143-184JM and S-group bearing frame	Cast iron ASTM A48 cl.20	1L97			1L99		N/A		1L123			25
	Motor adapter, 213-256JM		1L96			1L98		1L100				29	
370	Bolt, casing	300 SS	13L86 (8 req'd)			13L89 (8 req'd)		13L86 (8 req'd)				-	
371 or 370B	Bolt, adapter, 143-184JM and S-group bearing frame	Steel SAE 1200	13L43				N/A		13L117			-	
	Bolt, adapter, 213-256JM		13K245						13K44			-	
383	Mechanical seal - standard	Type 21	10K27 - carbon/silicon-carbide/viton									1	
	Mechanical seal - high temp.		10K19 - Carbon/silicon-carbide/EPR										
	Mechanical seal - severe duty		10K64 - Silicon-carbide/silicon-carbide/viton										
383A	Retainer, seal spring	316 SS	4K517										
408	Plug, vent and drain	316 SS	6L60									2	
412A	O-ring, impeller washer	Viton	5K320 standard (5K195 EPR option)									1	
412F	O-ring, shaft sleeve	Viton	5K320 standard (5K195 EPR)			5K307 standard (5K306 EPR option)							
513	O-ring, casing - standard	Viton	5L71			5L70		5L71					
	O-ring, casing - optional	EPR	5L110			5K317		5L110					

### Xylem Inc.

2881 East Bayard Street Ext., Suite A, Seneca Falls, NY 13148

Phone: (800) 453-6777 Fax: (888) 322-5877

[www.xylem.com/brands/gouldswatertechnology](http://www.xylem.com/brands/gouldswatertechnology)

