

Operating Instructions



Sanitary Pump

Type *F 560 GS..-50/21*
F 560 GS..-54/26
F 560 S.. - 50/21
F 560 S.. - 54/26



FLUX PUMPS CORPORATION

4330 Commerce Circle
Atlanta, Georgia 30336
phone: 404-691-6010
fax: 404-691-6314
toll free: 800-FOR-FLUX
www.flux-pumps.com

Safety Instructions



- Pumps are not approved to transfer flammable liquids (Zone 0).
- Only use the pump for its intended purpose.
- Install the pump in a way which ensures that it cannot fall into the container.
- Only use the pump with a suitable hose.
- Ensure that the hose is securely fixed to the hosetail.
- Regularly check the hose and connections to ensure safe operation.
- The pump should not be immersed deeper into the liquid than the outlet connection.



- Comply with all relevant safety instructions. Wear appropriate protective clothing (Face shield, protective gloves etc.).

- Comply with the operating instructions of the motor. (Some three-phase motors have their safety instructions contained with the terminal box).
- Never operate pump dry.
- The pump should not be exposed to the weather.
- Clean after each operation.
- Never store the motor in areas in which corrosive vapours exist.



Pumps F 560 GS ... and F 560 S ...

- Never operate against a closed outlet.
- If the pump is operated against a closed outlet, a by-pass (pressure relief) valve must be used.

For use in hazardous locations



Only use motors which are approved for use in hazardous locations (Zone 1).

Motors to be used with the pump F 560 GS ... :

- F 410 Ex Commutator motor
- F 450 Ex Commutator motor
- F 460 Ex Commutator motor
- F 416 Ex Compressed air motor (approval not necessary)
- F 416-1 Ex Compressed air motor (approval not necessary)

Motors to be used with the pump F 560 S ... :

- Explosion-proof three-phase motors
0,75 to 1,1 kW, 700 to 930 rpm
- Compressed air motors FPM 4, FPM 6, FPM 8 (approval not necessary).



Observe the Test Certificate or the Certificate of Conformity.

- The explosion-proof motor has to be outside the container.
- Only use electrically conductive hoses (see TRbF 131 part 2). This will provide a conductive path for the pump, hoses and fittings.
- Only use an explosion-proof plug or an explosion-proof cable terminal box when making connections to the motor.
- If the electrical socket or the terminal box is positively located outside of the hazardous area, connection to explosion-proof equipment must not be undertaken.



The installation and operations must comply with the relevant Health & Safety Regulations.

Pump F 560 GS ...

Available drive motors :

- **Commutator motors** F 408, F 448, F 417, F 457, F 458, F 417 EL, F 457 EL, F 410 Ex, F 450 Ex, F 460 Ex.
- **Compressed air motors** F 416 Ex, F 416-1 Ex.

- Make sure that the supply voltage corresponds to the voltage indicated on the name plate.
When using compressed air motors, please do not exceed the maximum operating pressure and use a filter-regulator-lubricator unit.
- Put the motor onto the pump.
- Firmly tighten the union nut by hand.
- Immerse the pump into the liquid and secure it in a vertical position by the use of a compression gland or a container clamp.
- Secure the discharge hose on the container to be filled.
- Before inserting the electrical plug into the socket, ensure that the Start/Stop switch is set to "0" (Stop). For compressed air motors, the air isolation valve must be closed.
- Insert the plug or connect the compressed air hose.
- Switch on the motor.
- When using compressed air motors, adjust the speed by the air pressure.

Pump F 560 S ...

Available drive motors :

- **Three-phase motors**
0,75 to 1,1 kW, 700 to 930 rpm
- **Compressed air motors FPM 4, FPM 6, FPM 8**



- Installation and repairs to three-phase motors should only be carried out by suitably qualified personnel.
- Only use three-phase motors with a starter including an overload cut-out.
- Make sure that the supply voltage corresponds to the voltage indicated on the name plate.
When using compressed air motors, please do not exceed the maximum operating pressure and use a filter-regulator-lubricator unit.
- Check direction of rotation of the motor.
In case of portable use, check again the direction of rotation.
(Direction of rotation according to the arrow on the bearing flange).
- Clean bearing flange and motor flange.
- Fit the motor onto the bearing flange and tighten the screws.

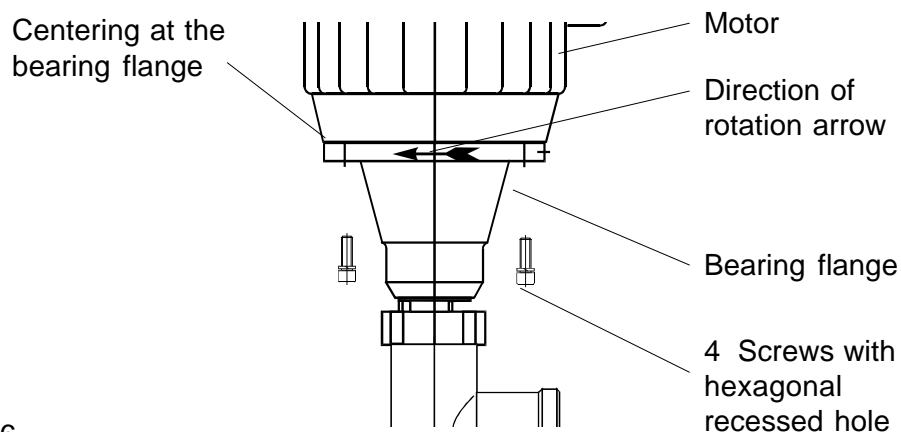

- Immerse the pump into the liquid and secure it in a vertical position by the use of a compression gland or a container clamp.
- Before inserting the electrical plug into the socket, ensure that the Start/Stop switch is set to "0" (Stop).For compressed air motors, the air isolation valve must be closed.
- Insert the plug or connect the compressed air hose.
- Switch on the motor.
- When using compressed air motors, adjust the speed by the air pressure.
Do not exceed the maximum speed of 1000 min⁻¹.

Cleaning after each operation

Clean the pump by flushing an appropriate cleaning agent.

- Pump and hose must be resistant to the cleaning agent.
- The pump should not be immersed into the cleaning agent higher than the outlet connection.
- Do not use flammable liquids to clean the pump or motor.
- After each operation with sticky or self hardening liquids, the pumps should be flushed with a suitable cleaning agent.
The pump should then be dismantled and the mechanical seal carefully cleaned.
- After cleaning a few drops of lubricant should be put on the stator and on the eccentric worm.
Afterwards run the motor briefly.

Storage

- Unplug the pump or disconnect the compressed air hose.
- Use a wall bracket to store the pump in a vertical position.

Dismantling / Re-assembly

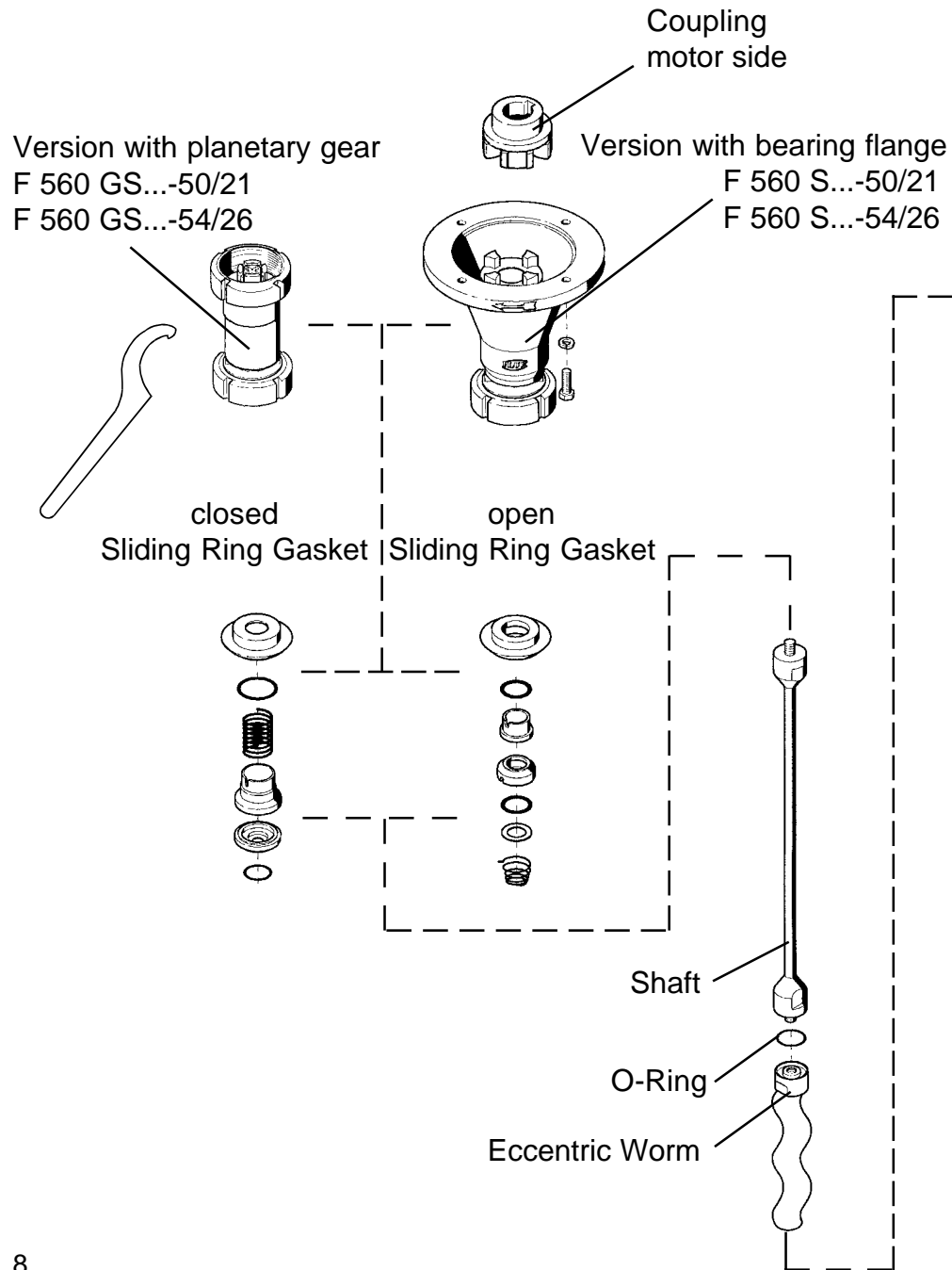

Outer Tube:			
F 560 GS3A-...	F 560 S3A-...	Clamp 2"	ground and polished
F 560 GS1-...	F 560 S1-...	Rd 58 x 1/6	electrolytically polished
F 560 GS2-...	F 560 S2-...	G 1 1/2 A	electrolytically polished
F 560 GS3-...	F 560 S3-...	Clamp 2"	electrolytically polished

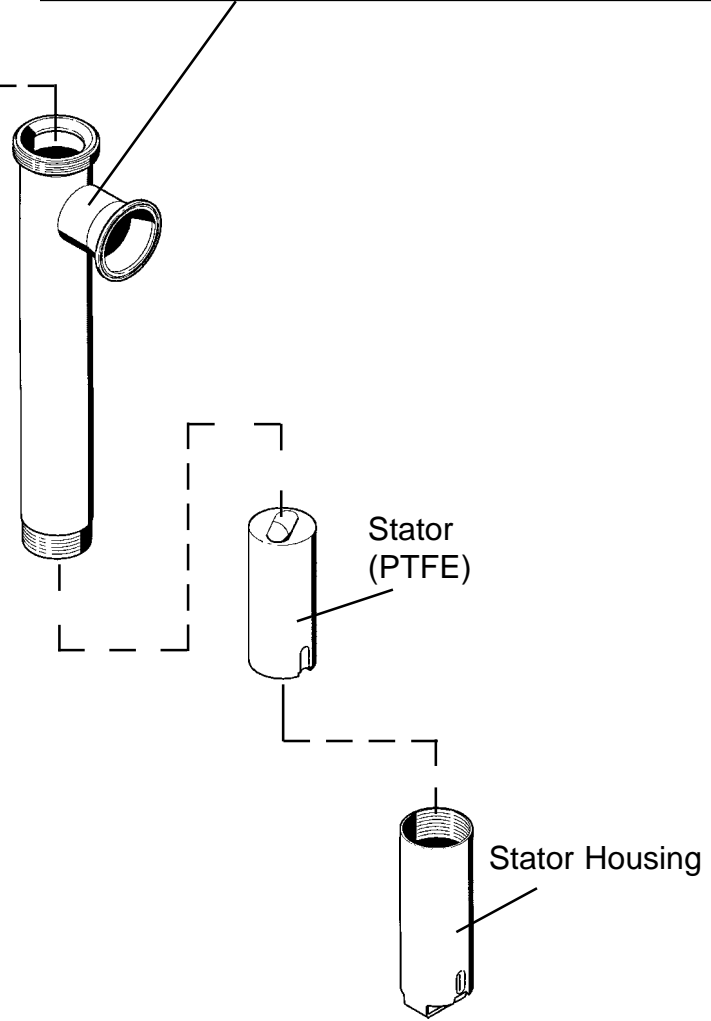

Dismantling of the closed Sliding Ring Gasket (SLRG)



- Make sure that the sealing and sliding faces on the SLRG will not be damaged.
- Make sure that the sealing faces on outer tube and centering disc will not be damaged.
- Do not use any tools to dismantle the SLRG to avoid any damage.

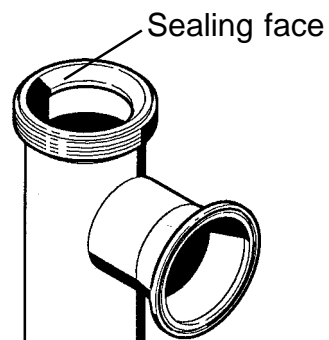
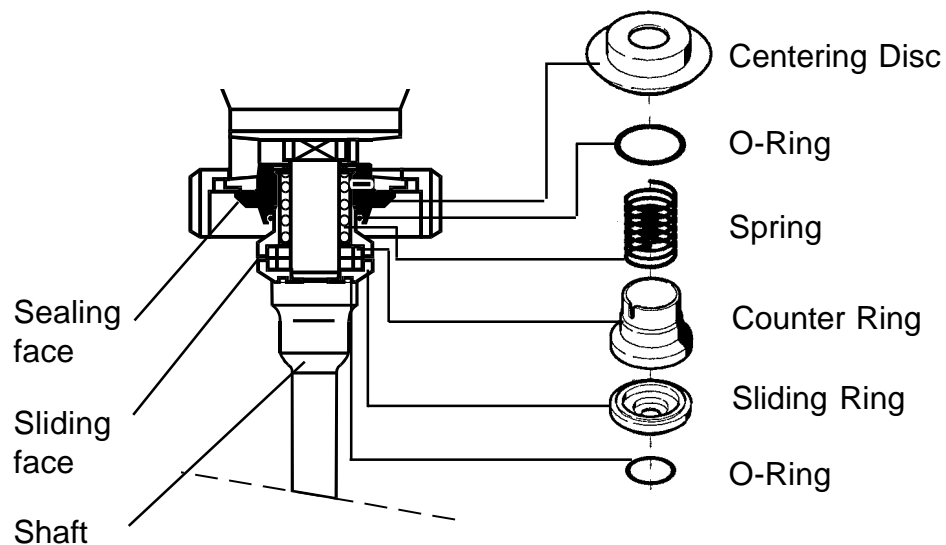

Dismantling of the open Sliding Ring Gasket (SLRG)



- Make sure tht the sealing and sliding faces on the SLRG will not be damaged.
- Make sure that the sealing faces on outer tube and centering disc will not be damaged.
- Do not use any tools to dismantle the SLRG to avoid any damage.

