



# Central Vacuum Pumping Equipment

## Central Vacuum System for Multiple Station Applications

- HIGH VOLUME VACUUM FOR MULTIPLE STATION OPERATION
- SIMULTANEOUS PUMPING FROM UP TO 3 STATIONS
- 235 GAL. GALVANIZED STEEL TANK
- DRY START LIFT TO 25'
- PUMP UP TO 50% SOLIDS
- PUSH BUTTON START/STOP AT EACH STATION
- EASY TO USE, LOW MAINTENANCE OPERATION.
- ALL MATERIALS SPECIFIED FOR THE MARINE ENVIRONMENT



An ideal pumping system when you need high volume suction at more than one station simultaneously. By driving the # 06, 40 cfm air pump with a 7.5 hp motor, enough negative air pressure is generated by this vacuum system to operate three 1.5" ID liquid suction stations at the same time. It also provides the capacity to depressurize thousands of feet of plumbing in seconds.

Suction sites can be equipped with remote start and stop switches and the main control panel has a timer that can be set to shut off the unit automatically in case an operator forgets.

Edson offers the same pumping equipment with larger or smaller tanks to meet different space and volume requirements. The 290-235-06E7.5 come complete with a control panel that can be programmed to automatically off-load a full collection tank to a secondary containment tank or to a sewer line.

The combination of unique features designed into this vacuum pumping equipment make it ideal for a marina pump out system, waste liquid reclamation and collection site or even a factory central waste oil collection system.

### Edson Vacuum Pumping Systems

**VACUUM PUMP UNIT:** Volume - 100 GPM / 152 LPM ● Suction Lift - to 25 ft / 7.6m ● Discharge Head - to 23 ft / 7m ● Galvanized 235 Gallon Steel Transfer Tank ● Automatic Reversing From Vacuum to Pressure ● Stainless Steel Hardware ● Inlet - 1 1/2" NPT ● Discharge - 2" NPT ● Air Pump - # 06, 40 CFM, Rotary Vane, Oil Protected ● Standard Electric - 7.5 HP, 3 Phase, 230/460 Volt, 60 HZ, TEFC Motor with a Control Panel with Timer and 24 Volt Remote Stop/Start Capability.

**PUMP STATION HYDRANT:** Marine Bronze Ball Valve, Check Valve & Elbow ● Heavy Duty, Marine Bronze Mounting Flange ● All 1 1/2" NPT

**PUMP HOSE ASSEMBLIES:** 1 1/2" Polyflex Hose ● 90° Ball Valve ● Sight Glass/Check Valve ● Quick Clamp Adapter ● Complete Set of Deck Adapters ● 25 ft Length Standard ● 50ft Optional

**HOSE STAND CONSTRUCTION:** White Powder Coated Aluminum ● Start/Stop Buttons Installed ● Remote NEMA 4 Start/Stop Control Box Optional ● Stainless Steel Optional

### ORDERING INFORMATION

DESCRIPTION <i>See Price List For Other Models</i>	WEIGHT (Lbs / Kgs)	ORDER NO.
Vacuum Pumping Unit 235 Gal, 7.5 HP	750 / 112	290-235-067.5
Edson Hose Stand with Start/Stop	35 / 15.7	260-284
Bronze Pump Out Hydrant 1 1/2" NPT	35 / 15.7	270BR-150
25 ft Pump Out Hose Assembly	25 / 11.2	261-25-150
50 ft Pump Out Hose Assembly	35 / 15.7	261-50-150



## Edson High Volume Vacuum Pumping Systems

**Pump Unit:** 290 235 06E 7.5 fig. 1  
 7.5hp/3ph/230/460v/60hz/tefc Motor  
 Model 06 Air Pump  
 Automatic Continuous Pumping Control Package  
 Nema 4X Control Panel with Key Switch  
 235 Gallon Galvanized Steel Tank

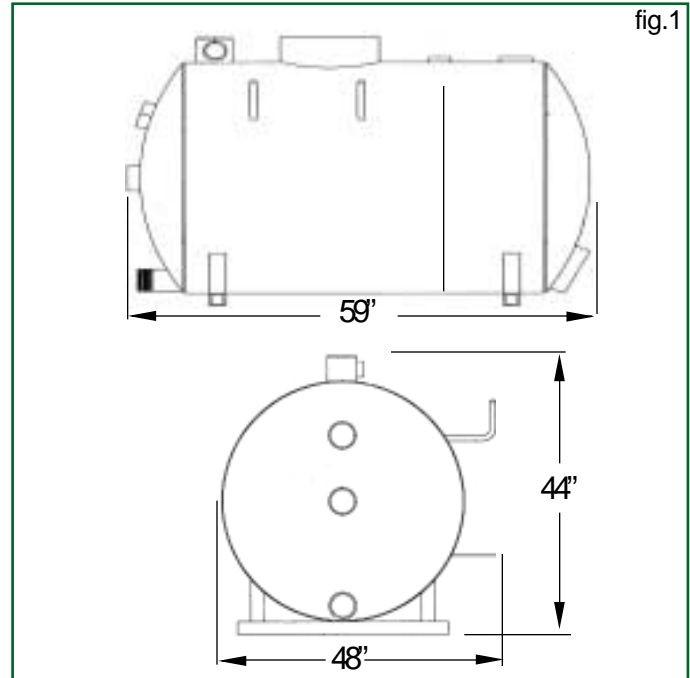

**Hose Stand:** White Powder Coated Aluminum with Start/Stop Buttons Installed, Operation Instructions Sign and (4) 1/2" X 7" Aluminum Hex Head Mounting Bolts. fig.2

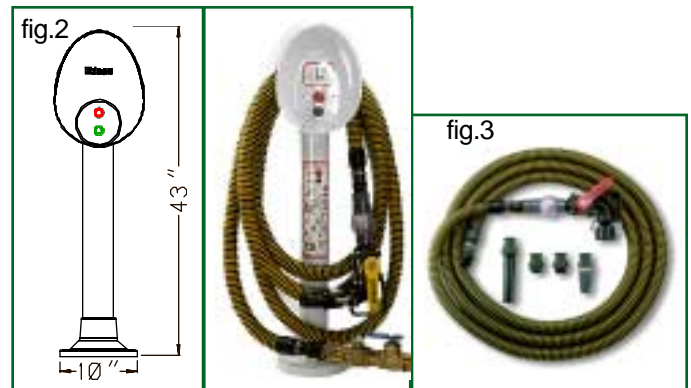

**Hose Assembly:** 25' X 1 1/2" Polyflex Hose, 90° Ball Valve, Sight Glass/Check Valve, Quick Clamp Adapter, Complete Set of Deck Adapters. fig.3

**Hydrant (Optional):** 1 1/2" Bronze Check Valve, Bronze Ball Valve and Quick Clamp Hose Adapter with Bronze Elbow and Close Nipple with Bronze Mounting Flange. fig.4  
 Order No. 270BR-150

