

FEATURES

Superior Design

- Triplex plunger design gives smoother fluid flow.
- V-Packings are completely lubricated and cooled by the fluid being pumped.
- Inlet and discharge valve assemblies interchange for easier maintenance.
- Oil bath crankcase assures optimum lubrication.
- Close tolerance concentricity of the ceramic plunger maximizes seal life.

Quality Materials

- 304 or 316 stainless steel valves are heat treated and seats are roller burnished for a positive seal and extended valve life.
- Forged Brass, cast Nickel Aluminum Bronze or 316 Stainless Steel manifolds for strength and corrosion resistance.
- Special concentric, high density, polished, graphite impregnated, solid ceramic plungers are abrasion resistant and result in extended seal life.
- Specially formulated, CAT PUMP exclusive, V-Packings offer unmatched performance and seal life.
- Die cast aluminum crankcase provides high strength, minimum weight and precision tolerance control.
- Chrome-moly crankshaft gives unmatched strength and surface hardness.
- Oversized crankshaft bearings with greater loading capacity mean longer bearing life.

Easy Maintenance

- Wet-end is easily serviced without entering crankcase, requiring less time and effort.
- Valve assemblies are accessible without disturbing piping, for quick service.
- Preset packings mean no packing gland adjustment is necessary, reducing maintenance costs.

DETERMINING THE PUMP R.P.M. $\frac{\text{Rated G.P.M.}}{\text{Rated R.P.M.}} = \frac{\text{"Desired" G.P.M.}}{\text{"Desired" R.P.M.}}$

DETERMINING THE REQUIRED H.P. $\frac{\text{GPM} \times \text{PSI}}{1460} = \text{Electric Brake H. P. Required}$

DETERMINING MOTOR PULLEY SIZE $\frac{\text{Motor Pulley O.D.}}{\text{Pump R.P.M.}} = \frac{\text{Pump Pulley O.D.}}{\text{Motor R.P.M.}}$

Note: Consult engine manufacturer when using gas or diesel engine.

Refer to pump Service Manual for important Inlet Condition Check-List, Start-up Procedure, Tech Bulletins and Pump Maintenance information.

60 Frame Plunger Pump

Forged Brass Model

6760

Stainless Steel Model

6761

Nickel Aluminum Bronze Model

6767

SPECIFICATIONS

U.S. Measure

Metric Measure

STANDARD SPECIFICATIONS - 6760, 6761, 6767

Volume60 GPM (230 L/M)
 Discharge Pressure100 to 1200 PSI (7 to 85 BAR)
 RPM520 RPM (520 RPM)

ALTERNATE SPECIFICATIONS - 6761, 6767

Volume* 70 GPM (260 L/M)
 Discharge Pressure100 to 1000 PSI (7 to 70 BAR)
 RPM600 RPM (600 RPM)

ALTERNATE SPECIFICATIONS - 6760 ONLY

Volume75 GPM (279 L/M)
 Discharge Pressure100 to 1000 PSI (7 to 70 BAR)
 RPM643 RPM (643 RPM)

COMMON SPECIFICATIONS

Inlet Pressure.....* Flooded to 50 PSI (Flooded to 3.5 BAR)
 Bore.....2.165" (55 mm)
 Stroke.....2.579" (65.5 mm)
 Crankcase Capacity.....10 Qts. (9.46 L)
 Max. Fluid Temperature.....140°F (60°C)
 Inlet Ports (2).....* 2" NPT (2" NPT)
 Discharge Ports (2).....1-1/4" NPT (1-1/4" NPT)
 Shaft Diameter.....1.772" (45 mm)
 Weight.....335 lbs. (151.95 kg)
 Dimensions31.53" x 24.33" x 18.34" (801 x 618 x 466 mm)

* A 2-1/2" inlet line is recommended for both alternate performances.

HORSEPOWER REQUIREMENTS

MODEL	FLOW		PRESSURE			RPM
			PSI	PSI	PSI	
	U.S. GPM	L/M	900	1000	1200	
6760	75	279	46.3	51.5	N/A	643
6760	70	260	43.2	48.1	N/A	600
6761	60	230	37.1	41.2	49.4	520
6767	50	189	30.9	34.3	41.2	433

See complete Drive Packages [Incls: Pulleys, Belts, Hubs, Key] Tech Bulletin 03.

"Customer confidence is our greatest asset"

PARTS LIST

ITEM	PART NUMBER		PART NUMBER		PART NUMBER		DESCRIPTION	QTY
	6760	MATL	6761	MATL	6767	MATL		
● 2	43048	STL	43048	STL	43048	STL	Key (M14x9x90)	1 ●
5	80296	STZP	89728	SS	89728	SS	Screw, HH (M10x40)	8
6	12503	STZP	15847	S	15847	S	Lockwasher, Split (M10)	8
7	12490	STZP	19934	SS	19934	SS	Washer, Flat (M10)	8
8	29443	AL	29443	AL	29443	AL	Cover, Bearing, Outer	2
10	29444	NBR	29444	NBR	29444	NBR	O-Ring, Bearing Cover - 70	2
11	11443	NBR	11443	NBR	11443	NBR	Seal, Oil, Crankshaft - 70	2
12	43642	S	43642	S	43642	S	Washer, Shim (M120x0.3), Bearing, Inner	0-2
13	43643	S	43643	S	43643	S	Washer, Shim (M120x0.5), Bearing, Inner	0-2
15	29441	STL	29441	STL	29441	STL	Bearing, Roller	2
16	29442	AL	29442	AL	29442	AL	Cover, Bearing, Inner	2
17	29444	NBR	29444	NBR	29444	NBR	O-Ring, Bearing Cover	2
20	46681	HS	46681	HS	46681	HS	Rod, Connecting	3
21	44941	STZP	44941	STZP	44941	STZP	Washer, Tab	3
22	43641	STL	43641	STL	43641	STL	Washer, Shim (M10.5x1.5)	6
25	29440	FCM	29440	FCM	29440	FCM	Crankshaft, Dual End	1
31	828710		828710		828710		Protector, Oil Cap	1
32	43211		43211		43211		Cap, Oil Filler	1
33	14177	NBR	14177	NBR	14177	NBR	O-Ring, Oil Filler Cap - 70	1
34	44319	STZP	44319	STZP	44319	STZP	Bolt, Eye (M12)	1
38	11338	NBR	11338	NBR	11338	NBR	O-Ring, Dip Stick - 70	1
39	27769	BB	27769	BB	27769	BB	Stick, Dip	1
40	80288	STZP	89627	SS	89627	SS	Screw, HH (M10x30)	8
41	12503	STZP	15847	S	15847	S	Lockwasher, Split (M10)	8
42	12490	STZP	19934	SS	19934	SS	Washer, Flat (M10)	8
48	25625	STCP	25625	STCP	25625	STCP	Plug, Drain (1/4x11)	1
49	23170	NBR	23170	NBR	23170	NBR	O-Ring, Drain Plug - 70	1
50	29438	AL	29438	AL	29438	AL	Cover, Crankcase	1
51	29439	NBR	29439	NBR	29439	NBR	Gasket, Crankcase Cover	1
● 53	43284	AL	43284	AL	43284	AL	Crankcase w/Guide Pins	1 ●
54	43282	S	43282	S	43282	S	Pin, Guide	2
55	85440	STZP	89615	S	89615	S	Stud (M16x40)	2
64	29481	S	29481	S	29481	S	Pin, Rist	3
65	‡ 45384	SSZZ	45384	SSZZ	45384	SSZZ	Rod, Plunger	3
69	29453	STZP	29453	STZP	29453	STZP	Washer, Oil Seal	3
70	29454	NBR	29454	NBR	29454	NBR	Seal, Oil - 80	3
75	44752	NBR	44752	NBR	44752	NBR	Slinger, Barrier	3
88	45677	SS	45677	SS	45677	SS	Lockwasher, Split (M14)	3
90	44749	CC	44749	CC	44749	CC	Plunger	3
95	89783	S	44748	SS	44748	SS	Stud, Plunger Retainer (M14x147)	3
96	20214	PTFE	20214	PTFE	20214	PTFE	Back-up-Ring, Plunger Retainer	3
97	17616	NBR	17616	NBR	17616	NBR	O-Ring, Plunger Retainer - 80	3
	11686	FPM	11686	FPM	11686	FPM	O-Ring, Plunger Retainer	3
98	44751	SS	44751	SS	44751	SS	Gasket, Plunger Retainer	3
99	45276	BB	44750	SS	44750	SS	Retainer, Plunger (M10)	3
100	44760	PVDF	44760	PVDF	44760	PVDF	Retainer, Seal, Rear	3
	44761	PVDF	44761	PVDF	44761	PVDF	Retainer, Seal, Adapter Front	3
101	44762		44762		44762		Wick, Long Tab (M55x185)	3
106	44757	NBR	44757	NBR	44757	NBR	Seal, LPS w/SS-Spg	3
	45882	FPM	45882	FPM	45882	FPM	Seal, LPS w/SS-Spg	3
● 110	48460	BB	45769	SS	44754	NAB	Manifold, Inlet	1 ●
112	18175	NBR	18175	NBR	18175	NBR	O-Ring, Spacer, Inner - 80	3
	13338	FPM	13338	FPM	13338	FPM	O-Ring, Spacer, Inner	3
114	45287	BB	44767	SS	44767	SS	Spacer, Inlet Manifold	3
115	18175	NBR	18175	NBR	18175	NBR	O-Ring, Spacer, Outer - 80	3
	13338	FPM	13338	FPM	13338	FPM	O-Ring, Spacer, Outer	3
116	12504	STZP	19086	S	19086	S	Lockwasher, Split (M16)	4
117	89972	STZP	89729	S	89729	S	Screw, HH (M16x55)	4
126	45283	BB	48392	D	48392	D	Adapter, Female	3
127	44764	PTFE	44764	PTFE	44764	PTFE	V-Packing	6
128	45284	BB	45772	SS	45772	SS	Adapter, Male	3
141	44943	SS	44943	SS	44943	SS	Coil Spring, Spacer	24
142	48501	BB	45383	SS	45383	SS	Spacer w/Coil Springs	3
155	18178	NBR	18178	NBR	18178	NBR	O-Ring, Cylinder - 80	3
	13266	FPM	13266	FPM	13266	FPM	O-Ring, Cylinder	3
157	45285	BB	45321	SS	45321	SS	Cylinder, V-Packing	3
159	18178	NBR	18178	NBR	18178	NBR	O-Ring, Cylinder - 80	3
	13266	FPM	13266	FPM	13266	FPM	O-Ring, Cylinder	3
160	44756	SS	44756	SS	44756	SS	Pin, Guide	2
163	18176	NBR	18176	NBR	18176	NBR	O-Ring, Seat - 80	6
	13278	FPM	13278	FPM	13278	FPM	O-Ring, Seat	6
164	‡ 44772	SS	44772	SS	44772	SS	Seat	6
166	‡ 44774	SS	44774	SS	44774	SS	Valve	6
167	44773	SS	44773	SS	44773	SS	Spring, Valve	6
168	44775	PVDF	44775	PVDF	44775	PVDF	Retainer, Spring	6
170	‡ 44776	SS	44776	SS	44776	SS	Washer, Retainer	6
171	44780	SS	44780	SS	44780	SS	Spring, Coil, Retainer	6
172	18177	NBR	18177	NBR	18177	NBR	O-Ring, Valve Plug - 80	6
	13279	FPM	13279	FPM	13279	FPM	O-Ring, Valve Plug	6
174	48462	BB	48428	SS	44778	NAB	Plug, Valve (M70)	1
● 185	48461	BB	45774	SS	44769	NAB	Manifold, Discharge	1 ●
186	12504	S	19086	S	19086	S	Lockwasher, Split (M16)	2
188	89695	STZP	89694	S	89694	S	Screw, HSH (M16x110)	8
194	88853	STZP	81291	S	81291	S	Nut, Hex (M16)	2

EXPLODED VIEW

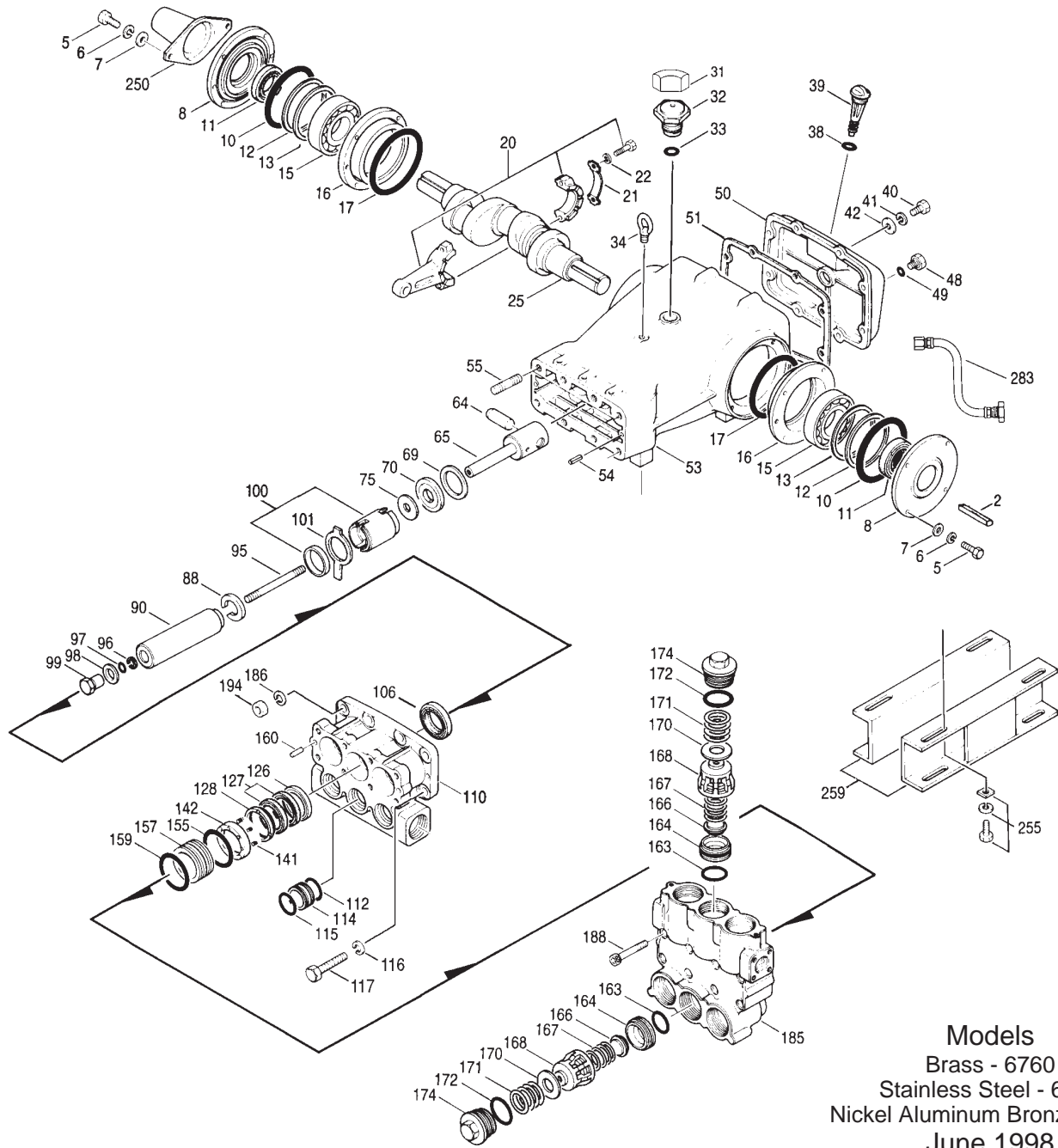

Models
 Brass - 6760
 Stainless Steel - 6761
 Nickel Aluminum Bronze - 6767
 June 1998

● 250	29445	AL	29445	AL	29445	AL	Protector, Shaft	1	●
● 255	33243		33243		33243		Kit, Mount (Included w/Pump)	1	●
● 259	29477	STZP	29477	STZP	29477	STZP	Rail (Included w/Pump) (Two per pump required)	2	●
● 275	30636		30636		30636		Hub & Key [See complete Drive Packages, Tech Bulletin 03]	1	●
● 279	30429	STZP	30429	STZP	30429	STZP	Oiler (10 oz.)	3	●
281	30969		30969		30969		Oiler, Glass (10 oz.)	3	●
282	10070		10070		10070		Gasket, Oiler	3	●
● 283	34334		34334		34334		Kit, Oil Drain	1	●
290	6108		6108		6108		Gasket, Liquid (0.5 oz.)	1	●
● 299	—	BB	816667	SS	814820	NAB	Head, Complete	1	●
300	34091	NBR	34091	NBR	34091	NBR	Kit, Seal (Incls: 97,106,112,115,127,155,159)	1	●
	34093	FPM	34093	FPM	34093	FPM	Kit, Seal (Incls: 97,106,112,115,127,155,159)	1	●
310	‡ 34092	NBR	34092	NBR	34092	NBR	Kit, Valve (Incls: 163,164,166,167,168,170,172)	2	●
	31273	FPM	31273	FPM	31273	FPM	Kit, Valve (Incls: 163,164,166,167,168,170,172)	2	●
—	88902		88902		88902		Stud (M16x277) (For removing D.M., I.M.)	2	●
● 390	—		—		—		C.A.T. (For R.O. or Industrial Applications)	1	●
● 391	—		—		—		Adapters (2 per C.A.T.) (See Data Sheet for complete selection)	2	●
—	6565.5		6565.5		6565.5		Plunger Pump Service Video, Section V	1	●

● Industrial discount. **Bold print part numbers are unique to a particular pump model.** *Italics are optional items.*

C. A.T. highly recommended for pressurized inlet, R.O. and Industrial applications. See Tech Bulletins 03, 24, 36, 43, 52, 53, 54, 64, 74 and 77 for additional information.

‡ Production parts 304SS, replacement parts are 316SS.

MATERIAL CODES (Not Part of Part Number): AL=Aluminum BB=Brass CC=Ceramic D=Delryn® FCM=Forged Chrome-moly FPM=Fluorocarbon (Viton®) HS=High Strength NAB=Nickel Aluminum Bronze NBR=Medium Nitrile (Buna-N) PTFE=Polytetrafluoroethylene (Teflon®) PVDF=Fluoroplastic (High Strength) S=304SS SS=316SS SSZZ=316SS/Zamak STCP=Steel/Chrome Plated STL=Steel STZP=Steel/Zinc Plated

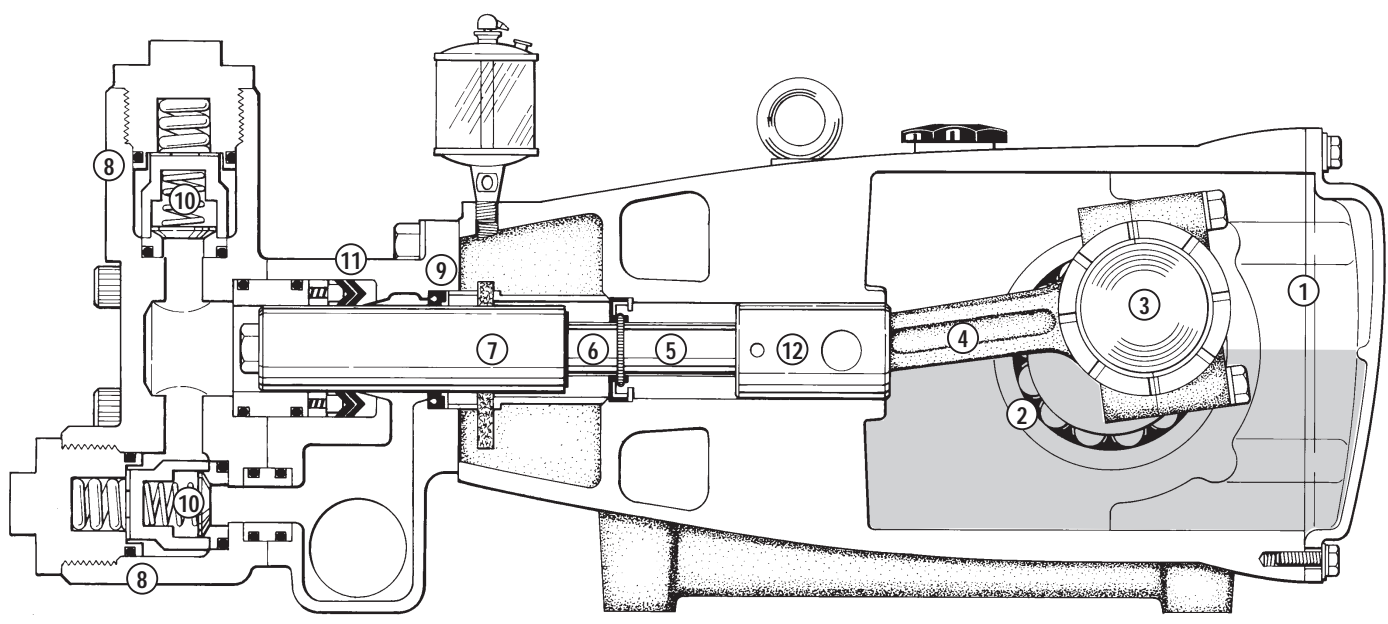
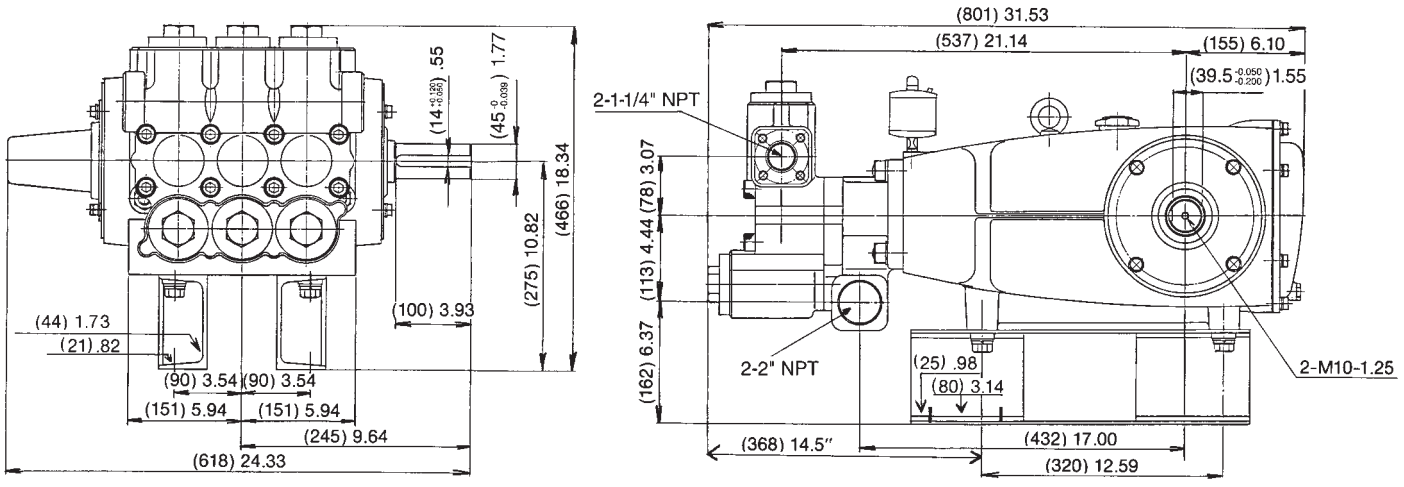

- 1 Die cast aluminum **crankcase** means high strength, lightweight, and excellent tolerance control.
- 2 Oversized crankshaft **bearings** provide extended bearing life and pump performance.
- 3 Chrome-moly **crankshaft** provides unmatched strength and surface hardness for long life.
- 4 Matched oversized **connecting rods** are made of Zamak, a material noted for strength and superior bearing quality.
- 5 The **plunger rods** are high tensile strength stainless steel with Zamak crossheads.
- 6 The stainless steel **slinger** provides back-up protection for the crankcase seal, keeping pumped fluids out of the crankcase.
- 7 Special concentric, high density, polished, graphite impregnated, solid ceramic **plungers** are abrasion resistant and result in extended seal life.
- 8 **Manifolds** are a high tensile strength forged brass, nickel aluminum bronze or stainless steel for long term, continuous duty.
- 9 100% wet **seal** design adds to service life by allowing pumped fluids to cool and lubricate on both sides.
- 10 Stainless steel **valves, seats and springs** provide corrosion-resistance, positive seating and long life.
- 11 Specially formulated, CAT PUMP exclusive, **V-Packings** offer unmatched performance and seal life.
- 12 **Crossheads** are 360° supported for uncompromising alignment.

Products described hereon are covered by one or more of the following U.S. patents 3558244, 3652188, 3809508, 3920356, 3930756 and 5035580 June 1998 6841

World Headquarters
CAT PUMPS

1681 - 94th Lane N.E. Minneapolis, MN 55449-4324
 Phone (612) 780-5440 — FAX (612) 780-2958
 e-mail: sales@catpumps.com
 www.catpumps.com

International Inquiries
 FAX (612) 785-4443
 e-mail: intlsales@catpumps.com



CAT PUMPS (U.K.) LTD.

1 Fleet Business Park, Sandy Lane, Church Crookham, Fleet
 Hampshire GU13 0BF, England
 Phone Fleet 44 1252-622031 — Fax 44 1252-626655

N.V. CAT PUMPS INTERNATIONAL S.A.

Heiveldekens 6A, 2550 Kontich, Belgium
 Phone 32-3-450.71.50 — Fax 32-3-450.71.51
 e-mail: cpi@catpumps.be

CAT PUMPS DEUTSCHLAND GmbH

Buchwiese 2, D-65510 Idstein, Germany
 Phone 49 6126-93030 — Fax 49 6126-930333
 e-mail: catpumps@t-online.de