



SELF-PRIMING DIAPHRAGM PUMPS

- Aluminum Construction (Except 2D Models which are Cast Iron)
- Self-priming to 25 Ft.
- Neoprene or "DuraBlue 1000™" Diaphragm Material
- 2", 3" and 4" NPT Port Sizes
- Solids-Handling Capabilities to 2-1/4" Diameter
- Driver Options: ODP Electric Motor, Explosion-Proof Electric Motor, Gasoline Engine, or Basic Unit (less driver)
- Delivers up to 130 GPM
- Two (2) Wheel Truck Assembly Standard (Except 2D Models - Which are Furnished with a Stationary Base).



Model 2D

The Gorman-Rupp line of diaphragm pumps is designed to pump sludge, sewage, mud, and other heavy liquids that have the ability to flow. All models are self-priming, have built-in flap valves, and include a suction strainer. The 3" and 4" models are furnished with a two wheel truck assembly. Models are available with an explosion-proof motor, ODP electric motor, gasoline engine, or as a basic model, less driver (furnished with a flex coupling). Standard diaphragms are "DuraBlue 1000™" in 3" and Neoprene in 2" and 4" pumps.

PREMIUM HEAVY DUTY



Model 3D-X1.5 1P

Composite of Performance Curves

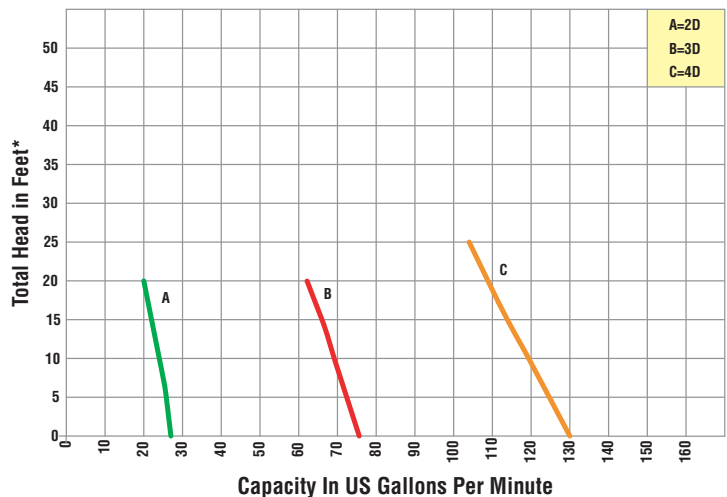

*Convert to PSI, divide by 2.31

Liquid-Water specific gravity 1.0

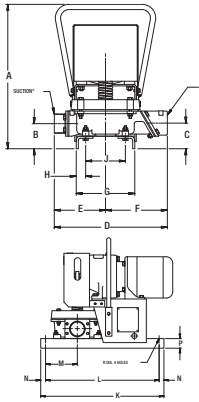

DIMENSIONS:

INCHES

(MILLIMETERS)

DIAPHRAGM PUMPS																	
MODEL	A	B	C	D	E	F	G	H	J	K	L	M	N	P	R	SUC.*	DIS.*
2D-E.50 1P	17.25	3.00	3.00	13.52	6.00	7.39	7.00	1.12	4.75	19.25	17.75	5.00	0.75	1.50	0.41	2.00	2.00
	(438.2)	(76.2)	(76.2)	(343.4)	(152.4)	(187.7)	(177.8)	(28.4)	(120.6)	(489.0)	(450.9)	(127.0)	(19.0)	(38.1)	(10.4)		
2D-E.50 3P	17.25	3.00	3.00	13.52	6.00	7.39	7.00	1.12	4.75	19.25	17.75	5.00	0.75	1.50	0.41	2.00	2.00
	(438.2)	(76.2)	(76.2)	(343.4)	(152.4)	(187.7)	(177.8)	(28.4)	(120.6)	(489.0)	(450.9)	(127.0)	(19.0)	(38.1)	(10.4)		
2D-X.75 1P	17.25	3.00	3.00	13.52	6.00	7.39	7.00	1.12	4.75	19.25	17.75	5.00	0.75	1.50	0.41	2.00	2.00
	(438.2)	(76.2)	(76.2)	(343.4)	(152.4)	(187.7)	(177.8)	(28.4)	(120.6)	(489.0)	(450.9)	(127.0)	(19.0)	(38.1)	(10.4)		
2D-E.75 3P	17.25	3.00	3.00	13.52	6.00	7.39	7.00	1.12	4.75	19.25	17.75	5.00	0.75	1.50	0.41	2.00	2.00
	(438.2)	(76.2)	(76.2)	(343.4)	(152.4)	(187.7)	(177.8)	(28.4)	(120.6)	(489.0)	(450.9)	(127.0)	(19.0)	(38.1)	(10.4)		

(*) STANDARD NPT PIPE THREADS

2" MOTOR-DRIVEN & BASIC DIAPHRAGM PUMPS

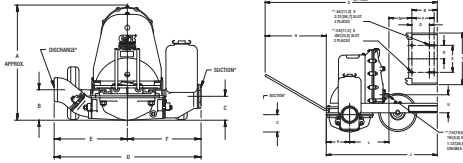

MODEL	A	B	C	D	E	F	G	H	J	K	L	M	N	P	Q	R	S	T	U	SUC.*	DIS.*
3D-B	22.26	5.69	3.63	28.25	13.69	14.56	49.4	19.50	29.94	6.50	12.31	N/A	N/A	N/A	N/A	N/A	N/A	N/A	N/A	2.00/3.00	3.00
	(565.4)	(144.5)	(92.1)	(717.6)	(347.7)	(369.9)	(1255.7)	(495.3)	(760.4)	(165.1)	(312.7)										
3D-E1.5 1P	22.26	5.69	3.63	28.25	13.69	14.56	49.4	19.50	29.94	6.50	12.31	N/A	N/A	N/A	N/A	N/A	N/A	N/A	N/A	2.00/3.00	3.00
	(565.4)	(144.5)	(92.1)	(717.6)	(347.7)	(369.9)	(1255.7)	(495.3)	(760.4)	(165.1)	(312.7)										
3D-E1.5 3P	22.26	5.69	3.63	28.25	13.69	14.56	49.4	19.50	29.94	6.50	12.31	N/A	N/A	N/A	N/A	N/A	N/A	N/A	N/A	2.00/3.00	3.00
	(565.4)	(144.5)	(92.1)	(717.6)	(347.7)	(369.9)	(1255.7)	(495.3)	(760.4)	(165.1)	(312.7)										
3D-X1.5 1P	22.26	5.69	3.63	28.25	13.69	14.56	49.4	19.50	29.94	6.50	12.31	N/A	N/A	N/A	N/A	N/A	N/A	N/A	N/A	2.00/3.00	3.00
	(565.4)	(144.5)	(92.1)	(717.6)	(347.7)	(369.9)	(1255.7)	(495.3)	(760.4)	(165.1)	(312.7)										
3D-X1.5 3P	22.26	5.69	3.63	28.25	13.69	14.56	49.4	19.50	29.94	6.50	12.31	N/A	N/A	N/A	N/A	N/A	N/A	N/A	N/A	2.00/3.00	3.00
	(565.4)	(144.5)	(92.1)	(717.6)	(347.7)	(369.9)	(1255.7)	(495.3)	(760.4)	(165.1)	(312.7)										
4D-B	26.32	6.96	5.47	33.60	16.73	16.87	54.25	19.25	35.00	7.38	12.38	7.25	8.00	7.00	5.50	5.50	5.50	5.50	5.50	3.00/4.00	4.00
	(668.5)	(176.8)	(138.9)	(853.4)	(424.9)	(428.5)	(1378.0)	(489.0)	(889.0)	(187.4)	(314.2)	(184.2)	(203.2)	(177.8)	(139.7)	(108.0)	(215.9)	(412.80)	(133.4)		
4D-E3 3P	26.32	6.96	5.47	33.60	16.73	16.87	51.66	19.25	32.38	7.38	12.38	N/A	N/A	N/A	N/A	N/A	N/A	N/A	N/A	3.00/4.00	4.00
	(668.5)	(176.8)	(138.9)	(853.4)	(424.9)	(428.5)	(1378.0)	(489.0)	(889.0)	(187.4)	(314.2)										
4D-X3 1P	26.32	6.96	5.47	33.60	16.73	16.87	51.66	19.25	32.38	7.38	12.38	N/A	N/A	N/A	N/A	N/A	N/A	N/A	N/A	3.00/4.00	4.00
	(668.5)	(176.8)	(138.9)	(853.4)	(424.9)	(428.5)	(1378.0)	(489.0)	(889.0)	(187.4)	(314.2)										
4D-X3 3P	26.32	6.96	5.47	33.60	16.73	16.87	51.66	19.25	32.38	7.38	12.38	N/A	N/A	N/A	N/A	N/A	N/A	N/A	N/A	3.00/4.00	4.00
	(668.5)	(176.8)	(138.9)	(853.4)	(424.9)	(428.5)	(1378.0)	(489.0)	(889.0)	(187.4)	(314.2)										

(*) STANDARD NPT PIPE THREADS. (**) MODELS 4D ONLY.

3" & 4" MOTOR-DRIVEN & BASIC DIAPHRAGM PUMPS

MODEL	CURVE	DESCRIPTION/ TYPE OF PUMP	SHIP WT.	DRIVER TYPE & HP	PORT SIZE SUC. X DIS. (NPT)	BASIC CONSTRUCTION	SEAL TYPE & ELASTOMER/FACES	VAC OR TANK SIZE	MOTOR ENCLOSURE
2D-E-50 1P	A	Diaphragm Pumps	120 lbs.	Electric Motor	2" x 2"	C.I.	Neoprene	115/230 1P	ODP
2D-E-50 3P	A	Diaphragm Pumps	120 lbs.	Electric Motor	2" x 2"	C.I.	Neoprene	230/460 3P	ODP
2D-X.75 1P	A	Diaphragm Pumps	120 lbs.	Electric Motor	2" x 2"	C.I.	Neoprene	115/230 1P	Exp. Proof
2D-X.75 3P	A	Diaphragm Pumps	120 lbs.	Electric Motor	2" x 2"	C.I.	Neoprene	230/460 3P	Exp. Proof
3D-B	B	Diaphragm Pumps	181 lbs.	N/A	3" or 2" x 3"	Alum.	DuraBlue™ Elastomer	N/A	For 145T
3D-E1.5 1P	B	Diaphragm Pumps	260 lbs.	Electric Motor	3" or 2" x 3"	Alum.	DuraBlue™ Elastomer	115/230 1P	ODP
3D-E1.5 3P	B	Diaphragm Pumps	260 lbs.	Electric Motor	3" or 2" x 3"	Alum.	DuraBlue™ Elastomer	230/460 3P	ODP
3D-X1.5 1P	B	Diaphragm Pumps	300 lbs.	Electric Motor	3" or 2" x 3"	Alum.	DuraBlue™ Elastomer	115/230 1P	Exp. Proof
3D-X1.5 3P	B	Diaphragm Pumps	300 lbs.	Electric Motor	3" or 2" x 3"	Alum.	DuraBlue™ Elastomer	230/460 3P	Exp. Proof
4D-B	C	Diaphragm Pumps	345 lbs.	N/A	4" or 3"x4"	Alum.	Neoprene	N/A	For 182T & 184T
4D-E3 3P	C	Diaphragm Pumps	420 lbs.	Electric Motor	4" or 3"x4"	Alum.	Neoprene	230/460 3P	ODP
4D-X3 1P	C	Diaphragm Pumps	440 lbs.	Electric Motor	4" or 3"x4"	Alum.	Neoprene	115/230 1P	Exp. Proof
4D-X3 3P	C	Diaphragm Pumps	440 lbs.	Electric Motor	4" or 3"x4"	Alum.	Neoprene	230/460 3P	Exp. Proof

Standard Features:

- Built-in flapper valves
- Includes suction strainer
- Models 3D-B & 4D-B are basic pumps less motor (furnished with flexible coupling)

WARNING: Do not use in explosive atmosphere or for pumping volatile flammable liquids.



See price book page 14

The Gorman-Rupp Company reserves the right to discontinue any model or change specifications at any time without incurring any obligation.

CP37-38/1206