



Self-Priming Solids Handling Pedestal Pumps

- Available in: Cast Aluminum, Cast Iron or Thermoplastic (See Specification Section for Specific Model Availability)
- Buna N Mechanical Seal
- Optional Seals Available (See Price Sheet for Specific Model Options)
- 1-1/2" to 3" NPT Suction and Discharge Ports
- Maximum Working Pressure up to 75 PSI
- Maximum Temperature 180° F
- Self-priming to 20 Ft.
- Shaft Diameter

1-1/2" & 2" Models	3/4"
3" Model	1-1/8"
- Sized From Minimum 3 HP to 8 HP Driver @ 3600 RPM Depending on Model

AMT Self-Priming Solids Handling Pedestal pumps are designed for direct or belt drive. Specific units are available in Cast Aluminum, Cast Iron or Thermoplastic construction material. The units feature 3/8" to 1-1/2" solids handling construction and are fitted with a Cast Iron bearing housing which contains two or three precision sealed ball bearings depending on specific model. Easy cleanout design by removing casing bolts, permits removal of debris without disconnecting hoses. The 3" Trash pump models feature cleanout covers with quick release handles for removal of debris. All units are self-priming to 20 feet.

AMT Self-Priming Solids Handling Pedestal pumps are reliable, cost effective and low maintenance. For use with nonflammable liquids compatible with pump component materials.

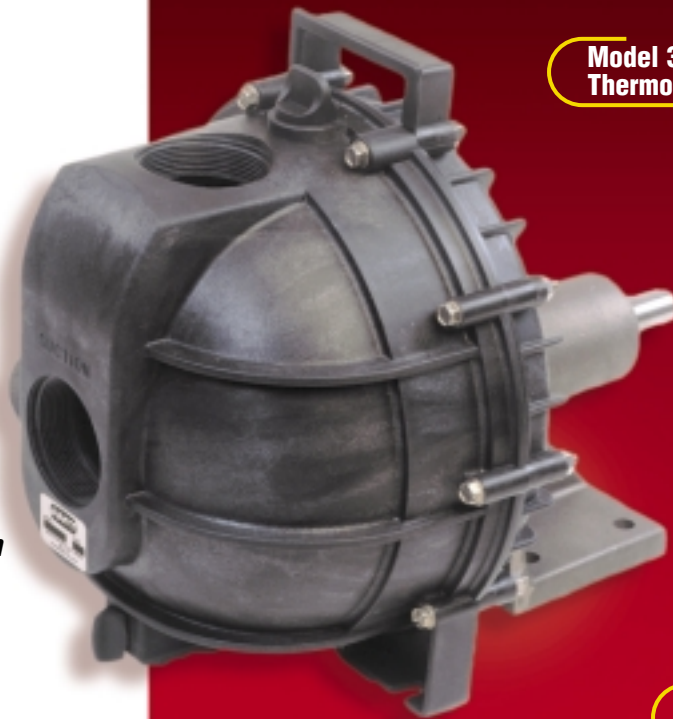

**Model 3826-99
Thermoplastic**



**Model 3160-99
Cast Iron**

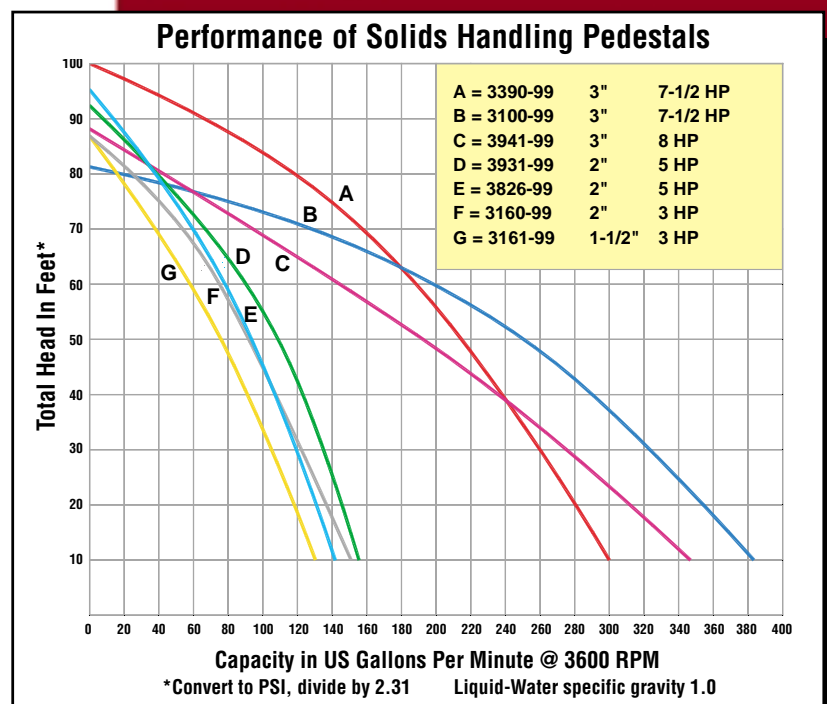

Self-Priming Solids Handling Pedestal Pumps

1-1/2" & 2" Solids Handling Models 3160-99, 3161-99 & 3931-99



(3161-99 Shown)

- Cast Iron Construction
- Buna N Mechanical Seal
- 1-1/2" & 2" NPT Suction & Discharge Ports Available
- Maximum Working Pressure 75 PSI
- Maximum Temperature 180° F
- Self-priming to 20 Ft.

- 3/8" Diameter Solids Handling Capability on 3160-99 & 3161-99
- 1" Diameter Solids Handling Capability on 3931-99
- Heavy Duty Cast Iron Bearing Housing Containing (2) Precision Sealed Ball Bearings
- 3/4" Diameter CNC Machined Shaft
- 1-3/8" x 3/16" x 3/32" Keyway

2" Dewatering Model 3826-99



- Thermoplastic Construction
- Buna N Mechanical Seal
- 2" NPT Suction & Discharge Ports
- Maximum Working Pressure 45 PSI
- Maximum Temperature 130° F
- Self-priming to 20 Ft.

- 2" Dewatering Construction
- 1/4" Diameter Solids Handling Capability
- Heavy Duty Cast Iron Bearing Housing Containing (2) Precision Sealed Ball Bearings
- 3/4" Diameter CNC Machined Shaft
- 1-3/8" x 3/16" x 3/32" Keyway
- 1/4" Diameter Solids Handling Capability

3" Solids Handling Model 3100-99, 3390-99 & 3941-99



(3100-99 Shown)

- Cast Aluminum Construction with Cast Iron Wear Parts
- Buna N Mechanical Seal
- 3" NPT Suction & Discharge Ports Available
- Maximum Working Pressure 75 PSI
- Maximum Temperature 180° F

- Self-priming to 20 Ft.
- 3/4" Diameter Solids Handling Capability on 3390-99
- 1-1/2" Diameter Solids Handling Capability on 3100-99 & 3941-99
- Heavy Duty Cast Iron Bearing Housing Containing (3) Precision Sealed Ball Bearings
- 1-1/8" Diameter CNC Machined Shaft
- 2-1/4" x 1/4" x 1/8" Keyway

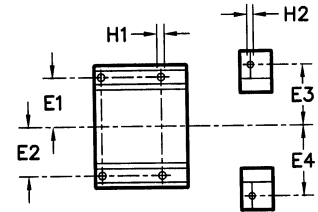
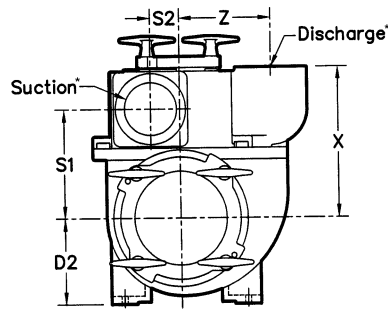
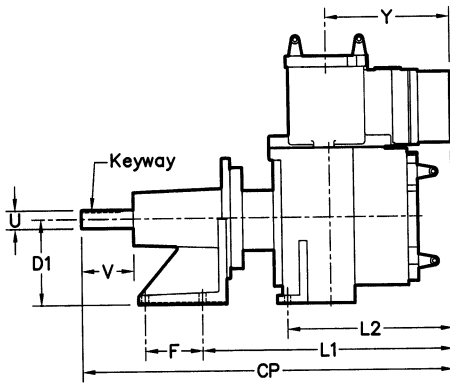

Model 3100-99 shown for Dimensional location only

Model No.	SUC*	DIS*	CP	D1	D2	E1	E2	E3	E4	F	H1	H2	L1	L2	S1	S2	U	V	X	Y	Z	Keyway	HP Required @3600 RPM	Ship Wt.
3160-99	2"	2"	15.1	4.2	4.2	1.9	1.9	2.6	3.8	2.5	0.4	0.4	9.8	4.9	2.1	-	3/4"	2.1	4.7	3.1	-	3/16" x 1-3/8"	5	41 Lbs.
3161-99	1-1/2"	1-1/2"	15.1	4.2	4.2	1.9	1.9	2.6	3.8	2.5	0.4	0.4	9.8	4.9	2.1	-	3/4"	2.1	4.7	3.1	-	3/16" x 1-3/8"	3	41 Lbs.
3390-99	3"	3"	19.9	5.3	5.3	2.9	2.9	3.8	2.6	3.5	0.4	0.4	12.5	4.1	4.0	-	1-1/8"	3.2	6.7	4.7	-	1/4" x 1-1/4"	7-1/2	54 Lbs.
3826-99	2"	2"	15.0	4.2	4.2	1.9	1.9	3.6	3.6	2.5	0.4	0.4	9.7	5.3	1.0	-	3/4"	2.1	5.8	2.8	-	3/16" x 1-3/8"	5	20 Lbs.
3100-99	3"	3"	23.1	5.2	5.2	2.9	2.9	3.5	4.1	3.5	0.4	0.4	15.6	10.3	6.7	1.8	1-1/8"	3.2	9.2	7.7	5.7	1/4" x 1-1/4"	7-1/2	91 Lbs.
3931-99	2"	2"	15.9	4.2	5.2	1.9	1.9	-	-	2.5	0.4	-	10.6	10.6	2.1	-	3/4"	1.1	4.7	2.8	-	3/16" x 1-7/8"	5	59 Lbs.
3941-99	3"	3"	22.0	5.2	6.4	2.9	2.9	-	-	3.5	0.4	-	14.5	-	3.5	-	1-1/8"	3.2	6.5	5.0	-	1/4" x 1-1/4"	7-1/2	82 Lbs.

(*) Standard NPT (female) pipe thread.
 NOTE: Dimensions have a tolerance of ± 1/8".



400 Spring Street, Royersford, PA 19468
 (610) 948-3800 Fax (610) 948-5300
 E-mail: amt@fast.net
 www.amtpump.com