

## RC2/RCH2 PUMPS

3x3

### AMPCO PUMPS COMPANY PARTS BREAKDOWN

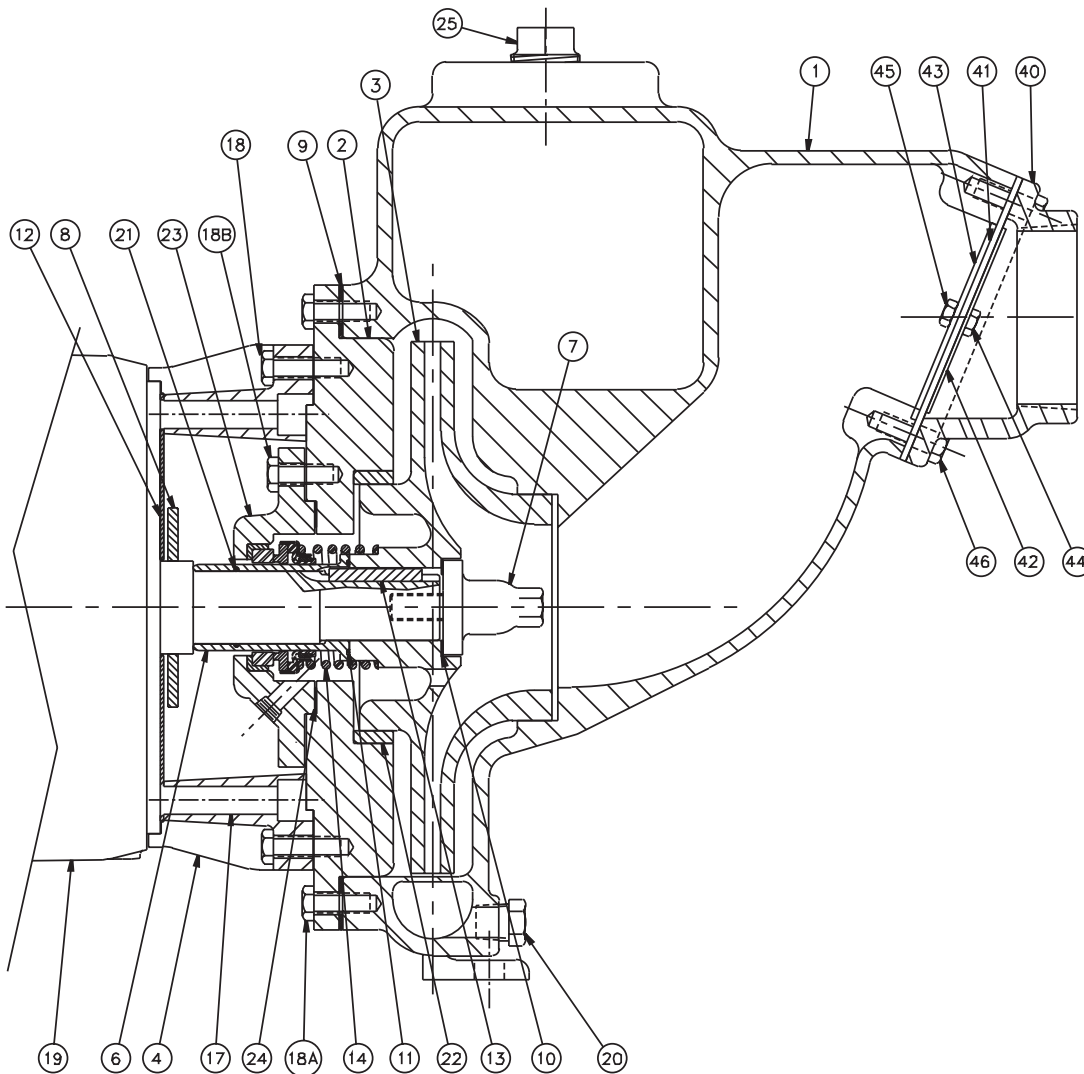

DETAIL NO.	REQ. NO.	PART NAME
46	4	CAP SCREW (CASING/FLAPPER)
45	1	NUT (FLAPPER/DISC)
44	1	CAP SCREW (FLAPPER/DISC)
43	1	DISC, FLAPPER, THICK
42	1	DISC, FLAPPER, THIN
41B <sup>1</sup>	4	FLAPPER SPACER
41	1	FLAPPER
40	1	FLAPPER BODY
25	1	FILL PLUG
24	1	STUFFING BOX GASKET
23	1	STUFFING BOX
22	1	WEAR RING (COVER)
21 <sup>2</sup>	1	O-RING (SHAFT/SLEEVE)
20	2	DRAIN PLUG
19	1	MOTOR
18B	4	CAP SCREW (COVER/STUFFING BOX)
18A	12	CAP SCREW (CASING/COVER)
18	8	CAP SCREW (COVER/ADAPTER)
17	4	CAP SCREW (MOTOR/ADAPTER)
16 <sup>1</sup>	2	DRIVE SCREW
15 <sup>1</sup>	1	NAME PLATE
14	1	MECHANICAL SEAL
13	1	IMPELLER KEY
12	1	SPLASH PLATE
11	1	GASKET or O-RING(SLEEVE/IMPELLER)
10	1	GASKET (IMPELLER SCREW)
9	1	GASKET (CASING/COVER)
8	1	SLINGER
7	1	IMPELLER SCREW
6	1	SHAFT SLEEVE
4	1	ADAPTER
3	1	IMPELLER
2	1	COVER
1	1	CASING

<sup>1</sup>NOT SHOWN

<sup>2</sup>RCH2 ONLY

NOTE: Please be sure to always include pump type, size, and serial number with any reference to above numbers and names.