

Ampco Centrifugal Pumps

DATA SHEET

MODEL RC2/RCH2 3X3

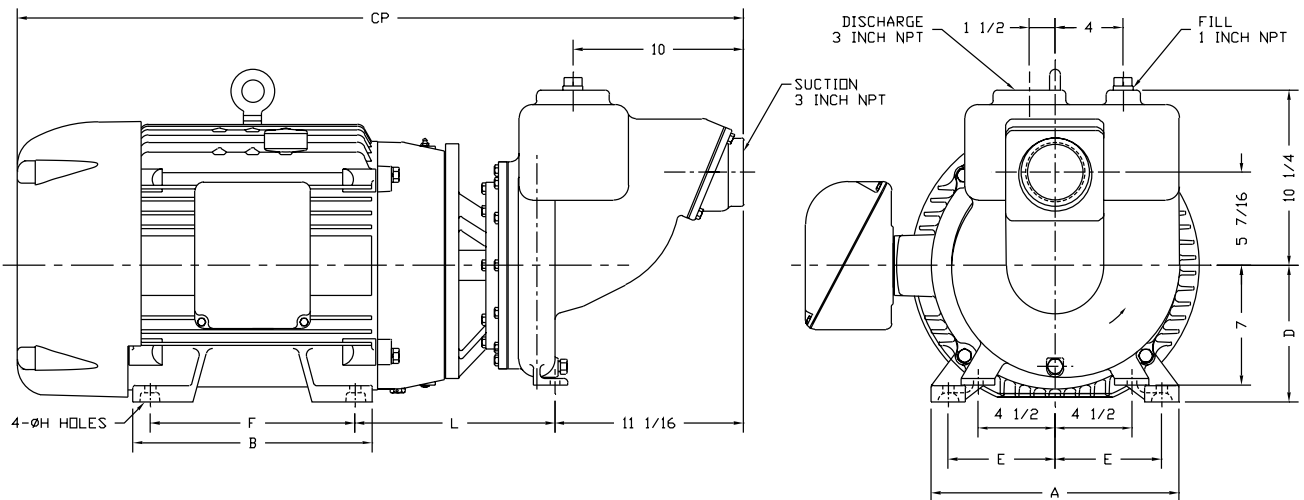
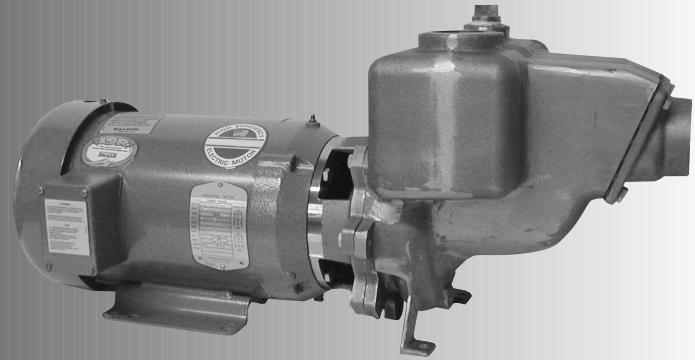

TEFC MOTOR			DIMENSIONS IN INCHES (For Reference Only)								APPROX. WEIGHT
HP	RPM	FRAME	A (max)	B (max)	D	E	F	H	L	CP	
5	1750	184JM	8-5/8	6-1/2	4-1/2	3-3/4	5-1/2	13/32	9-3/4	31-11/32	223
7-1/2	1750	213JM	9-1/2	8	5-1/4	4-1/2	5-1/2	13/32	10-3/4	32-13/16	273
25	3500	284JM	12-3/4	12-3/4	7	5-1/2	9-1/2	17/32	11-1/4	40-5/8	531
30	3500	286JM	12-3/4	12-3/4	7	5-1/2	11	17/32	11-1/4	40-5/8	533
40	3500	324JM	14-1/2	14	8	6-1/4	10-1/2	21/32	11-3/4	42-17/32	639
50	3500	326JM	14-1/2	14	8	6-1/4	12	21/32	11-3/4	42-17/32	725

MATERIAL SPECIFICATIONS

PART NAME	NICKEL ALUMINUM BRONZE	STAINLESS STEEL
Casing, Impeller & Cover	AMPCO® 483	316 Stainless Steel
Shaft Sleeve & Wear Ring	AMPCO® 18	316 Stainless Steel
Impeller Screw	AMPCO® 18	316 Stainless Steel
Motor Shaft	Steel	Steel
Adapter	Cast Iron	Cast Iron

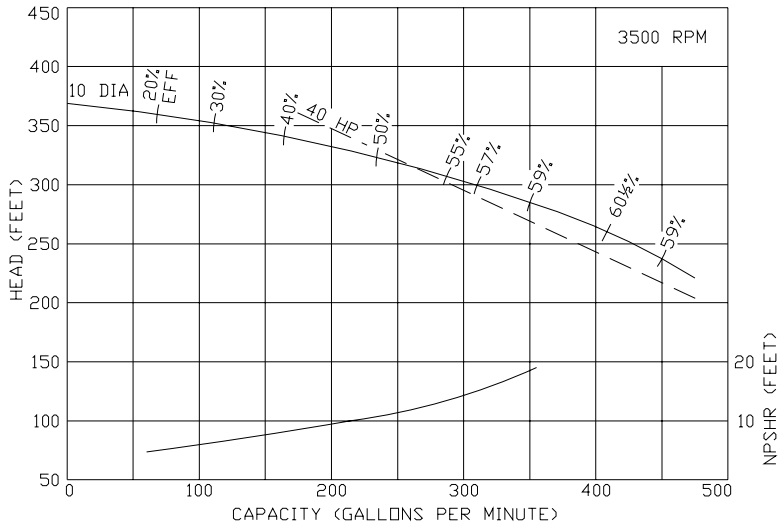

Ampco Centrifugal Pumps

MODEL RC2/RCH2 3X3

Curves show approximate characteristics based on clear 68° water.
Rated point is guaranteed.

RC2/RCH2 self-priming pumps are close coupled to JM frame motors and have NPT threaded connections.

Seal options include Type 21, Type 1 and Type 9 with choice of sealing materials.

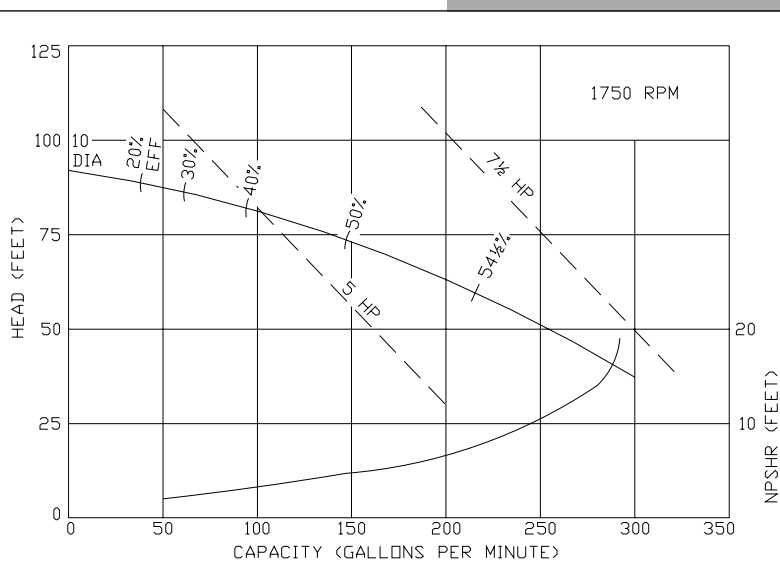
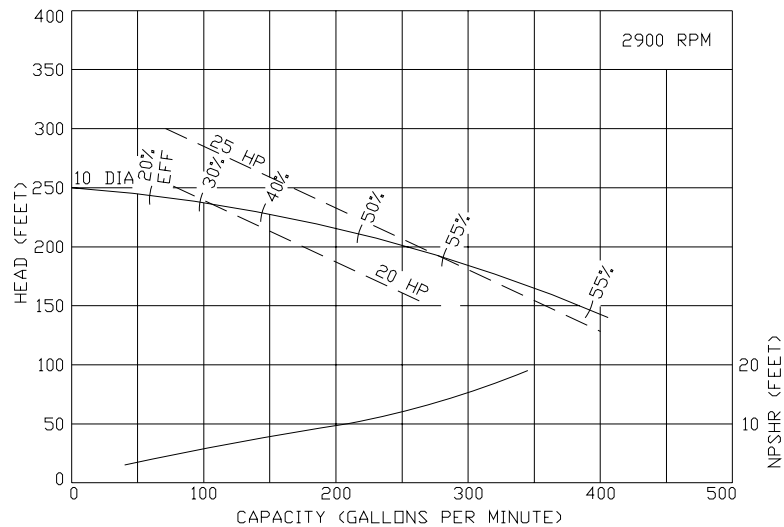

Ampco Pumps Company

4424 West Mitchell Street
Milwaukee, Wisconsin 53214
PHONE (414) 643-1852
FAX (414) 643-4452