

## KP2 PUMPS

### AMPCO PUMPS COMPANY PARTS BREAKDOWN

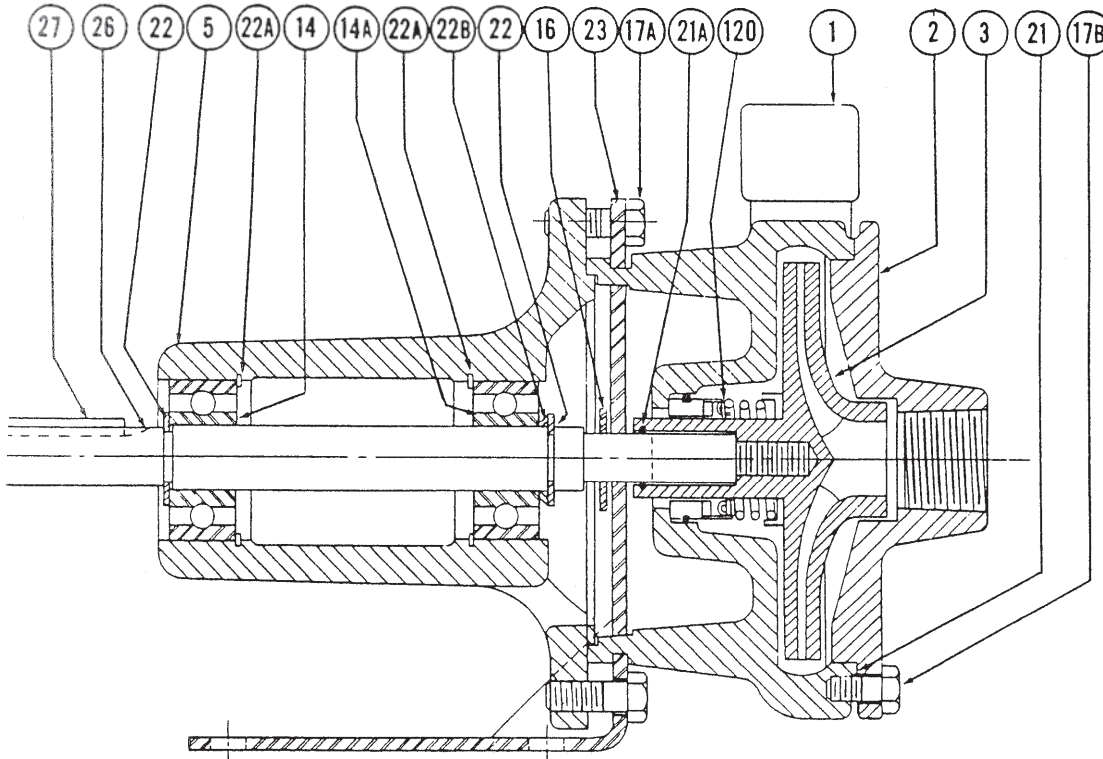

DETAIL NO.	PART NAME
120	MECHANICAL SEAL
27	KEY - COUPLING
26	SHAFT
23	BRACKET
22B	WAVE SPRING WASHER
22A	INT. RETAINING RING
22	EXT. RETAINING RING
21A	O-RING (IMPELLER)
21	GASKET (CASING/COVER)
17B	CAP SCREW
17A	CAP SCREW
16	SLINGER
14A	INBOARD BEARING
14	OUTBOARD BEARING
5	BEARING ADAPTER
3	IMPELLER
2	COVER
1	CASING

NOTE: Please be sure to always include pump type, size, and serial number with any reference to above numbers and names.