

SSH

Effective August, 2004

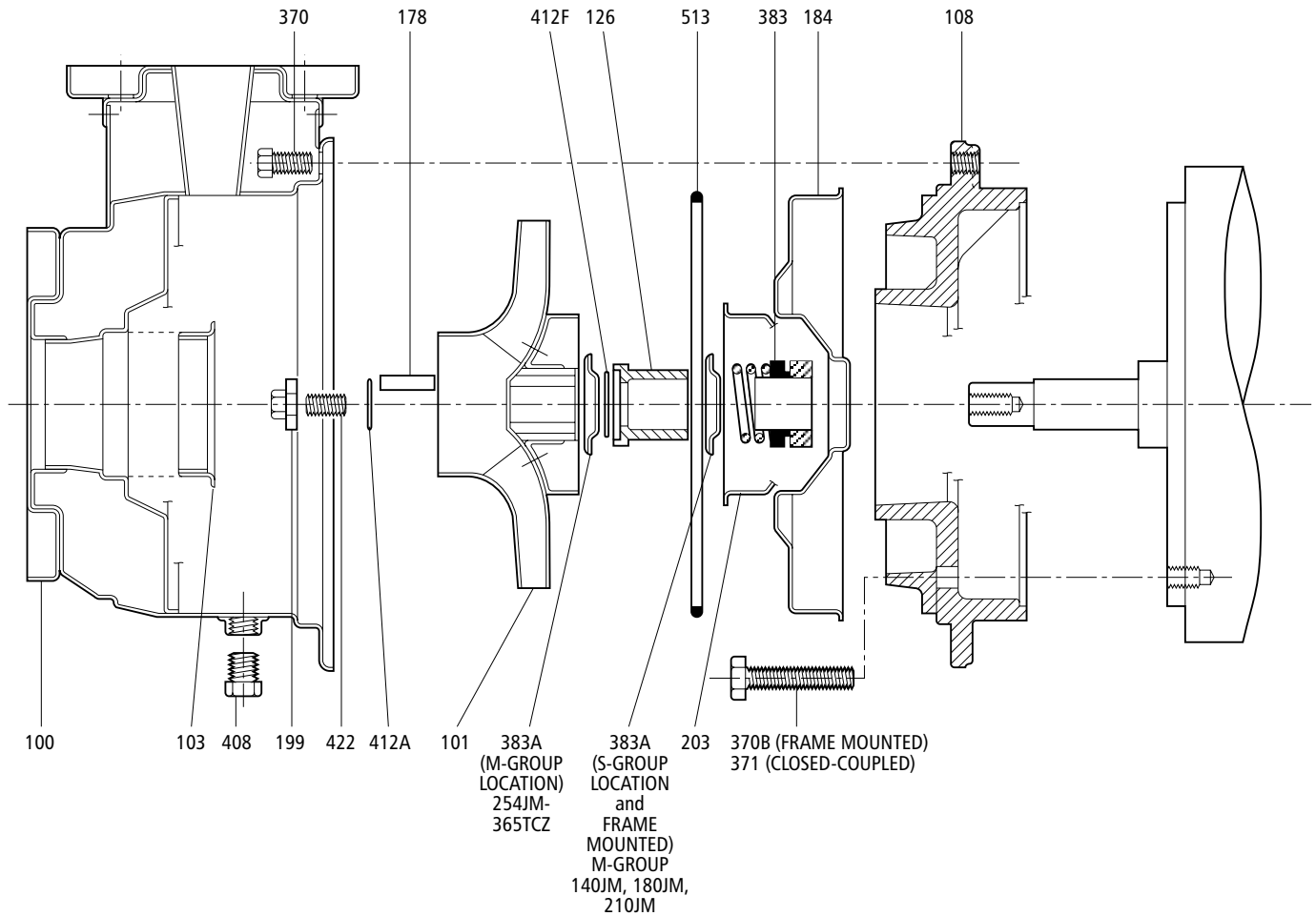

Goulds Pumps is a brand of ITT Water Technology, Inc.
- a subsidiary of ITT Industries, Inc.

Goulds Pumps, G&L Pumps and the ITT Engineered Blocks Symbol are registered trademarks and tradenames of ITT Industries.

SSH S-Group

Item No.	Part Description	Material	1 x 2-6		1½ x 2½-6		2 X 2½-6		2½ x 3-6		1 x 2-8		1½ x 2½-8		2 x 2½-8		1 x 2-10		Max. Wt. (lbs.)				
			9A-SH	*9SH	4SH	5SH	6SH	10A-SH	*10SH	7SH	8SH	11A-SH	*11SH										
100	Casing with wear ring		1L450		1L453		1L456		1L459		1L451		1L454		1L457		1L452		17				
101	Impeller	AISI Type 316SS	6⅝	2L889	2L734	6⅝	2L754	6⅝	2L766	7⅞	2L771	8⅞	2L898	8⅞	2L757	8⅞	2L770	10⅞	2L897	2L743	7		
			6⅞	2L888	2L733	6⅞	2L752	6⅞	2L765	7⅞	2L772	8⅞	2L893	2L739	7⅞	2L756	7⅞	2L769	9⅞	2L896		2L742	
			5⅞	2L887	2L731	6⅞	2L750	5⅞	2L763	6⅞	2L773	7⅞	2L892	2L737	7	2L755	7⅞	2L768	9⅞	2L895		2L741	
			5⅞	2L886	2L730	5⅞	2L749	5⅞	2L762	6⅞	2L774	7⅞	2L891	2L736	6⅞	2L754	7⅞	2L767	8⅞	2L894		2L740	
						5⅞	2L748	5⅞	2L761	6⅞	2L775	7⅞	2L890	2L735	6⅞	2L753	6⅞	2L766					
						4⅞	2L747	4⅞	2L760	6⅞	2L776					6⅞	2L751	6⅞	2L764				
						4⅞	2L746	4⅞	2L759	5⅞	2L777												
						4⅞	2L745	4⅞	2L758														
			3⅞	2L744																			
103	Wear ring, casing		4L465		4L466	4L467	4L468	4L465		4L466	4L467	4L465						1					
184	Seal housing with ring		1L465			1L469	1L472	1L466			1L470	1L467				3							
203	Wear ring, seal housing		4L201				4L464	4L201															
126	Shaft sleeve	316SS	4L473	4L456				4L473	4L456				4L473	4L456									
178	Key, impeller	Steel	4K555		4K11				4K555		4K11		4K555	4K11			1						
422	Stud, impeller		13K217																				
199	Washer, impeller	316SS	4L458																				
108	Motor adapter, 143-184JM and S-group brg. frame	Cast iron ASTM A48 cl. 20	1L554	1L50				1L99	1L560	1L52	1L99	1L562	1L97			25							
	Motor adapter, 213-256JM		1L555	1L51				1L98	1L561	1L53	1L98	1L563	1L96			29							
370	Bolt, casing	300SS	13L38 (8 req.)				13L89	13L38 (8 req.)				13L89 (8 req.)				-							
371 or 370B	Bolt, adapter, 143-184JM and S-Group brg. frame	Steel SAE 1200	13K360	13L43				13L43	13K360	13L43	13L43	13K360	13L43			25							
	Bolt, adapter, 213-256JM			13L41				13K245	13K361	13L40	13K245	13K361	13L40			29							
383	Mech. seal – standard	Type 21	10K27 – carbon/silicon-carbide/ viton														1						
	Mech. seal – high temp.		10K19 – Carbon/silicon-carbide/EPR																				
	Mech. seal – severe duty		10K64 – Silicon-carbide/silicon-carbide/ viton																				
383A	Retainer, seal spring	316SS	4L45																				
408	Plug, vent and drain	316SS	6L19				6L19 – Vent				6L3 – Drain				2								
412A	O-ring, impeller washer	Viton	5K320 standard (5K195 EPR option)														1						
412F	O-ring, shaft sleeve	Viton	5K307 standard (5K306 EPR option)																				
513	O-ring, casing – standard	Viton	5L42				5L70	5L43				5L70	5L71										
	O-ring, casing – optional	EPR	5L46				5K317	5L47				5K317	5L110										

* Obsolete pump sizes

SSH M-Group (254JM-365TCZ)

Item No.	Part Description	Material	1½ x 2½-10 24SH		2 x 2½-10 25SH		2½ x 3-8 22SH		2½ x 3-10 27SH		3 x 4-8 23SH		3 x 4-10 28SH		Max. Wt. (lbs.)
			1L455	1L458	1L460	1L461	1L463	1L464							
100	Casing, with wear ring	AISI Type 316L SS													17
101	Impeller		9⅞	2L778	9⅞	2L790	9⅞	2L808	10⅜	2L804	9⅞	2L825	10⅞	2L836	8
			9½	2L779	9½	2L791	8¾	2L809	9⅞	2L805	8⅞	2L826	10¼	2L837	
			9⅜	2L780	9⅞	2L792	8½	2L810	9⅞	2L806	8⅞	2L827	9⅜	2L838	
			8⅞	2L781	8⅞	2L793	8¼	2L811	9¼	2L807	8⅞	2L828	9⅞	2L839	
			8⅞	2L782	8⅞	2L794	7⅞	2L812	8¾	2L809	7⅞	2L829	9⅞	2L825	
			8¼	2L783	7⅞	2L795	7½	2L813			7½	2L830	8⅞	2L826	
					7⅞	2L796	7⅞	2L814			7⅞	2L831			
							6⅞	2L815			6⅞	2L832			
							6½	2L816			6½	2L833			
											6	2L834			
									5½	2L835					
103	Wear ring, casing			4L467		4L468		4L469						1	
184	Seal housing, with ring			1L468		1L473	1L475	1L477	1L478					3	
203	Wear ring, seal housing		4L201		4L464										
126	Shaft sleeve	316 SS			4L457								1		
178	Key, impeller	Steel			4K261										
198	Stud, impeller				13K301										
199	Washer, impeller	316 SS			4L463										
108	Motor adapter, 254-256JM and M-Group bearing frame	Cast iron ASTM A48 cl. 20	1L91		1L89	1L93		1L94						31	
	Motor adapter, 280JM-365TCZ		1L90		1L88	1L92		1L95						44	
370	Bolt, casing	300 SS	13L86 (6 req'd)		13L89 (8 req'd)		13L86 (8 req'd)						–		
371 or 370B	Bolt, adapter, 254-256JM and S-Group bearing frame	Steel SAE 1200	13L88		13L116								–		
	Bolt, adapter, 280JM-365TCZ		13L87		13L115								–		
383	Mech. seal – standard	Type 21			10K45 – carbon/silicon-carbide/viton								1		
	Mech. seal – high temp.				10K20 – Carbon/silicon-carbide/EPR										
	Mech. seal – severe duty				10K65 – Silicon-carbide/silicon-carbide/viton										
383A	Retainer, seal spring	316SS			4K500								1		
408	Plug, vent and drain	316SS			6L19										
412A	O-ring, impeller washer	Viton			5K309 standard (5K308 EPR option)										
412F	O-ring, shaft sleeve	Viton			5K309 standard (5K308 EPR option)										
513	O-ring, casing – standard	Viton	5L71		5L70	5L71		5L72							
	O-ring, casing – optional	EPR	5L110		5K317	5L110		5L116							

SSH M-Group

(140JM, 180JM & 210JM)

Item No.	Part Description	Material	1½ x 2½-10 24SH	2 x 2½-10 25SH	2½ x 3-8 22SH	2½ x 3-10 27SH	3 x 4-8 23SH	Max. Wt. (lbs.)					
100	Casing, with wear ring	AISI Type 316L SS	1L455		1L458		1L460		1L461		1L463		17
101	Impeller		9⅞	2L784	9⅞	2L797	9⅞	2L820	9⅞	2L817	9⅞	2L840	8
			9½	2L785	9½	2L798	8½	2L822	9⅞	2L818	8⅞	2L841	
			9⅜	2L786	9⅜	2L799	8¼	2L823	9¼	2L819	8⅞	2L842	
			8⅞	2L787	8⅜	2L800	7⅞	2L824	8¼	2L821	7½	2L843	
			8⅞	2L788	8⅜	2L801	7⅞	2L772			7⅞	2L844	
			8¼	2L789	7⅞	2L802	6⅞	2L774			6½	2L845	
					7⅞	2L803					6	2L846	
									5½	2L847			
103	Wear ring, casing			4L467			4L68			4L69			1
184	Seal housing, with ring		1L467			1L472		1L474		1L476		3	
203	Wear ring, seal housing		4L201			4L421			4L424			1	
126	Shaft sleeve	316SS	4K501			4L456							
178	Key, impeller	Steel	4K11										
198	Stud, impeller		13K217										
199	Washer, impeller	316 SS	4L458										
108	Motor adapter, 143-184JM and S-group bearing frame	Cast iron ASTM A48 cl.20	1L97			1L99		N/A		1L123			25
	Motor adapter, 213-256JM		1L96			1L98		1L100					29
370	Bolt, casing	300 SS	13L86 (8 req'd)			13L89 (8 req'd)		13L86 (8 req'd)					–
371 or 370B	Bolt, adapter, 143-184JM and S-group bearing frame	Steel SAE 1200	13L43				N/A		13L117				–
	Bolt, adapter, 213-256JM		13K245				13K245		13K44				–
383	Mechanical seal – standard	Type 21	10K27 – carbon/silicon-carbide/ viton									1	
	Mechanical seal – high temp.		10K19 – Carbon/silicon-carbide/EPR										
	Mechanical seal – severe duty		10K64 – Silicon-carbide/silicon-carbide/viton										
383A	Retainer, seal spring	316 SS	4L45									1	
408	Plug, vent and drain	316 SS	6L19										
412A	O-ring, impeller washer	Viton	5K320 standard (5K195 EPR option)										
412F	O-ring, shaft sleeve	Viton	5K320 standard (5K195 EPR)				5K307 standard (5K306 EPR option)						
513	O-ring, casing – standard	Viton	5L71			5L70		5L71					
	O-ring, casing – optional	EPR	5L110			5K317		5L110					