

CONTENTS

ENGINE COOLING

INDEX

HOME

NEXT

BACK

SHERWOOD OMC 4 Cylinder



G-9901
6 1/2" Diameter Pulley
Volvo # 3852398

Part No.	Description	Qty
9959K	Impeller	1
12859	Mechanical Seal	1
4264	Seal Spacer	1
12231	Cover O-Ring	1
12855	Gasket	1
12856	Wearplate	1
15883	Cam	1
10515C	Cam Screw	1
4432	Key	1
12211	Ball Bearing	2
5133	Bearing Spacer	1
4258	Snap Ring (SM)	3
4259	Snap Ring (LG)	2
12857	Cover Bolts	3
12710	Lock Washers	3
13363	Shaft	1
21154	Pulley	1
G9901MNK	Minor Service Kit	1
G9901MJK	Major Service Kit	1

SHERWOOD OMC 6 - 8 Cylinder



G-9903 (Old # G-9902)
4 1/2" Diameter Pulley
Volvo # 3855079 (G9903)
Volvo # 3852399 (G9902)

Part No.	Description	Qty
9959K	Impeller	1
12859	Mechanical Seal	1
4264	Seal Spacer	1
12231	Cover O-Ring	1
12855	Gasket	1
12856	Wearplate	1
15883	Cam	1
10515C	Cam Screw	1
4432	Key	1
12211	Ball Bearing	2
5133	Bearing Spacer	1
4258	Snap Ring (SM)	3
4259	Snap Ring (LG)	2
12857	Cover Bolts	3
12710	Lock Washers	3
13363	Shaft	1
21175	Pulley	1
G9903MNK	Minor Service Kit	1
G9903MJK	Major Service Kit	1

JOHNSON OMC 4, 6 and 8 Cylinder

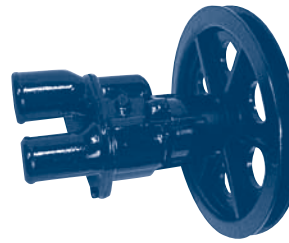

With 4 1/2" or 6 1/2" Pulley
Volvo # 3851623-3 (6 1/2" Pulley)
Volvo # 3857794 (4 1/2" Pulley)

Part No.	Description	Qty
1027B	Impeller	1
DP 3851702-5	Gasket	1
05-04-174	Cam Screw	1
05-08-123	Ball Bearing	2
01-45329	Full Cam	1
01-45656	1/2 Cam	1
05-29-105	Seal	2

Complete pump is discontinued.
Replaced by: G9901 (6 1/2" pulley)
G9903 (4 1/2" pulley)

JOHNSON 43 / 50 / 57 / 74 / 82 8.1L / 3.0L



10-13223/10-13236
10-13223 (Serpentine Belt)
10-13236 (V-Belt)

Part No.	Description	Qty
1027B	Impeller	1
05-06-597	O-Ring	1
05-04-660	Screw	4

JOHNSON

MD 70B & C / TAMD 70 / AQD 70C
TMD 70B & C / MD 100B / TMD 100A

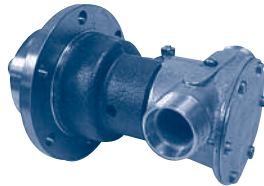

10-24017

Volvo # 837370 / 837916 (10-24017-3)
Volvo # 837371 / 837915 (10-24017-4)
Volvo # 837922 / 837923 (10-24017-4)

Part No.	Description	Qty
1028B	Impeller	1
01-42445	Gasket	1
09-20-115	Mechanical Seal	1
05-34-105	Seal Snap Ring	1
05-08-118	Ball Bearing	2
05-34-118	Snap Ring	1
05-29-108	Bearing Seal	1
01-42402	Slinger	1
01-42441	End Cover	1
05-04-117	Cover Screws	6
01-42679	Full Cam (10-24017-3)	1
01-42442	2/3 Cam (10-24017-4)	1
05-04-144	Cam Screw	1
01-42443	Wearplate	1
01-42400	Wearplate Pin	1
01-31964	Shaft	1
05-04-105	Clamp Bolt	1
05-05-115	Clamp Nut	1
05-01-115	Clamp Washer	1
10-24017MNK	Minor Service Kit	1
10-24017-3MJK	Major Service Kit	1
10-24017-4MJK	Major Service Kit	1

JOHNSON

MD 30 & 30A / AQD 40DP
THAMD 70, B, C / TIMD 96B

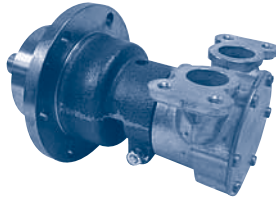

10-22335

Volvo # 836326 (10-22335-3)
Volvo # 842274 / 842275 (10-22335-4)

Part No.	Description	Qty
1028B	Impeller	1
01-42445	Gasket	1
09-20-115	Mechanical Seal	1
05-34-105	Seal Snap Ring	1
05-08-118	Ball Bearing	2
05-34-118	Snap Ring	1
05-29-108	Bearing Seal	1
01-42402	Slinger	1
01-42441	End Cover	1
05-04-117	Cover Screws	6
01-42679	Full Cam (10-22335-3)	1
01-42442	2/3 Cam (10-22335-4)	1
05-04-144	Cam Screw	1
01-42443	Wearplate	1
01-42400	Wearplate Pin	1
01-31964	Shaft	1
05-04-105	Clamp Bolt	1
05-05-115	Clamp Nut	1
05-01-115	Clamp Washer	1
10-22335MNK	Minor Service Kit	1
10-22335-3MJK	Major Service Kit	1
10-22335-4MJK	Major Service Kit	1

JOHNSON

MD 100, A, BK / TMD 100A
TMD 120 / TAMD 120 & 120A

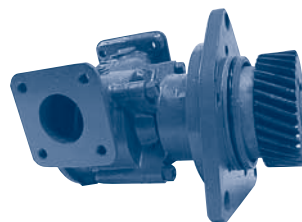

10-21915-2

Volvo # 8227871 / 837917 / 837920

Part No.	Description	Qty
819B	Impeller	1
01-42424	Gasket	1
09-20-118	Mechanical Seal	1
05-34-108	Seal Snap Ring	1
05-08-118	Ball Bearing	2
05-34-118	Snap Ring	1
05-29-108	Bearing Seal	1
01-42427-15	Slinger	1
01-42422-1	End Cover	1
05-04-46	Cover Screws	5
01-42425	Cam	1
05-04-108	Cam Screw	1
01-42423	Wearplate	1
01-42426	Wearplate Pin	1
01-32020	Shaft	1
05-04-128	Body Bolts	1
10-21915MNK	Minor Service Kit	1
10-21915-2MJK	Major Service Kit	1

JABSCO

MD 71, TMD 71, TAMD 61 and 71

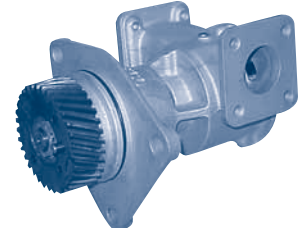

10770 Series

Volvo # 822787 / 820694 / 846354
846355 / 846356 / 866739
3829310 / 3829311

Part No.	Description	Qty
17935-0001	Impeller	1
816-0000	Gasket	1
6408-0000	Mechanical Seal	1
92600-0260	Ball Bearing	2
SP2701-54	Bearing Seal	1
3181-0000	Slinger	1
12062-0000	End Cover	1
91005-0040	Cover Screws	6
834-0001	Cam	1
91005-0040	Cam Screw	1
2574-0000	Wearplate	1
11256	Shaft	1
18725-0000	Snap Ring	1
10770MNK	Minor Service Kit	1
10770MJK	Major Service Kit	1