

# JOHNSON RUBBER IMPELLER PUMPS

CONTENTS

ENGINE COOLING

INDEX

HOME

NEXT

BACK

## F35B-8007

3/8" Ports (4 gpm at 1800 rpm)

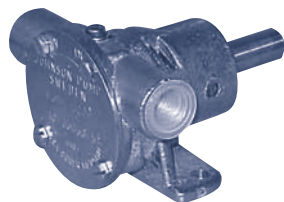

10-35038-4 (3/8" Shaft)  
10-35038-5E (12mm Shaft)

Part No.	Description	Qty.
808B	Impeller (Neoprene)	1
01-45069	Shaft (12mm)	1
01-46416	Shaft (3/8")	1
01-43239	Cover	1
01-43240	Gasket	1
01-42910	Cam Full Thickness	1
01-42415	Cam 1/2 Thickness	1
01-45050	Spacer Inner	1
01-45049	Spacer Outer	1
05-04-642	Screw (Cover)	4
05-04-114	Cam Screw	1
05-29-139	Lip Seal	1
05-06-513	O-Ring	1
05-08-130	Ball Bearing	2
05-34-131	Snap Ring	1
01-45087	Wearplate	1

## F4B-8007

3/8" Ports (6 gpm at 1800 rpm)

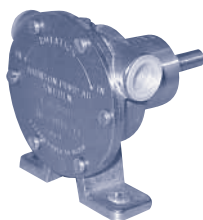

10-24074-7 (3/8" Shaft)  
10-24074-1 (12mm Shaft)

Part No.	Description	Qty.
810B	Impeller (Neoprene)	1
810B-9	Impeller (Nitrile)	1
01-45069	Shaft (12mm)	1
01-46416	Shaft (3/8")	1
01-42398	Cover	1
01-42391	Gasket	1
01-42389	Cam Full Thickness	1
01-45084	Cam 1/2 Thickness	1
01-45288	Cam 2/3 Thickness	1
01-45050	Spacer Inner	1
01-45049	Spacer Outer	1
05-04-642	Screw (Cover)	6
05-04-115	Cam Screw (Full)	1
05-04-642	Cam Screw (1/2)	1
05-04-114	Cam Screw (2/3)	1
05-29-139	Lip Seal	1
05-06-513	O-Ring	1
05-08-130	Ball Bearing	2
05-34-131	Snap Ring	1

## F5B-8007

3/4" Ports (12 gpm at 1800 rpm)

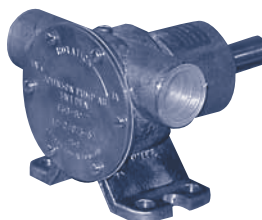

10-24073-5 (5/8" Shaft)

Part No.	Description	Qty.
1027B	Impeller (Neoprene)	1
1027B-9	Impeller (Nitrile)	1
01-45045	Shaft (17mm)	1
01-42398	Cover	1
01-42401	Gasket	1
01-42397	Cam Full Thickness	1
01-45014	Cam 1/2 Thickness	1
01-45046	Spacer Inner	1
01-45047	Spacer Outer	1
05-04-642	Screw (Cover)	6
05-04-117	Cam Screw (Full)	1
05-04-175	Cam Screw (1/2)	1
05-29-105	Lip Seal	1
05-06-501	O-Ring	1
05-08-128	Ball Bearing	2
05-34-130	Snap Ring (Large)	1
05-34-21	Snap Ring (Small)	1

## F7B-8007

1" Ports (26 gpm at 1800 rpm)



10-24070-5 (5/8" Shaft)

Part No.	Description	Qty.
1028B	Impeller (Neoprene)	1
1028B-9	Impeller (Nitrile)	1
01-45045	Shaft (17mm)	1
01-42441	Cover	1
01-42445	Gasket	1
01-42679	Cam Full Thickness	1
01-42442	Cam 2/3 Thickness	1
01-45046	Spacer Inner	1
01-45047	Spacer Outer	1
05-04-174	Screw (Cover)	6
05-04-107	Cam Screw (Full)	1
05-04-144	Cam Screw (2/3)	1
05-29-105	Lip Seal	1
05-06-501	O-Ring	1
05-08-128	Ball Bearing	2
05-34-130	Snap Ring (Large)	1
05-34-21	Snap Ring (Small)	1

## F35B (New Version)

3/8" Ports (4 gpm at 1800 rpm)



10-24569

Part No.	Description	Qty.
808B	Impeller	1
05-06-618	O-Ring	1
09-20-542	Mechanical Seal	1
01-46735-1	Shaft	1
01-46739-2	End Cover	1
01-42910	Cam	1
01-45542	Spacer	1
01-42400	Pin	1
01-46676	Wearplate	1
01-45049	Plate	1
04-45659	Washer	1
01-46790-01	Washer	1
05-04-642	Screw	4
05-04-107	Cam Screw	1
05-06-513	O-Ring	1
05-08-130	Ball Bearing	2
05-34-131	Int. Snap Ring	2
05-34-501	Ext. Snap Ring	2

## F4B (New Version)

3/8" Ports (6 gpm at 1800 rpm)

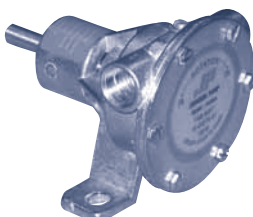

10-24570

Part No.	Description	Qty.
810B	Impeller	1
01-46735-1	Shaft	1
01-46007-2	End Cover	1
01-42389	Cam	1
01-45542	Spacer	1
01-42400	Pin	1
01-46737-2	Wearplate	1
01-45049	Seal Spacer Plate	1
01-45659	Seal Washer	1
01-46790-01	Cam Screw Washer	1
0.0279.300	Cover Screw	6
01-46794-04	Cam Screw	1
0.2173.476	Cover O-Ring	1
0.2173.432	Slinger O-Ring	1
0.3431.748	Ball Bearing	2
0.2247.021	Mechanical Seal	1
0.0370.012	Snap Ring (SMI)	2
0.0371.028	Snap Ring (LG)	1
05-29-139	Lip Seal	1

## F5B (New Version)

3/4" Ports (12 gpm at 1800 rpm)



10-24571

Part No.	Description	Qty.
1027B	Impeller	1
01-46744	Shaft	1
01-46747-2	End Cover	1
01-42397	Cam	1
01-42400	Pin	1
01-42399-2	Wearplate	1
01-45680	Seal Washer	1
01-45047	Bearing Plate	1
01-46009	Bearing Spacer	1
0.0279.300	Cover Screw	6
01-46794-05	Cam Screw	1
0.2173.475	Cover O-Ring	1
0.2173.402	Sling O-Ring	1
0.3431.742	Ball Bearing	2
0.2247.022	Mechanical Seal	1
0.0370-017	Snap Ring (SM)	1
0.0371.040	Snap Ring (LG)	1
0.0370.516	Snap O-Ring (Seal)	1
05-29-143	Lip Seal	1

## F7B (New Version)

1" Ports (26 gpm at 1800 rpm)

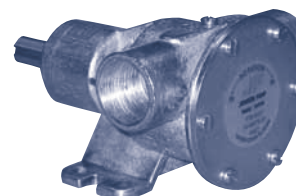

10-24572

Part No.	Description	Qty.
1028B	Impeller	1
01-46744	Shaft	1
01-46648-3	End Cover	1
01-42679	Cam	1
01-42400	Pin	1
01-46798-2	Wearplate	1
01-45680	Seal Washer	1
01-45047	Bearing Plate	1
01-46009	Bearing Spacer	1
0.0279.301	Cover Screw	6
01-46794-01	Cam Screw	1
0.2172.012	Cover O-Ring	1
0.2173.402	Sling O-Ring	1
0.3431.742	Ball Bearing	2
0.2247.022	Mechanical Seal	1
0.0370.017	Snap Ring (SM)	1
0.0371.040	Snap Ring (LG)	1
0.0370.516	Snap O-Ring (Seal)	1
0.2233.012	Lip Seal	1