

GRAY, FLAGSHIP AND GLASTRON PUMPS

CONTENTS

ENGINE COOLING

INDEX

HOME

NEXT

BACK

SHERWOOD Gray Marine

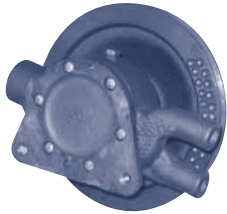

N-10460(CCW) / N-10470(CW)
Gray # G80301 / Gray # G80300
Compact V-8
215, 225

Part No.	Description	Qty
9959K	Impeller	1
10512	Gasket	2
10514C	Water Seal	1
10513	Bearing Seal	1
4257	Ball Bearing	2
4432	Key	1
258	Snap Ring (SM)	1
4259	Snap Ring (LG)	1
8296	Cover Screw	6
10506	Shaft	1
10508	Cover	1
10072	Cam	1
10515	Cam Screw	1
336	Plug	1

JABSCO Gray Marine



8830-0701 / 8830-0711

Compact V-8
VHC-215, VHC-225

Part No.	Description	Qty
8980-0005	Impeller	1
92700-0060	Seal	1
92000-0210	Seal O-Ring	1
8641-0000	Gasket	1
8493-0000	Wearplate	1
3286-0000	Slinger	1
11839-0000	End Cover	1
91026-0010	Cover Screw	6
8528-0000	Cam	1
91030-0110	Cam Screw	1
93000-0070	Bearing Seal	1
92600-0070	Bearing	1
18714-0000	Snap Ring	1
91401-0030	Key	1
8527	Shaft	1
5668-0010	Pulley	1

SHERWOOD Gray Marine



Q10840

Gov. Engine
Gray # G80561

Part No.	Description	Qty
10077K	Impeller	1
10286	Gasket	1
11628	Water Seal	1
10859	Bearing Seal	1
4306	Ball Bearing	2
10858	Shaft	1
10285	Cam	1
10195	Cam Screw	1
10593	End Cover	1
344	Cover Screw	6
10093	Key	1
4303	Snap Ring (LG)	1
4304	Snap Ring (SM)	1

REPLACEMENT IMPELLERS Gray Marine



Gray Impeller Cross-Reference

Gray Part No.	Depco Part #
74306	JA 1210-0001
74316	JA 4528-0001
74326	JA 18673-0001
74340	JA 920-0008
74366	JA 4568-0001
74380	JA 5616-0001

Impeller Puller.....page 161

JABSCO

Owens - Flagship V-8



12280-0001

Flagship

Part No.	Description	Qty
920-0001	Impeller	1
91003-0010	Screw	6
12294-0000	End Cover	1
12288-0000	Gasket	1
12287-0000	Shaft	1
12284-0000	Body	1
96080-0080	Seal	1
913-0000	Bearing Seal	1
92600-0060	Bearing	1
18724-0000	Retaining Ring	1
9103-0000	Gear	1
93100-0040	Roll Pin	1

JABSCO

Owens - Flagship V-8



14210-0001

Flagship

Part No.	Description	Qty
1210-0001	Impeller	2
91002-0020	Screw	6
11830-0000	End Cover	1
3298-0000	Gasket	1
7038-0000	Wearplate	2
96080-0080	Seal	1
14217-0000	Shaft	1
913-0000	Bearing Seal	1
92600-0060	Bearing	1
9103-0000	Gear	1
93100-0040	Roll Pin	1
18724-0000	Retaining Ring	1
6148-0040	Cam	2
91003-0070	Screw (Cam)	2

JABSCO

Ford 302 / 351 C.I.



17410 Series

Glastron 190 / 255

Part No.	Description	Qty
3085-0001	Impeller	1
9215-0000	Key (Shaft)	1
18753-0131	Retaining Ring	1
17103-2000	Bearing Housing	1
17388-0010	Shaft & Bearing Assy	1
96080-0080	Seal	1
17404-0000	Body	1
17232-0000	End Cover	1
91602-0130	Lock Washer	3
91095-0540	Bolt (Hex Head)	3
17847-0000	Wearplate (Stainless) .N/A	1
17408-0000	Gasket	1
	(End Cover & Body)	2
17848-0000	Gasket (Wearplate)	1
18730-0000	O-Ring	1

SHERWOOD

Ford 121 / 182 / 302 C.I.



G-95-1

Glastron

(Also Chris-Craft #16.80-18348)

Part No.	Description	Qty
9959K	Impeller	1
12859	Mechanical Seal	1
4264	Seal Spacer	1
12231	Cover O-Ring	1
12855	Gasket	1
12856	Wearplate	1
15883	Cam	1
10515	Cam Screw	1
4432	Key	1
12211	Ball Bearing	2
5133	Bearing Spacer	1
4258	Snap Ring (SM)	3
4259	Snap Ring (LG)	2
12857	Cover Bolts	3
12710	Lock Washers	3
12664	Shaft	1
11543	Pin	1