

MERCURISER / HINO ENGINE PUMPS

CONTENTS

PUMPING PRINCIPLES

ENGINE COOLING

ENGINEERING TABLES

TROUBLE-SHOOTING GUIDE

INDEX

HOME

NEXT

BACK

SHERWOOD (7.3 Diesel)



G-151

Part #	Description	Qty
15000K	Impeller	1
12859	Mechanical Seal	1
4264	Seal Washer	1
12231	O-Ring	1
12855	Gasket	1
12856	Wearplate	1
4258	Snap Ring (SM)	3
4259	Snap Ring (LG)	2
12211	Ball Bearing	2
5133	Bearing Spacer	1
4432	Impeller Key	1
19570	Shaft	1
18314	Cam	1
10515C	Cam Screw	1
15055	Pulley	1
12857	Cover Bolt	3
12710	Washer	3

SHERWOOD (7.3 Diesel)



G-155

Part #	Description	Qty
15000K	Impeller	1
12859	Mechanical Seal	1
4264	Seal Washer	1
12231	O-Ring	1
12855	Gasket	1
12856	Wearplate	1
4258	Snap Ring (SM)	3
4259	Snap Ring (LG)	2
12211	Ball Bearing	2
5133	Bearing Spacer	1
4432	Impeller Key	1
19570	Shaft	1
18314	Cam	1
10515C	Cam Screw	1
15055	Pulley	1
12857	Cover Bolt	3
12710	Washer	3

GENERAC (Mercruiser Generator)

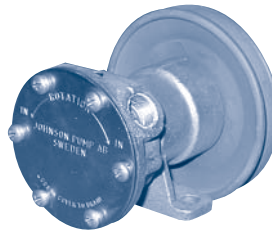

Mercruiser 46-810800

Part #	Description	Qty
MC 47-810567	Impeller	1
MC 27-810569	Gasket	1
MC 26-810574	Oil seal	1
MC 30-810579	Bearing (Pulley side)	1
MC 30-810580	Bearing (Impeller side)	1
MC 810578	Cam	1
MC 25-810575	O-Ring	1

Complete pump is discontinued. Retrofit pump is available. Call for information.

MERCURISER / HINO KASHIYAMA

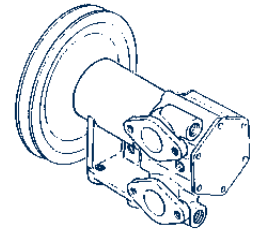

1690-1659R

Only Impeller Available
Depco Part # JA 31130-0061
Hino Part # 16131-1350
Mercruiser Part # 47-831311350

See page 151, Silhouette CC for impeller dimensions.

JOHNSON (Hino W04CT / W04D)

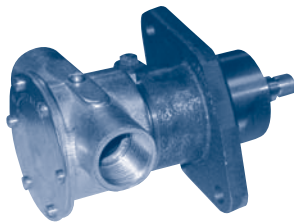

10-24253

Part #	Description	Qty
1028B	Impeller	1
01-42445	Gasket	1
09-20-115	Mechanical Seal	1
01-45174	Seal Washer	1
05-34-105	Seal Snap Ring	1
01-42679	Cam	1
05-04-107	Cam Screw	1
01-42441	Cover	1
05-04-117	Cover Screws	6
01-42443	Wearplate	1
01-42400	Wearplate Pin	1
01-42402	Slinger	1
05-08-21	Ball Bearings	2
01-42537	Bearing Spacer	1
05-29-519	Bearing Seal	1
05-34-21	Snap Ring (SM)	1
05-34-117	Snap Ring (LG)	1
05-04-105	Clamp Screw	1
05-01-115	Clamp Washer	1
05-05-115	Clamp Nut	1
01-35220	Shaft	1
05-03-514	Shaft Key	1

JOHNSON (Hino W04C-T120 / 3000)

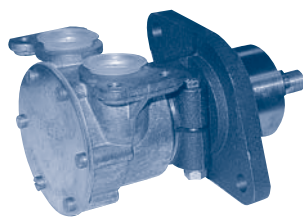

10-24365

Part #	Description	Qty
1028B	Impeller	1
01-42445	Gasket	1
09-20-115	Mechanical Seal	1
01-45174	Seal Washer	1
05-34-105	Seal Snap Ring	1
01-42679	Cam	1
05-04-107	Cam Screw	1
01-42441	Cover	1
05-04-117	Cover Screws	6
01-42443	Wearplate	1
01-42400	Wearplate Pin	1
01-42402	Slinger	1
05-08-21	Ball Bearings	2
01-42537	Bearing Spacer	1
05-29-519	Bearing Seal	1
05-34-21	Snap Ring (SM)	1
05-34-117	Snap Ring (LG)	1
05-04-105	Clamp Screw	1
05-01-115	Clamp Washer	1
05-05-115	Clamp Nut	1
01-35220	Shaft	1
05-03-514	Shaft Key	1
01-46138	Port Flange Gasket	1

JOHNSON (Hino W06D-T1 Series)

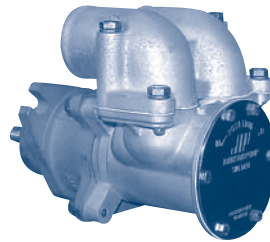

10-24413-2

Part #	Description	Qty
821B	Impeller	1
01-46286	Gasket	1
09-20-505	Mechanical Seal	1
01-46146	Cam	1
05-04-638	Cam Screw	1
01-46285	Cover	1
05-04-550	Cover Screws	6
01-42443	Wearplate	1
01-42400	Wearplate Pin	1
01-42427-15	Slinger	1
05-08-26	Bearing (SM)	1
05-08-513	Bearing (LG)	1
01-46284-1	Bearing Spacer	1
05-29-526	Bearing Seal	1
05-34-108	Snap Ring (SM)	1
05-34-118	Snap Ring (LG)	1
01-35685	Shaft	1
05-03-514	Shaft Key	1
01-46291	Port Flange Gasket	1

MERCURISER / HINO (Replacement Impellers)

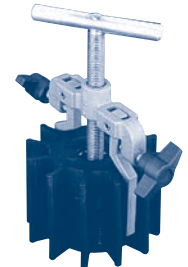

Impeller Cross Reference

Manufacturer Part #	Depco Part #
16131-1300	BA 845
16131-1350	JA 31130-0061
47-8013326-01	JA 17937-0001
47-831311350	JA 31130-0061
47-59362	MC 47-59362
47-853126	SH 15000K

Impeller PullerPage 149