

JABSCO



100,000 - 200,000 NON-METALLIC SEARCHLIGHTS

The JabSCO "SL" series searchlights offer three sizes that deliver up to 200,000 candlepower in a corrosion resistant, non-metallic housing. The 135 SL will rotate up to 320° horizontally and 75° in a vertical sweep. The 146 & 255 SL series rotate a full 360° horizontally and 60° in a vertical sweep. All models are available with an optional secondary control panel for dual helm stations.

Model Number	Light Series	Candlepower	Volts DC	Amp Draw	Replacement Light Bulb
JA 60020-0000	135SL	100,000	12	3.6	JA 18753-0178
JA 60020-0024	135SL	100,000	24	2.0	JA 18753-0178
JA 60080-0012	146SL	175,000	12	4.0	JA 18753-0455
JA 60080-0024	146SL	175,000	24	2.0	JA 18753-0455
JA 60010-2012	255SL	200,000	12	8.0	JA 18753-0336
JA 60010-2024	255SL	200,000	24	4.0	JA 18753-0336

JABSCO



Chrome Series

100,000 CANDLEPOWER CHROME SEARCHLIGHT

The JabSCO 62022 series 5" lights have a motorized drive that is completely enclosed in the light housing, a zinc base, and a polished chrome finish. The watertight control features a fingertip control lever for 370° horizontal sweep and 65° vertical motion, and a dual speed switch for precise beam control in conjunction with an on/off switch for spot or flood beam. (Additional cable & dual station controls available – see below).

Light Model Number w/66120-0000 control	Light Model Number w/43670-0003 control	Volts DC	Amps	Replacement Bulb
JA 62022-3002	JA 62022-4002	12	8.2	JA 67296-0000

Cable Length	10" Cable Assy	15" Cable Assy	25" Cable Assy	35" Cable Assy
Part Number	JA 43990-0013	JA 43990-0014	JA 43990-0015	JA 43990-0016

JABSCO

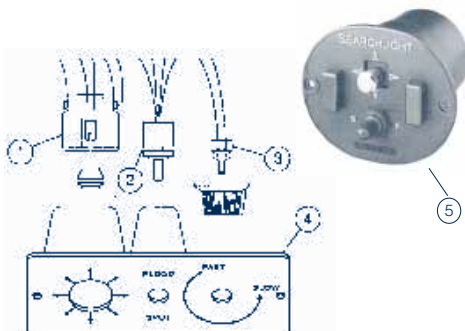

CONTROL PANEL SWITCH

These replacement and secondary control panel switches are specifically for JabSCO searchlights. The 66120-0000 has been used for decades and is easily repairable. The 43670 series are a sealed assembly built for long life in the marine environment.

Key	Model Number	Description
1	JA 43990-0000	Replacement directional switch for 66120-0000
2	JA 66150-0000	Replacement spot/flood switch for 66120-0000
3	JA 66153-0000	Replacement speed control for 66120-0000
4	JA 66154-0000	Replacement face plate for 66120-0000
5	JA 43670-0003	12V / 24V single station control
5	JA 43670-0004	12V / 24V dual station control
5	JA 43670-0005	12V dual station control for 135SL

SERVICE PARTS FOR JABSCO CHROME SEARCHLIGHTS

Key	Description	62022-3&4 Series	62026-3&4 Series	62040-Series	62042-Series
1	Base – Zinc	66130-0000			
	Base – Brass		43990-0030	43990-0031	43990-0031
2	Housing (inc. 7&8)	43990-0032	43990-0032	43998-0000	43966-0000
3	Screw kit for hsg	66138-0000	66138-0000	66138-0000	66138-0000
4	Boot inc. fasteners	43990-0045	43990-0045	43990-0046	43990-0046
5	Mtr/Clutch assy.	43990-0075	43990-0075	43990-0076	43990-0076
6	Mtr & pinion kit	43990-0078	43990-0078	43990-0078	43990-0078
7	Bulb snap ring	66149-0000	66149-0000	43990-0039	43990-0040
8	End bell			See key #2	See key #2
9	Gasket (base mt.)	66155-0000	66156-0000	66157-0000	66157-0000
10	Bulb 12V	67296-0000	67296-0000	67262-0000	67524-0000
	Bulb 24V			18753-0447	98040-0520
11	Power relay 12V				43789-0000
*	Gear & Clutch (Not shown)		43990-0069	43990-0069	43990-0069
*	Replacement Switch – See above				

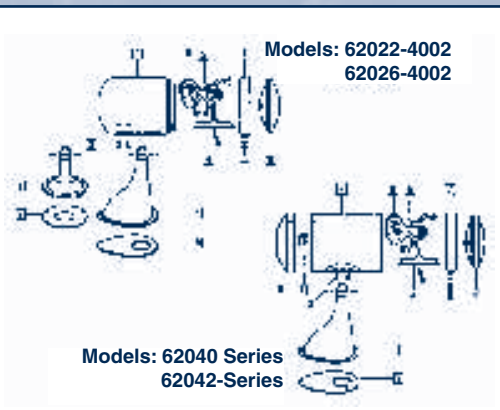

See page 139 for complete selection of bulbs!