

MAGNETIC DRIVE CENTRIFUGALS

CONTENTS

UP TO 160 GPM, 180' TDH

- Temperatures to 250 °F
- Viscosities to 100 cps, specific gravities to 1.8
- 1 1/2" x 1" 150 lb. flanged ductile iron casing
- Tefzel® lined casing, impeller and containment barrier
- Viton®, EPDM, Aflas® and Kalrez® elastomers
- Couples direct to NEMA C-Face, IEC motors or bearing pedestal for long coupling

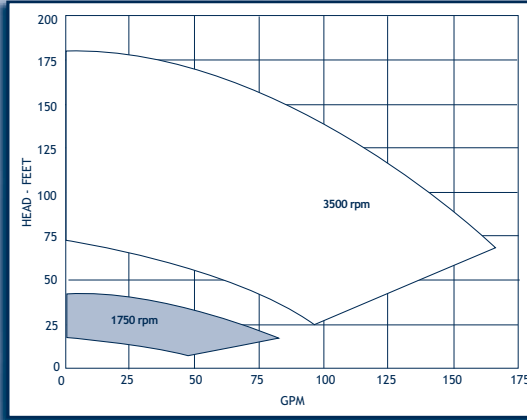

FTI ULTRACHEM SERIES



UC1516 6" Impeller

INDEX

NEXT

BACK

HOME

UP TO 325 GPM, 170' TDH

- Temperatures to 250 °F
- Viscosities to 100 cps, specific gravities to 1.8
- 3" x 2" 150 lb. flanged ductile iron casing
- Tefzel® lined casing, impeller and containment barrier
- Viton®, EPDM, Aflas® and Kalrez® elastomers
- Couples direct to NEMA C-Face, IEC motors or bearing pedestal for long coupling

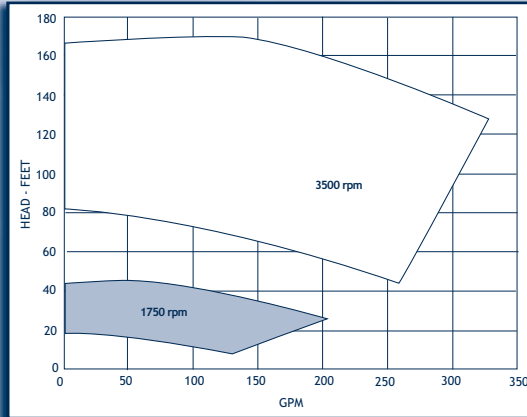

FTI ULTRACHEM SERIES

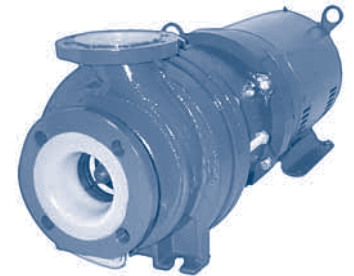

UC326 6" Impeller

UP TO 170 GPM, 320' TDH

- Temperatures to 250 °F
- Viscosities to 100 cps, specific gravities to 1.8
- 1 1/2" x 1" 150 lb. flanged ductile iron casing
- Tefzel® lined casing, impeller and containment barrier
- Viton®, EPDM, Aflas® and Kalrez® elastomers
- Couples direct to NEMA C-Face, IEC motors or bearing pedestal for long coupling

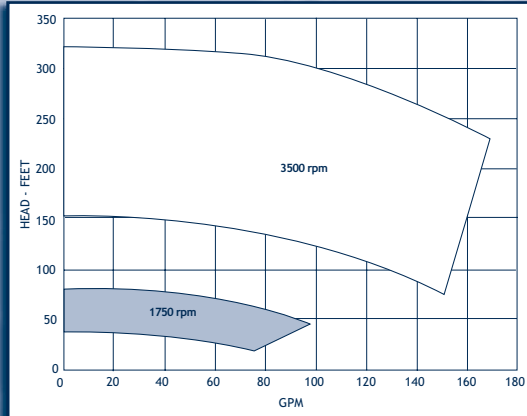

FTI ULTRACHEM SERIES

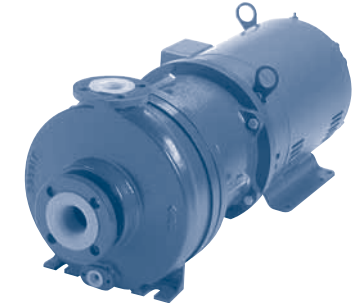

UC1518 8" Impeller

UP TO 60 GPM, 100' TDH

- Temperatures to 220 °F (MSKC) and 140 °F (MSVKC)
- Specific gravities to 1.8
- Polypropylene or Kynar (PVDF)
- 10 minute dry run with carbon bearing
- Unique high-head, low-flow hydraulic envelope
- Accepts NEMA 56C or IEC motors
- Available horizontal configuration (MSKC) or vertical (MSVKC)

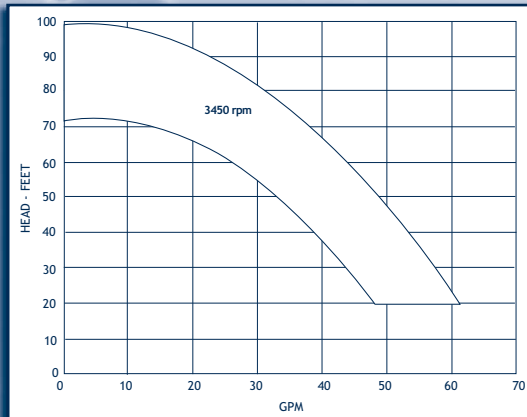

FTI MULTI-STAGE

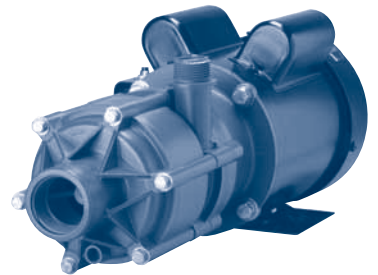

MSKC and MSVKC