

**JABSCO**  
(Flexible Impeller)

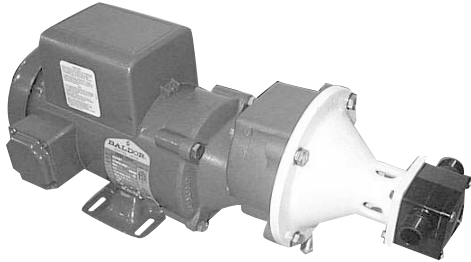

**Stainless, Sanitary & Epoxy**

**UP TO 100 GPM, UP TO 60 PSI,  
FLEXIBLE IMPELLER METERING**

Jabsco's self-priming flexible impeller pump design can effectively handle thin, viscous, shear sensitive, abrasive, particle-laden and air entrained fluids with ease. They are available in pedestal and C-Face mounting allowing an infinite number of variable speed drive systems to meet harsh or explosive environments, unique voltages and even hydraulic or pneumatic drive installations. Pumps come in 316SS, epoxy and 3A rated sanitary construction with the choice of Neoprene, EPDM, Buna or Viton impellers. Hardened seals are also available. See pages 22-23 and pages 98-99 for specific pump series specifications

Series Number	Minimum Flow	Maximum Flow	Maximum Pressure
30510/30550	1.0 gpm	10 gpm	60 psi
30520/30560	2.0 gpm	20 gpm	60 psi
30530/30570	5.0 gpm	50 gpm	60 psi
30540/30580	10.0 gpm	100 gpm	60 psi

**JABSCO**  
(Rotary Lobe)

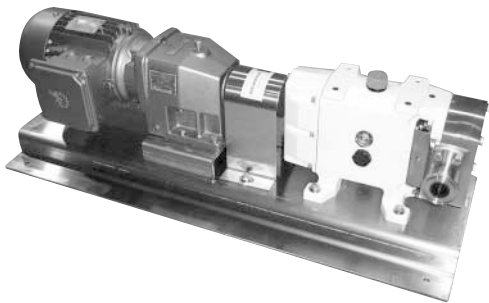

**Stainless & Sanitary**

**UP TO 554 GPM, UP TO 300 PSI,  
ROTARY LOBE METERING**

Jabsco's rotary lobe pump design can effectively handle thin, viscous, shear sensitive, abrasive and particle-laden liquids. They are used extensively in the food, pharmaceutical, cosmetic and chemical process industries. Elastomer options include Nitrile, Viton, EPDM, PTFE and Kalrez. An infinite number of variable speed drive systems are available to meet harsh or explosive environments, unique voltages and even hydraulic or pneumatic drive requirements. See pages 95-97 for specific pump series specifications.

Series Number	Min. Flow	Max. Flow	Max. Pressure	Design Specifications
55 Series	.42 gpm	17.7 gpm	300 psi	3A and Ultra-Hygienic
Hy-Line	3.2 gpm	180 gpm	215 psi	3A and Gen. Industrial
Ultima	3.2 gpm	180 gpm	215 psi	3A and Ultra-Hygienic
24 Series	1.0 gpm	554 gpm	217 psi	3A and Gen. Industrial

**ROBBINS & MYERS/MOYNO**  
(Progressive Cavity)

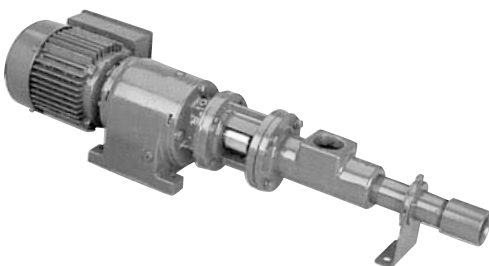

**Stainless & Cast Iron**

**UP TO 190 GPH, UP TO 300 PSI,  
PROGRESSIVE CAVITY METERING**

The Robbins and Myers progressive cavity metering pumps feature highly accurate, repeatable flow rates for pinpoint flow control. They are designed to handle a wide range of fluids from clean, clear liquids to abrasive, corrosive fluids, solids in suspension and viscous materials. They are used extensively in process applications including chemical dosing, sampling and polymer metering. Pumps are available in 316SS or cast iron housings, Nitrile, natural rubber, EPDM or Fluoroelastomer stators and with packing or mechanical seals. A wide variety of drives are available to meet your specific requirements.

Series Number	Minimum Flow	Maximum Flow	Maximum Pressure
4015 Series	1.5 gph	15 gph	300 psi
4100 Series	10 gph	100 gph	300 psi
4190 Series	19 gph	190 gph	150 psi