

# OIL CHANGE AND DIESEL TRANSFER VANE

CONTENTS

INDEX

NEXT

BACK

HOME

## JABSCO

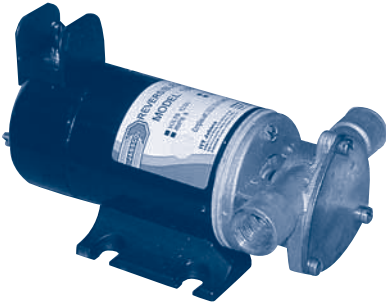

Reversible

## REVERSIBLE OIL CHANGE / DIESEL TRANSFER PUMPS

This Jabsco pump utilizes the proven vane pump design, which is ideally suited for oil and diesel transfer. It comes equipped with a three-way reversible switch that allows the removal of the old oil and the filling of the new. Each pump has 1/2" FPT internal ports with 1" external hose barbs. The service kit includes the vanes, rotor, o-ring, and seal and can be ordered under the number JA 90200-0000. **Not for pumping gasoline!**

Model Number	Volts DC	Max GPM	Amp Draw	Dimensions (H x W x L)
JA 18680-1000	12	5	8	3 1/4" x 4 3/4" x 8"

## JABSCO

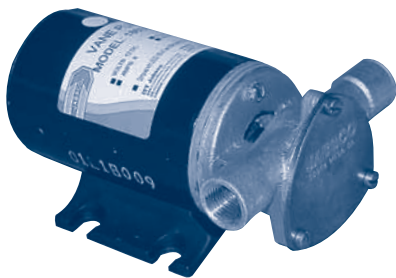

12 and 24 vdc

## OIL CHANGE / DIESEL TRANSFER PUMPS

These Jabsco pumps are ideal for oil change or diesel transfer where a reversing switch is not required. Each pump has 1/2" FPT internal ports with 1" external hose barbs. The service kit includes the vanes, rotor, o-ring, and seal and can be ordered under the number JA 90200-0000. **Not for pumping gasoline!**

Model Number	Volts DC	Max GPM	Amp Draw	Dimensions (H x W x L)
JA 18680-0920	12	5.5	8	3 3/8" x 4 3/4" x 7"
JA 18680-0940	24	5.5	5	3 3/8" x 4 3/4" x 7"

## JABSCO

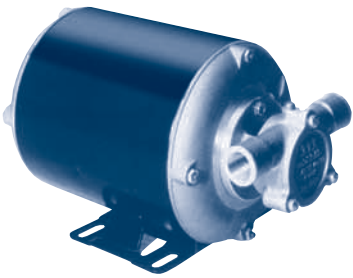

115 vac

## 115 VAC DIESEL TRANSFER PUMP

The Jabsco 115 vac 45740-0000 pump will empty a 55 gallon drum of diesel in 7 minutes! It comes with a 6-foot power cord and has 1/2" FPT internal ports with 1" external hose barbs. The service kit includes the vanes, rotor, o-ring, and seal and can be ordered under the number JA 90200-0000. **Not for pumping gasoline!**

Model Number	Volts DC	Max GPM	Amp Draw	Dimensions (H x W x L)
JA 18685-0000	115	7.8	3	6" x 4 3/4" x 9 1/2"

## JABSCO

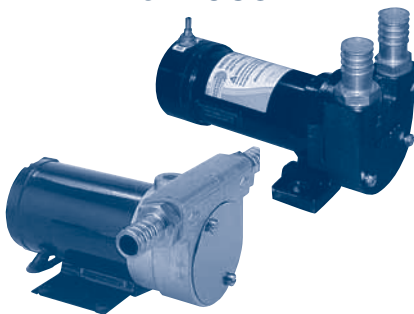

High Volume 12 and 24 vdc

## HIGH VOLUME DC DIESEL TRANSFER PUMPS

These Jabsco high volume pumps are available in 12 and 24 vdc and 9, 12, and 25 gallons per minute flows. The 50130 series has the added feature of an internal by-pass. This allows the fuel to be by-passed within the pump while the discharge line is restricted or shut-off during operation. This feature enables the user to start and stop the flow with a nozzle at the end of the hose, eliminating the need of controlling the flow with the power switch. **Not for pumping gasoline!**

Model Number	Volts DC	Max GPM	Amp Draw	Port Size	Dimensions (H x W x L)
JA 50130-1000	12	9	13	3/4" Barb	4" x 7" x 6 3/8"
JA 50130-1100	24	9	6	3/4" Barb	4" x 7" x 6 3/8"
JA 23540-1200	12	12	15	1" FPT	5 3/4" x 5" x 8 1/2"
JA 23540-1300	24	12	7	1" FPT	5 3/4" x 5" x 8 1/2"
JA 23550-1300	24	25	15	1 1/4" FPT	7 1/8" x 5 11/16" x 9 3/4"