

**JABSCO**



**115 VAC, Non-Metallic**

**115 VAC, UP TO 5.8 GPM, 13 PSI, IN PHENOLIC PLASTIC (LOW COST ELECTRIC CHEMICAL PUMP)**

This phenolic plastic pump is a cost effective chemical resistant transfer, sump, and recirculation pump. It comes standard with a stainless steel shaft, choice of Viton or Buna lip seal, and a choice of Neoprene, Nitrile, or Viton impeller. The 115 vac motor comes in open dripproof or totally enclosed.

12290 Series (5/8" Slip-on)		
TOTAL HEAD		FLOW
PSI	FT.	GPM
4.3	10	5.8
8.7	20	5.0
13.0	30	3.8

**JABSCO**



**Compact AC & DC Non-Metallic**

**AC & DC, 1 TO 4.6 GPM, 21 PSI, IN PHENOLIC PLASTIC**

These versatile phenolic plastic utility pumps will instantly prime for transfer, sump, or recirculation applications. All models come with a stainless steel shaft, lip seal, and the choice of Neoprene or Nitrile impeller.

MODEL NUMBER	MAX GPM	PORT SIZE	VOLTAGE	OVERALL DIMENSIONS (H x W x L)
12460 Series	1.7	3/8" FPT, 3/4" GHT	12 or 24 vdc	3 3/8" x 5" x 6 3/8"
12310 Series	4.0	3/8" FPT, 3/4" GHT	115 vac	3 7/16" x 5" x 7"
12560 Series	4.6	5/8" Slip-on hose	12 or 24 vdc	3 3/8" x 5" x 6"

**12460 Series (3/8" FPT, 3/4" GHT)**

TOTAL HEAD		FLOW
PSI	FT.	GPM
4.3	10	1.7
8.7	20	1.4
13.0	30	1.0

**12310 Series (3/8" FPT, 3/4" GHT)**

TOTAL HEAD		FLOW
PSI	FT.	GPM
4.3	10	4.0
8.7	20	3.6
13.0	30	3.2
17.3	40	2.7
21.6	50	2.1

**12560 Series (5/8" Slip-on)**

TOTAL HEAD		FLOW
PSI	FT.	GPM
2.1	5	4.6
4.3	10	3.7
8.7	20	1.7

**JABSCO**

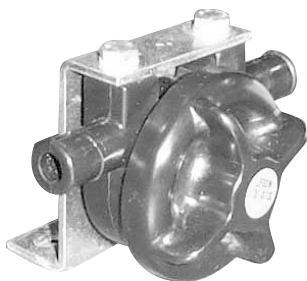

**Econo Chemical Pump**

**PEDESTAL, UP TO 5.8 GPM, 13 PSI, IN PHENOLIC PLASTIC (LOW COST SHAFT DRIVEN CHEMICAL PUMP)**

This phenolic plastic pump is a cost effective chemical resistant transfer, sump, and recirculation pump. It comes with a Viton lip seal and has the choice of 316 stainless steel or Hastelloy B shaft. Impeller options include Neoprene, Nitrile, or Viton. We offer custom mounting to your choice of drive including variable speed in AC or DC voltage.

3010 Series (5/8" slip-on)							
TOTAL HEAD		500 RPM		1160 RPM		1750 RPM	
PSI	FT.	GPM	HP	GPM	HP	GPM	HP
4.3	10	1.3	1/6	3.5	1/6	5.8	1/4
8.7	20	.5	1/6	2.5	1/5	5.0	1/4
13.0	30	0.8	-	1.4	1/4	3.8	1/4

\* Performance charts show approximate flow in U.S. Gallons Per Minute for a new pump with a Neoprene impeller. For Nitrile or Viton impeller, reduce flow by 10%. Consult individual data sheets for use at a higher RPM. For Metric conversion of performance and dimensions, refer to Engineering Data. Use only capacitor-start motors with flexible impeller pumps.