

# BRONZE AND DUCTILE IRON GEAR PUMPS

- CONTENTS
- ENGINE COOLING
- INDEX
- HOME
- NEXT
- BACK

## OBERDORFER

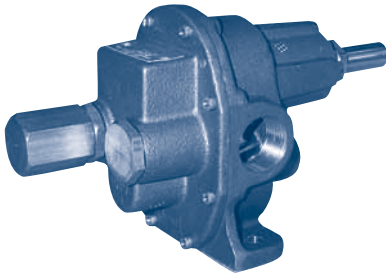

N1000 - N9000

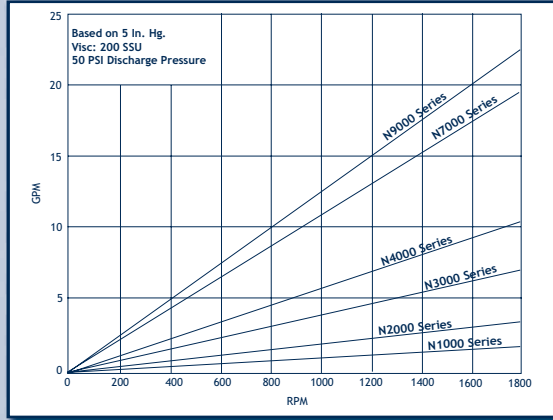

### UP TO 23 GPM, 100 PSI (150 psi Intermittent)

- Bronze housings and gears
- Packing standard, lip seal or mechanical seal options
- Available with or without relief valve
- Foot mounted for direct or pulley drive
- Drive Options: Electric motor, gas or diesel engine, hydraulic or air motor

## OBERDORFER

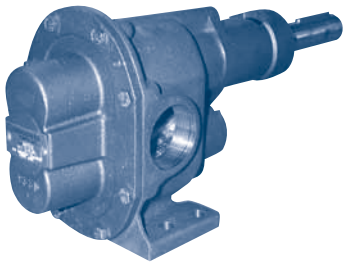

N11HDM - N26HDM

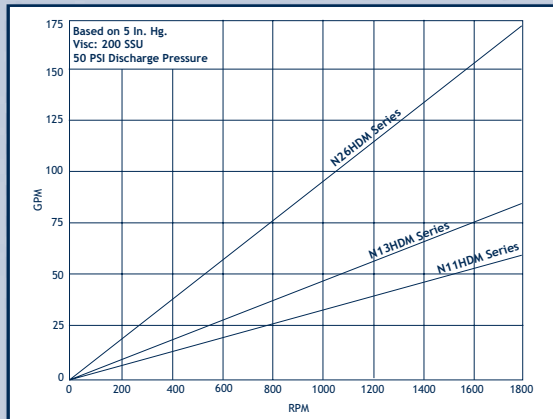

### UP TO 174 GPM, 100 PSI (150 psi below 900 rpm)

- Bronze housings and gears
- Mechanical seal, lip seal or packing options
- Carbon bearings with outboard ball bearing on drive shaft
- Drive Options: Electric motor, gas or diesel engine, hydraulic or air motor

## OBERDORFER

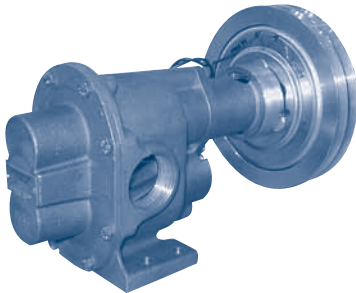

Clutch Drive

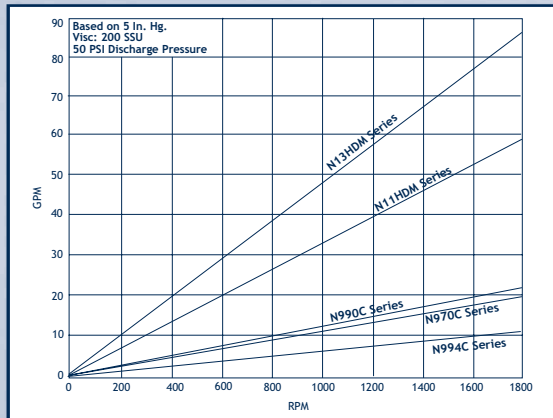

### UP TO 85 GPM, 150 PSI

- Bronze housings and gears
- Lip seal or mechanical seal
- Relief valve option on smaller sizes
- External ball bearing construction
- Carbon bearings
- 12, 24 or 32 vdc clutch
- 7" double groove clutch pulley
- Can be pulley driven by electric motor, gas or diesel engine, hydraulic or air motor

## OBERDORFER

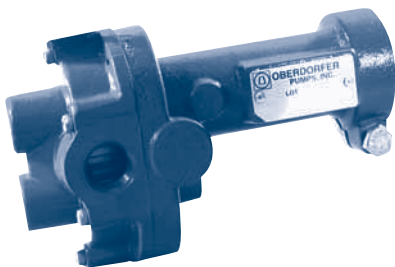

Ductile Iron

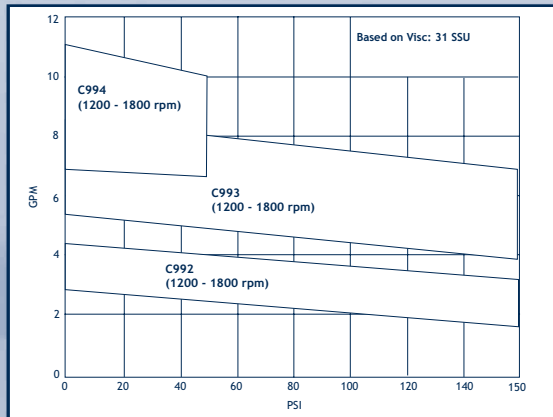

### UP TO 10.5 GPM, 150 PSI

- Ductile iron housings
- Stainless steel shafts
- Steel gears
- Buna mechanical seals, Viton® option
- Carbon bearings
- Adapter kits available for 48, 56, 56C, 143/145TC frame electric motors