

- CONTENTS
- ENGINE COOLING
- INDEX
- HOME
- NEXT
- BACK

## OBERDORFER

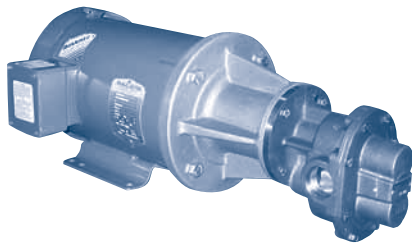

Bronze Gear Pumps

## ELECTRIC DRIVEN GEAR PUMP, UP TO 61 GPM, 100 PSI

The bronze Oberdorfer 1100 series meets USCG specifications as an auxiliary fire pump for most vessels. Options include single or three phase voltage, 50 or 60hz, IEEE-45 enclosure, and custom configurations that meet MCA, Lloyds, ABS, and USCG specifications. Below are some examples of the choices available. Call us for information on the configuration to meet your requirements.

Model Number 60 Hz, 1 1/4" Ports	HP	Voltage	Phase	GPM at PSI				Max PSI
				20	40	60	100	
N1100Y-10X18BCT	5	230 vac	1	58	56	55	—	60
N1100Y-30X18BCT	5	230/460 vac	3	58	56	55	—	60
N1100Z-10V18BCT	10	230 vac	1	58	56	55	50	100
N1100Z-30V18BCT	10	230/460 vac	3	58	56	55	50	100

## OBERDORFER

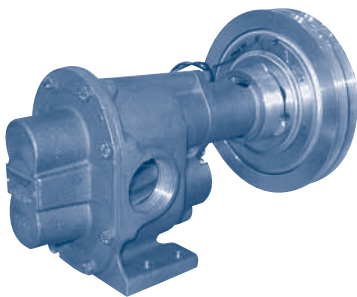

Clutch Driven

## CLUTCH DRIVEN GEAR PUMP, UP TO 85 GPM, 100 PSI

Oberdorfer's clutch driven bronze gear pumps meet United States Coast Guard specifications as an auxiliary fire pump for most vessels. They utilize a 7" diameter double groove clutch for 1/2" "A" belts and comes with 1 1/2" FPT ports.

12 vdc Model Number	24 vdc Model Number	32 vdc Model Number	Port Size	1800 RPM/GPM at PSI				Max PSI
				20	40	60	100	
OB N11HDM-2	OB N11HDM-5	OB N11HDM-32V	1 1/4"	58	56	55	50	100
OB N13HDM-4	OB N13HDM-7	OB N13HDM-6	1 1/2"	85	83	82	80	100

## AMPCO

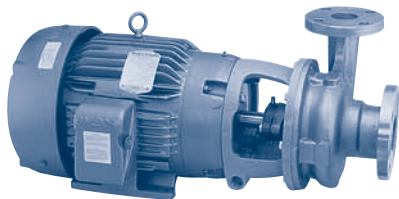

Navel Bronze Centrifugal

## NAVAL BRONZE CENTRIFUGAL, UP TO 1600 GPM, 162 PSI

Ampco manufactures a high quality navel bronze (nickel aluminum bronze) centrifugal that has superior saltwater corrosion/erosion resistance to standard bronze or stainless steel allow. All models require a flooded suction, come with flanged ports and are available in a variety of voltages and motor enclosures. Call for pump selection assistance.

Model Series	Inlet Flange	Outlet Flange	Max GPM	Max PSI
ZC2/ZCH2 1 1/2" X 1 1/2"	1 1/2"	1 1/2"	80	142
ZC2/ZCH2 2" X 2"	2"	2"	225	142
ZC2/ZCG2 3" X 2"	3"	2"	450	162
EC/EP 3" X 2 1/2"	3"	2 1/2"	400	85
EC/EP 4" X 3"	4"	3"	600	80
ZC2/ZCH2 4" X 3"	4"	3"	1400	150
ZCH2 6" X 6"	6"	6"	1600	40

## G & R by GIANNESCHI

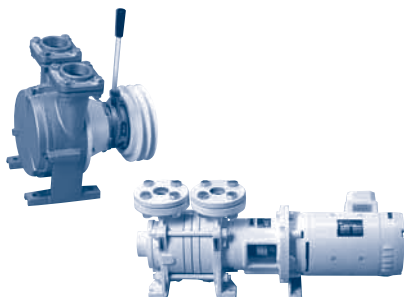

Bronze Liquid Ring

## ELECTRIC OR CLUTCH LIQUID RING, UP TO 308 GPM, 482 PSI

Gianneschi clutch driven pumps have large internal passages and single stage simplicity. This combined with their near instant priming ability make them great options for emergency firefighting, bilge, washdown and diesel transfer. Electric and shaft driven liquid ring pumps are also available in single and multistage configurations to give on demand fire protection, fuel transfer and washdown flow performance.

Engine Driven Series	Description	Flow Range	Max PSI
GIA ACM-BT-DC	Close-Coupled to 24vdc motor	5- 66 GPM	54
GIA ACM-BT-AC	Close-Coupled to 60hz AC motor	5- 185 GPM	233
GIA ACM-BT-PED	Shaft Driven Pedestal Mount	5- 308 GPM	482

Clutch Driven Series	Max RPM	Max Flow at Max RPM	Max PSI at Max RPM	Flow at Max PSI
GIA FS40/14 (F)	2500	158 GPM	67	63 GPM
GIA FS65 (F)	1500	132 GPM	71	21 GPM
GIA FC40/160 (F)	2000	79 GPM	42	26 GPM