

# ENGINE COOLING PUMPS

- CONTENTS
- ENGINE COOLING
- INDEX
- HOME
- NEXT
- BACK

## OBERDORFER Osco



### 301M-1 / 301M-2

Osco

Part No.	Description	Qty
6620	Impeller	1
6736	Cover	1
7574	Shaft (301M-1)	1
7600	Shaft (301M-2)	1
6612	Cam	1
5928	Ball Bearing	2
5504	Cover Screws	4
5926	Snap Ring (SM)	2
5925	Snap Ring (LG)	1
6739	Key (Impeller)	1
6609	Bearing Seal	1
6631	Seal Washer	1
6643	Cam Screw	1
6685	Pin (Cam)	1
8231	O-Ring	1
6737	Wearplate	1
32230	Mechanical Seal	1

## SHERWOOD Palmer

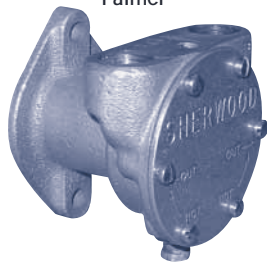

### E-20

Palmer

Part No.	Description	Qty
10077	Impeller	1
10286	Gasket	1
11628	Lip Seal	1
10195	Screw	1
10285	Impeller Cam	1
11747	Shaft	1
336	Plug	1
10593	Cover Plate	1
344	Screw	6
10093	Key	1
4306	Ball Bearing	2
4304	Snap Ring (Small)	1
4303	Snap Ring (Large)	1
10859	Bearing Seal	1
10148	Washer	1

## JOHNSON Pathfinder 6.2 Diesel



### 10-24225

Pathfinder

Part No.	Description	Qty
1027B	Impeller	1
05-29-515	Lip Seal	1
01-45680	Lip Seal Washer	1
01-45315	Gasket	1
01-45312-1	End Cover	1
05-04-550	Cover Screw	4
01-45329	Full Cam	1
05-04-174	Full Cam Screw	1
01-45656	1/2 Cam	1
05-04-175	1/2 Cam Screw	1
05-06-501	O-Ring	1
05-08-128	Ball Bearing	2
09-45805	Shaft/Hub	1

## JOHNSON Pathfinder 4 and 5 Cylinder

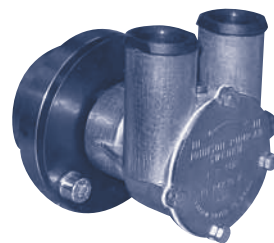

### 10-24230-2

Pathfinder, Volkswagon Block

Part No.	Description	Qty
1027B	Impeller	1
01-45315	Gasket	1
05-29-515	Lip Seal	1
01-45329	Full Cam	1
05-04-174	Full Cam Screw	1
01-45656	1/2 Cam	1
05-04-175	1/2 Cam Screw	1
01-45680	Washer	1
05-06-501	O-Ring	1
05-08-128	Ball Bearing	2
05-04-550	Cover Screw	4
01-45312-1	End Cover	1
09-45806	Shaft / Hub	1

## JOHNSON Peninsular 8.2 Liters

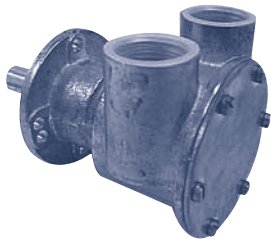

### 10-24349-1

Peninsular

Part No.	Description	Qty
1028B	Impeller	1
05-29-105	Lip Seal	2
01-45181	Seal Spacer	1
01-42445	Gasket	1
01-42441	End Cover	1
05-04-174	Cover Screw	6
01-42679	Cam	1
05-04-107	Cam Screw	1
05-06-501	Slinger O-Ring	1
05-08-128	Ball Bearing	2
01-46092	Shaft	1

## SHERWOOD US Marine - 0351 Ford



### P151

US Marine

Part No.	Description	Qty
15000K	Impeller	1
10515	Cam Screw	1
12710	Lock Washer	3
17485	Cap Screw	3
18509	Cover	1
4432	Key	1
12231	O-Ring	1
18652	Lip Seal	1
14990	Slinger	1
18662	Ball Bearing	2
6837	Snap Ring (SM)	1
8781	Snap Ring (LG)	1
18398	Cam	1
18671	Shaft	1

## JOHNSON Vetus M3.10

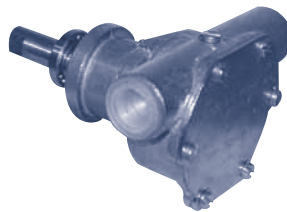

### 10-35240-1

Vetus den Ouden

Part No.	Description	Qty
810B	Impeller	1
01-45284	Gasket	1
01-45282	End Cover	1
05-04-642	Cover Screw	6
01-42389	Cam	1
05-04-114	Cam Screw	1
05-04-124	Screw	1
05-29-139	Lip Seal	2
01-45955	Seal Spacer	1
05-08-130	Ball Bearing	2
05-08-508	Ball Bearing (Outer)	1
05-34-131	Snap Ring	1
05-01-120	Washer	1
01-45569	Shaft	1
01-43238	Mounting Clip	2

## SHERWOOD 4.3 V6 / Chevy 305 and 350



### R991

Yamaha # 10100000

Part No.	Description	Qty
9959K	Impeller	1
18464	Shaft	1
4258	Ext. Ret. Ring	3
4259	Int. Ret. Ring	1
4257	Ball Bearing	1
18427	Housing	1
12231	O-Ring	1
18428	Cover	1
12710	Lock Washer	3
18266	Capcrew 1/4 x 20 x 3/4	3
06333	Bushing	1
15883	Cam	1
10515C	Cam Screw	1
10927	Seal & Seat Assy	1

#### Yamaha Impeller Cross Reference

Yamaha Part No.	Depco Part No.
YSC-101-03-01	SH 9959K
GTA-12457-00	JS 812B