

# GRAY, FLAGSHIP AND GLASTRON PUMPS

CONTENTS

ENGINE COOLING

INDEX

HOME

NEXT

BACK

## SHERWOOD Gray Marine

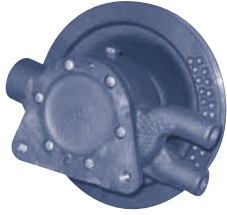

**N-10460(CCW) / N-10470(CW)**  
Gray # G80301 / Gray # G80300  
Compact V-8  
215, 225

| Part No. | Description    | Qty |
|----------|----------------|-----|
| 9959K    | Impeller       | 1   |
| 10512    | Gasket         | 2   |
| 10514C   | Water Seal     | 1   |
| 10513    | Bearing Seal   | 1   |
| 4257     | Ball Bearing   | 2   |
| 4432     | Key            | 1   |
| 258      | Snap Ring (SM) | 1   |
| 4259     | Snap Ring (LG) | 1   |
| 8296     | Cover Screw    | 6   |
| 10506    | Shaft          | 1   |
| 10508    | Cover          | 1   |
| 10072    | Cam            | 1   |
| 10515    | Cam Screw      | 1   |
| 336      | Plug           | 1   |

## JABSCO Gray Marine



**8830-0701 / 8830-0711**

Compact V-8  
VHC-215, VHC-225

| Part No.   | Description  | Qty |
|------------|--------------|-----|
| 8980-0005  | Impeller     | 1   |
| 92700-0060 | Seal         | 1   |
| 92000-0210 | Seal O-Ring  | 1   |
| 8641-0000  | Gasket       | 1   |
| 8493-0000  | Wearplate    | 1   |
| 3286-0000  | Slinger      | 1   |
| 11839-0000 | End Cover    | 1   |
| 91026-0010 | Cover Screw  | 6   |
| 8528-0000  | Cam          | 1   |
| 91030-0110 | Cam Screw    | 1   |
| 93000-0070 | Bearing Seal | 1   |
| 92600-0070 | Bearing      | 1   |
| 18714-0000 | Snap Ring    | 1   |
| 91401-0030 | Key          | 1   |
| 8527       | Shaft        | 1   |
| 5668-0010  | Pulley       | 1   |

## SHERWOOD Gray Marine



**Q10840**

Gov. Engine  
Gray # G80561

| Part No. | Description    | Qty |
|----------|----------------|-----|
| 10077K   | Impeller       | 1   |
| 10286    | Gasket         | 1   |
| 11628    | Water Seal     | 1   |
| 10859    | Bearing Seal   | 1   |
| 4306     | Ball Bearing   | 2   |
| 10858    | Shaft          | 1   |
| 10285    | Cam            | 1   |
| 10195    | Cam Screw      | 1   |
| 10593    | End Cover      | 1   |
| 344      | Cover Screw    | 6   |
| 10093    | Key            | 1   |
| 4303     | Snap Ring (LG) | 1   |
| 4304     | Snap Ring (SM) | 1   |

## REPLACEMENT IMPELLERS Gray Marine



Gray Impeller Cross-Reference

| Gray Part No. | Depco Part #  |
|---------------|---------------|
| 74306         | JA 1210-0001  |
| 74316         | JA 4528-0001  |
| 74326         | JA 18673-0001 |
| 74340         | JA 920-0008   |
| 74366         | JA 4568-0001  |
| 74380         | JA 5616-0001  |

Impeller Puller.....page 161

## JABSCO

Owens - Flagship V-8



**12280-0001**

Flagship

| Part No.   | Description    | Qty |
|------------|----------------|-----|
| 920-0001   | Impeller       | 1   |
| 91003-0010 | Screw          | 6   |
| 12294-0000 | End Cover      | 1   |
| 12288-0000 | Gasket         | 1   |
| 12287-0000 | Shaft          | 1   |
| 12284-0000 | Body           | 1   |
| 96080-0080 | Seal           | 1   |
| 913-0000   | Bearing Seal   | 1   |
| 92600-0060 | Bearing        | 1   |
| 18724-0000 | Retaining Ring | 1   |
| 9103-0000  | Gear           | 1   |
| 93100-0040 | Roll Pin       | 1   |

## JABSCO

Owens - Flagship V-8



**14210-0001**

Flagship

| Part No.   | Description    | Qty |
|------------|----------------|-----|
| 1210-0001  | Impeller       | 2   |
| 91002-0020 | Screw          | 6   |
| 11830-0000 | End Cover      | 1   |
| 3298-0000  | Gasket         | 1   |
| 7038-0000  | Wearplate      | 2   |
| 96080-0080 | Seal           | 1   |
| 14217-0000 | Shaft          | 1   |
| 913-0000   | Bearing Seal   | 1   |
| 92600-0060 | Bearing        | 1   |
| 9103-0000  | Gear           | 1   |
| 93100-0040 | Roll Pin       | 1   |
| 18724-0000 | Retaining Ring | 1   |
| 6148-0040  | Cam            | 2   |
| 91003-0070 | Screw (Cam)    | 2   |

## JABSCO

Ford 302 / 351 C.I.

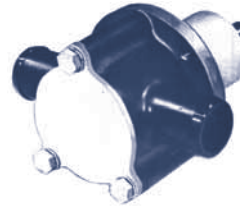

**17410 Series**

Glastron 190 / 255

| Part No.   | Description                | Qty |
|------------|----------------------------|-----|
| 3085-0001  | Impeller                   | 1   |
| 9215-0000  | Key (Shaft)                | 1   |
| 18753-0131 | Retaining Ring             | 1   |
| 17103-2000 | Bearing Housing            | 1   |
| 17388-0010 | Shaft & Bearing Assy       | 1   |
| 96080-0080 | Seal                       | 1   |
| 17404-0000 | Body                       | 1   |
| 17232-0000 | End Cover                  | 1   |
| 91602-0130 | Lock Washer                | 3   |
| 91095-0540 | Bolt (Hex Head)            | 3   |
| 17847-0000 | Wearplate (Stainless) .N/A | 1   |
| 17408-0000 | Gasket                     | 1   |
|            | (End Cover & Body)         | 2   |
| 17848-0000 | Gasket (Wearplate)         | 1   |
| 18730-0000 | O-Ring                     | 1   |

## SHERWOOD

Ford 121 / 182 / 302 C.I.



**G-95-1**

Glastron

(Also Chris-Craft #16.80-18348)

| Part No. | Description     | Qty |
|----------|-----------------|-----|
| 9959K    | Impeller        | 1   |
| 12859    | Mechanical Seal | 1   |
| 4264     | Seal Spacer     | 1   |
| 12231    | Cover O-Ring    | 1   |
| 12855    | Gasket          | 1   |
| 12856    | Wearplate       | 1   |
| 15883    | Cam             | 1   |
| 10515    | Cam Screw       | 1   |
| 4432     | Key             | 1   |
| 12211    | Ball Bearing    | 2   |
| 5133     | Bearing Spacer  | 1   |
| 4258     | Snap Ring (SM)  | 3   |
| 4259     | Snap Ring (LG)  | 2   |
| 12857    | Cover Bolts     | 3   |
| 12710    | Lock Washers    | 3   |
| 12664    | Shaft           | 1   |
| 11543    | Pin             | 1   |