

CONTENTS

PUMPING PRINCIPLES

ENGINE COOLING

ENGINEERING TABLES

TROUBLE-SHOOTING GUIDE

INDEX

HOME

NEXT

BACK

## SHERWOOD Pleasurecraft 302 / 351 Ford

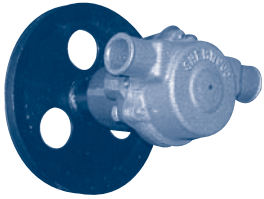

**G-21 (Old # G-20)**

Pleasurecraft # RA057007

Part #	Description	Qty
9959K	Impeller	1
12859	Mechanical Seal	1
4264	Seal Spacer	1
12231	Cover O-Ring	1
12855	Gasket	1
12856	Wearplate	1
15883	Cam	1
10515C	Cam Screw	1
4432	Key	1
12211	Ball Bearing	2
5133	Bearing Spacer	1
4258	Snap Ring (SM)	3
4259	Snap Ring (LG)	2
12857	Cover Bolts	3
12710	Lock Washers	3
12367	Shaft (G-20)	1
13363	Shaft (G-21)	1
12327	Pulley (G-20)	1
19729	Pulley (G-21)	1
12305	Snap Ring (G-20)	1
12368	Pulley Spacer (G-20)	1
11541	Pulley Pin (G-20)	1

## SHERWOOD Mitsubishi 4 Cylinder



**G-22 (1" Ports)**

Pleasurecraft # RA057013

Part #	Description	Qty
9959K	Impeller	1
12231	O-Ring	1
12855	Gasket	1
12859	Mechanical Seal	1
4264	Washer (Seal)	1
15883	Cam	1
10515C	Cam Screw	1
19729	Pulley	1
13363	Shaft	1
4259	Snap Ring (LG)	2
4258	Snap Ring (SM)	3
5133	Bearing Spacer	1
12211	Ball Bearing	2
12857	Screw	3
12710	Lock Washers	3
12856	Wearplate	1
4432	Key	1

## SHERWOOD 7.3 Diesel

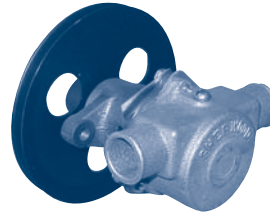

**G-26 (1 1/4" Ports)**

Pleasurecraft # RA057014

Part #	Description	Qty
10615K	Impeller	1
12231	O-Ring	1
12855	Gasket	1
12859	Mechanical Seal	1
4264	Washer (Seal)	1
10944	Cam	1
10515C	Cam Screw	1
19729	Pulley	1
13363	Shaft	1
4259	Snap Ring (LG)	2
4258	Snap Ring (SM)	3
5133	Spacer	1
12211	Ball Bearing	2
12857	Screw	3
12710	Lock Washers	3
12856	Wearplate	1
4432	Key	1

## SHERWOOD Pleasurecraft 454 Chevy

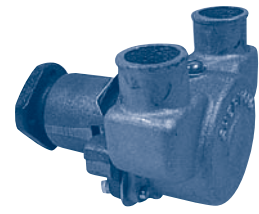

**G-55-2**

Pleasurecraft # RA057009

Part #	Description	Qty
10615K	Impeller	1
12859	Mechanical Seal	1
4264	Seal Spacer	1
12231	Cover O-Ring	1
12855	Gasket	1
12856	Wearplate	1
10944	Cam	1
10515C	Cam Screw	1
4432	Key	1
12211	Ball Bearing	2
5133	Bearing Spacer	1
4258	Snap Ring (SM)	3
4259	Snap Ring (LG)	2
12857	Cover Bolts	3
12710	Lock Washers	3
12596	Shaft	1
9420	Pin	1

## SHERWOOD 5.7L V8 GM

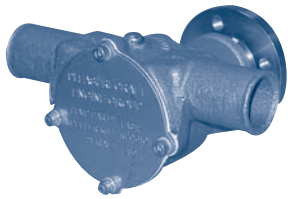

**P1012**

Pleasurecraft

Part #	Description	Qty
10615K	Impeller	1
12859	Mechanical Seal	1
4264	Seal Washer	1
19251	Gasket	1
13293	Cover Screw	4
1343	Lock Washers	4
10944	Cam	1
10515C	Cam Screw	1
19295	Wearplate	1
12211	Ball Bearing	2
19293	Shaft	1
4432	Key	1
4258	Snap Ring (SM)	2
4259	Snap Ring (LG)	2
97176	Pulley Hub	1

## SHERWOOD 8.1L V8 GM



**P109**

Pleasurecraft

Part #	Description	Qty
10615K	Impeller	1
12231	O-Ring	1
18652	Seal	1
8490	Bearing	2
19308	Shaft	1
6837	Retaining Ring	1
5216	Retaining Ring	1
4432	Key	1
10944	Cam	1
23912	Cover	1
2220-0099	Screw	4
343	Washer	4
19995	Screw	1
19996	Washer	1

## SHERWOOD Pleasurecraft GM 5.7 / Marine Power / Indmar

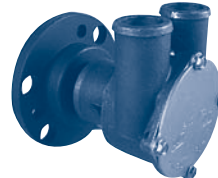

**P105**

Pleasurecraft # RA057026 /  
Marine Power / Indmar

Part #	Description	Qty
10615K	Impeller	1
19275	Adaptor	1
19308	Shaft	1
5126	Int. Ret. Ring	1
8490	Ball Bearing	2
18652	Lip Seal	1
10944	Cam	1
10515C	Cam Screw	1
19251	Gasket	1
6837	Ext. Ret. Ring	1
18972	Body	1
344	Screw	4
21120	Cover	1
4432	Key	1
343	Lock Washers	4

### Impeller Cross-Reference

Pleasurecraft Part #	Depco Part #
R061015	SH 9959K
R061017	SH 10615K

## SHERWOOD Marine Power



**G-157**

Marine Power

Part #	Description	Qty
15000k	Impeller	1
12859	Mechanical Seal	1
4264	Seal Spacer	1
12231	Cover O-Ring	1
12855	Gasket	1
12856	Wearplate	1
18314	Cam	1
10515C	Cam Screw	1
4432	Key	1
12211	Ball Bearing	2
5133	Bearing Spacer	1
4258	Snap Ring (SM)	3
4259	Snap Ring (LG)	2
12857	Cover Bolts	3
12710	Lock Washers	3
21231	Shaft	1