

CONTENTS

PUMPING PRINCIPLES

ENGINE COOLING

ENGINEERING TABLES

TROUBLE-SHOOTING GUIDE

INDEX

HOME

NEXT

BACK

SHERWOOD 4107 / 4108 Engines



G-65

Perkins # NA003335

Part #.....	Description.....	Qty
9959K.....	Impeller.....	1
12444.....	Shaft.....	1
12211.....	Bearing.....	2
10514C.....	Seal.....	1
10515C.....	Cam Screw.....	1
11360A.....	Gasket.....	1
10072.....	Cam.....	1
11389A.....	Cover.....	1
4432.....	Key.....	4
11417A.....	Screw.....	4
WB 11143.....	Mtg. Gasket.....	1

4 3/8" Diameter Mtg. Flange

JABSCO 4107 / 4108 Engines

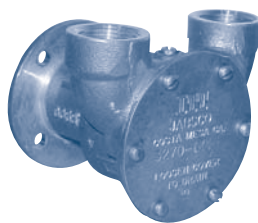

3270-0001 (3270-200)

Perkins # 35615

Part #.....	Description.....	Qty
1210-0001.....	Impeller.....	1
91002-0020.....	Screw.....	6
11830-0000.....	End Cover.....	1
3298-0000.....	Gasket.....	1
92700-0060.....	Bearing Seal.....	1
92600-0070.....	Bearing.....	1
3276-0000.....	Adaptor Ring.....	1
3277-0000.....	Shaft.....	1
3278-0000.....	Coupling.....	1
3286-0000.....	Slinger.....	1
92700-0060.....	Seal.....	1
92000-0210.....	O-Ring.....	1
7884-0000.....	Cam & Wearplate.....	1
7883-0000.....	Wearplate.....	1
91003-0010.....	Cam Screw.....	1
PKN 36821506.....	Mtg. Gasket.....	1

2 7/8" Diameter Mtg. Flange

SHERWOOD 4154 Engines

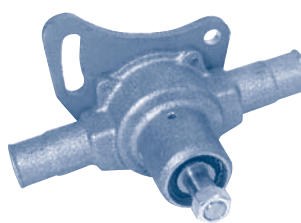

H-5

Perkins # NA005576

Part #.....	Description.....	Qty
9959K.....	Impeller.....	1
13272.....	Shaft.....	1
13270.....	Nut for Shaft.....	1
13271.....	Key for Pulley.....	1
6602.....	Ball Bearing.....	2
11816.....	Bearing Seal.....	1
10514C.....	Water Seal.....	1
10515C.....	Cam Screw.....	1
12231.....	O-Ring.....	1
11797.....	Cover Screws.....	4
15883.....	Cam.....	1
11795.....	Cover.....	1
4432.....	Impeller Key.....	1
12582.....	Snap Ring (SM).....	1
4259.....	Snap Ring (LG).....	1
13273.....	Washer.....	1
PKN 003419.....	Pulley.....	1

JABSCO 4154 Engines

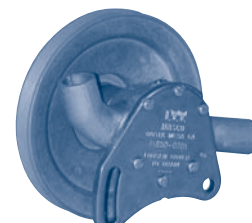

11850-0701 (11850-0711)

Part #.....	Description.....	Qty
1210-0001.....	Impeller.....	1
91026-0010.....	Cover Screw.....	6
12346-0000.....	End Cover.....	1
8641-0000.....	Gasket.....	1
91030-0100.....	Screw (Plug).....	1
91030-0110.....	Cam Screw.....	1
8528-0000.....	Cam.....	1
8493-0000.....	Wearplate.....	1
96080-0080.....	Seal.....	1
12019-0000.....	Washer.....	1
92600-0070.....	Ball Bearing.....	1
18714-0000.....	Ret. Ring.....	1
91401-0030.....	Key.....	1
11977-0000.....	Shaft.....	1
PKN 003419.....	Pulley.....	1
93000-0090.....	Bearing Seal.....	1

SHERWOOD 6354 Engines (Clamp Mount)

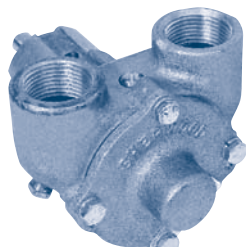

RP-B-C

Perkins # NA001175

Part #.....	Description.....	Qty
10615K.....	Impeller.....	1
10093.....	Shaft Key.....	1
4432.....	Impeller Key.....	1
4258.....	Snap Ring (SM).....	3
4259.....	Snap Ring (LG).....	1
4257.....	Ball Bearing.....	1
10927.....	Mechanical Seal.....	1
10515C.....	Cam Screw.....	1
10931.....	Gasket.....	1
12710.....	Lock Washer.....	4
1482.....	Cover Screw.....	4
10944.....	Cam.....	1
10183.....	Cover.....	1
11374A.....	Shaft.....	1
06333.....	Bushing.....	1
336.....	Drain Plug.....	2
1311.....	Pin.....	2

OBERDORFER 6354 Engines (Clamp Mount)

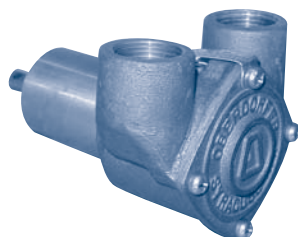

403M

Part #.....	Description.....	Qty
6603.....	Impeller.....	1
5504.....	Screw.....	4
6924.....	Cover.....	1
8230.....	O-Ring.....	1
6635.....	Wearplate.....	1
6606.....	Cam.....	1
7300-62.....	Screw.....	1
6685.....	Pin.....	1
6609.....	Seal Brg.....	2
5928.....	Ball Brg.....	2
5926.....	Ring (Shaft).....	2
5925.....	Ring (Brg.).....	1
32230.....	Seal Assy.....	1
6631.....	Washer Seal.....	1
6925.....	Shaft.....	1
5475.....	Key (Impeller).....	1

JABSCO 6354 (Clamp Mount)

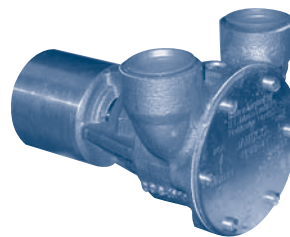

9990-21 / 9990-41

Perkins # 2488324

Jabsco #.....	Description.....	Qty
1210-0001.....	Impeller.....	1
18753-0049.....	Mechanical Seal.....	1
3298-0000.....	Gasket.....	1
11830-0000.....	End Cover.....	1
91002-0020.....	Cover Screws.....	6
490-0001.....	Cam.....	1
91003-0010.....	Cam Screw.....	1
7883-0000.....	Wearplate.....	1
92600-0130.....	Ball Bearing.....	2
92700-0060.....	Oil Seal.....	1
SP2701-15.....	Outer Brg Seal.....	1

JABSCO 6354 Engine (3 Bolt Mtg.)

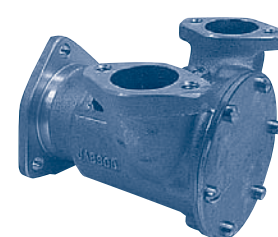

9700-01 / 9700-04

Perkins # 2488275(9700-01)

Part #.....	Description.....	Qty
920-0001.....	Impeller.....	1
22645-0000.....	Seal Assy.....	1
92600-0060.....	Bearing.....	1
934-0000.....	Cam (9700-01).....	1
91004-0090.....	Cam Screw (9700-01).....	1
3255-0000.....	1/2 Cam (9700-04).....	1
91004-0110.....	1/2 Cam Screw.....	1
91003-0010.....	Cover Screw.....	6
11831-0000.....	Cover.....	1
890-0000.....	Gasket.....	1
4156-0010.....	Wearplate.....	1
SH 4258.....	Snap Ring (Seal).....	1
913-0000.....	Bearing Seal.....	1
18724-0000.....	Snap Ring (LG).....	1
18713-0000.....	Snap Ring (SM).....	1
9707.....	Shaft.....	1
3180-0000.....	Slinger.....	1