

Close Coupled In-Line Pumps

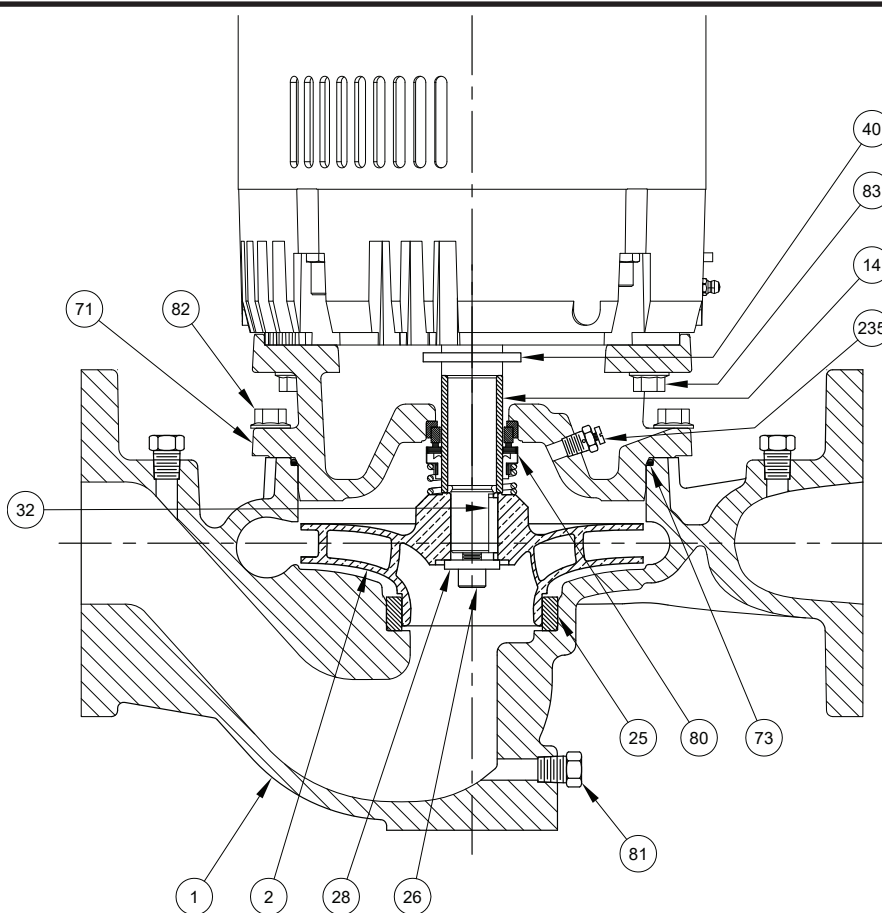

Parts List and Materials of Construction
Standard Casing Working Pressure - 175 PSI @ 100° F

Item No.	Part Name	Std. Bronze Fitted	Item No.	Part Name	Std. Bronze Fitted
1	Case	Cast Iron	71	Adapter, CI	Cast Iron
2	Impeller	Bronze	73	O-Ring, 6.984"ID, Buna	Buna
14	Sleeve	Bronze	80	Mechanical Seal	C/CE/B
25	Wear Ring (Optional)	316 Stainless Steel	81	Pipe Plug, .25", Brass	Brass
26	Impeller Screw, 302SS	302 Stainless Steel	82	Screw, SAE Grade 5	Steel
28	Impeller Washer, 302SS	302 Stainless Steel	83	Screw, SAE Grade 5	Steel
32	Key, 303SS	303 Stainless Steel	235	Vent Valve, .125", Steel	Steel
40	Deflector	Neoprene			

Mechanical Seal - John Crane Type 21, Material Code BF1C1

Explanation of Material Code

Elastomeric Parts	Rotating Face	Metal Parts	Stationary Seal	Spring
Buna	Carbon	Stainless Steel	Ceramic	Stainless Steel

Maximum Temperature 250°F



WARNING:
CANCER AND REPRODUCTIVE HARM -
WWW.P65WARNINGS.CA.GOV